



Randall Place, SE10

£735,000

An immaculately presented two bedroom Victorian cottage that has been finished to a phenomenal standard, Situated in a sought after location in the heart of Greenwich. The property further benefits from a new roof and new windows, a viewing is highly recommended.

Located in the heart of Greenwich for independent shops, bars and restaurants, Greenwich Mainline and DLR Station is a short walk away providing direct connections to Canary Wharf, Bank, London Bridge, Cannon Street and Kings Cross. While Greenwich Market is within easy reach.

Features

- Private Garden
- Immaculate Throughout
- Finished To A High Standard
- Period Features
- Sought After Location
- No Work Required

Randall Place,
London, SE10

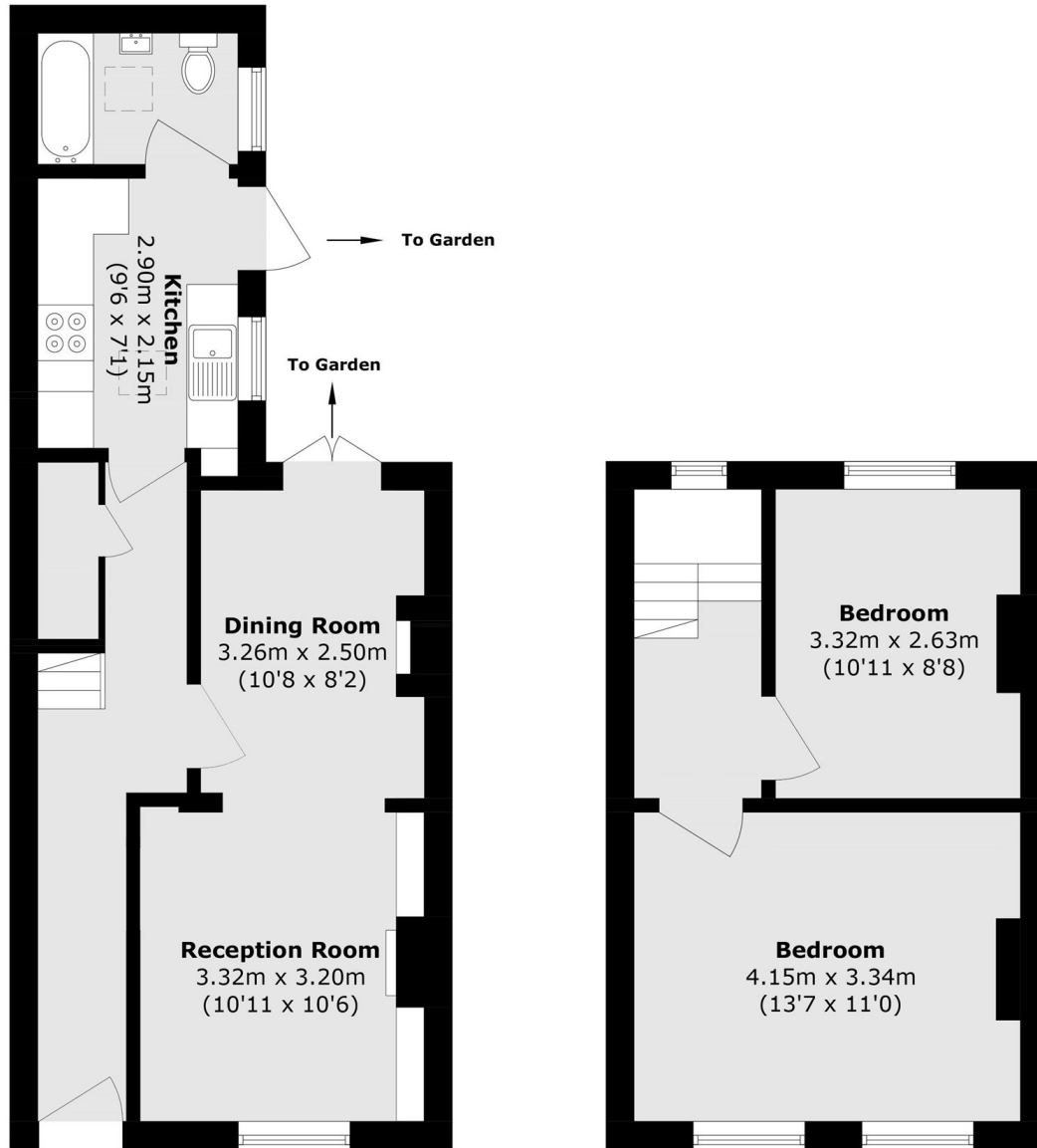

Ground Floor

First Floor

Total area (approx.): 66.8 sq. m (719.0 sq. ft)