



White House  
Vicarage Crescent, SW11

CHESTERTONS





This bright and spacious one bedroom apartment has just had a brand-new kitchen and bathroom installed with a full repaint throughout, resurfaced flooring and recently purchased furniture.

The apartment is comprised of a large and bright reception diner with access directly onto the fully refurbished kitchen with integrated appliances including a dishwasher.

There is a large entrance hallway with access onto the bedroom with built in storage, the reception and the fully refurbished bathroom which boast an elegant modern design. Furthermore, there is ample storage off the hallway and hard floor throughout.

White House is a secure gated development with a video entry system and lift. It is excellently located a stone's throw from The River Thames and the local delight which is Battersea Square. A peaceful walk along the river will lead you to the serenity of Battersea Park, one of the best parks London has to offer. For transport, you have a short walk to Clapham Junction which offers excellent connection into the City, including a 7-minute train to Victoria and a 9-minute train to Waterloo.

- Bright and Spacious
- Great Location
- Gated Development
- Hard Wood Flooring
- Lift

### £2,500 pcm

Additional tenant charges apply (fees apply to non-AST tenancies only)

Tenancy Agreement Fee: £300

References per Tenant/Guarantor: £60

Inventory check (approx. £100 – £250 inc. VAT)

[chestertons.co.uk/property-to-rent/applicable-fees](http://chestertons.co.uk/property-to-rent/applicable-fees)

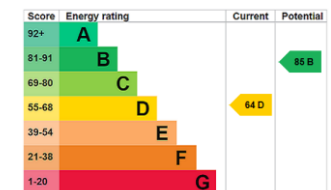

**Minimum Term:** 6 months  
**Deposit Required:** £2,884.62  
**Local Authority:** London Borough of Wandsworth  
**Council Tax Band:** C  
**EPC Rating:** D  
**Furnished**

### Chestertons Battersea Park & Nine Elms Lettings

62-64 Battersea Bridge Road  
 London  
 SW11 3AG

batterseapark@chestertons.co.uk  
 02030408269  
[chestertons.co.uk](http://chestertons.co.uk)

# White House, SW11

Approximate gross internal area

55.25 sq m / 595 sq ft

Key :  
CH - Ceiling Height

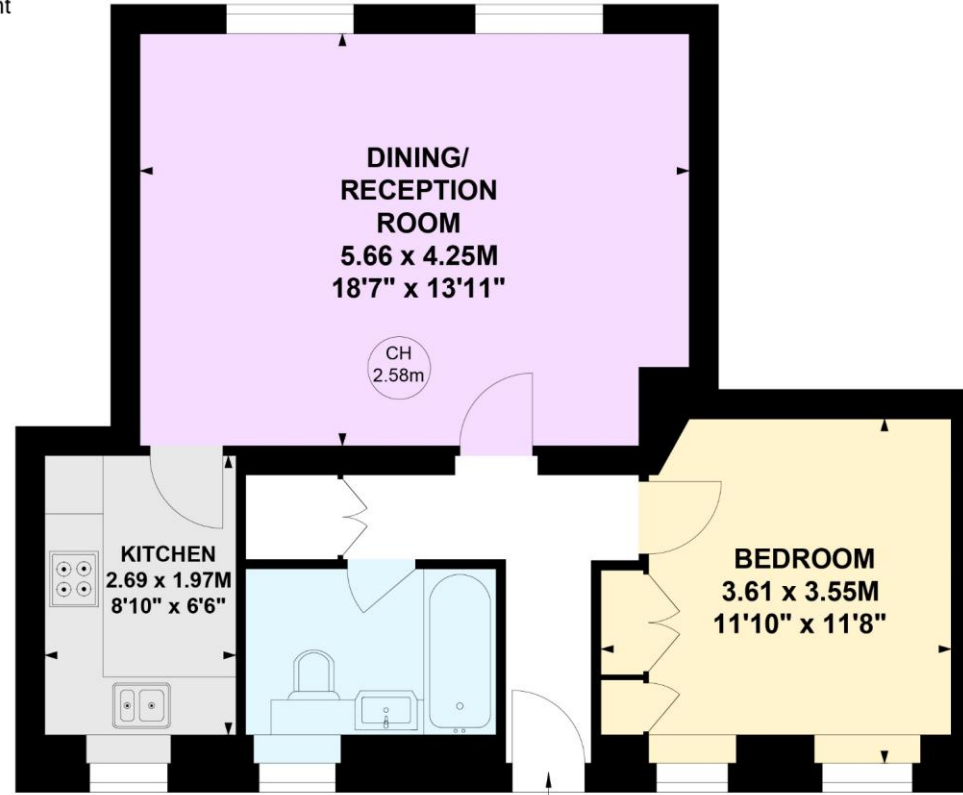

## First Floor

Not to scale, for guidance only and must not be relied upon as a statement of fact.

All measurements and areas are approximate only

Chesterton UK Services Limited trading as Chestertons for themselves and for the vendor of this property whose agents they are, give notice that (i) these particulars do not constitute any part of an offer or contract, (ii) all statements contained within these particulars are made without responsibility on the part of Chestertons or the vendor, (iii) whilst made in good faith, none of the statements contained within these particulars are to be relied upon as a statement or representation of fact, (iv) any intending purchasers must satisfy themselves by inspection or otherwise as to the correctness of each of the statements contained within these particulars, (v) the vendor does not make or give either Chestertons or any person in their employment any authority to make or give representation or warranty whatsoever in relation to this property. Wide angle lenses may be used. ©Copyright Chestertons | Chesterton Global Ltd | Registered Office 5th Floor, The Lantern, 75 Hampstead Road, London, NW1 2PL Registered Company Number 05334580.



This paper is  
100% recyclable