

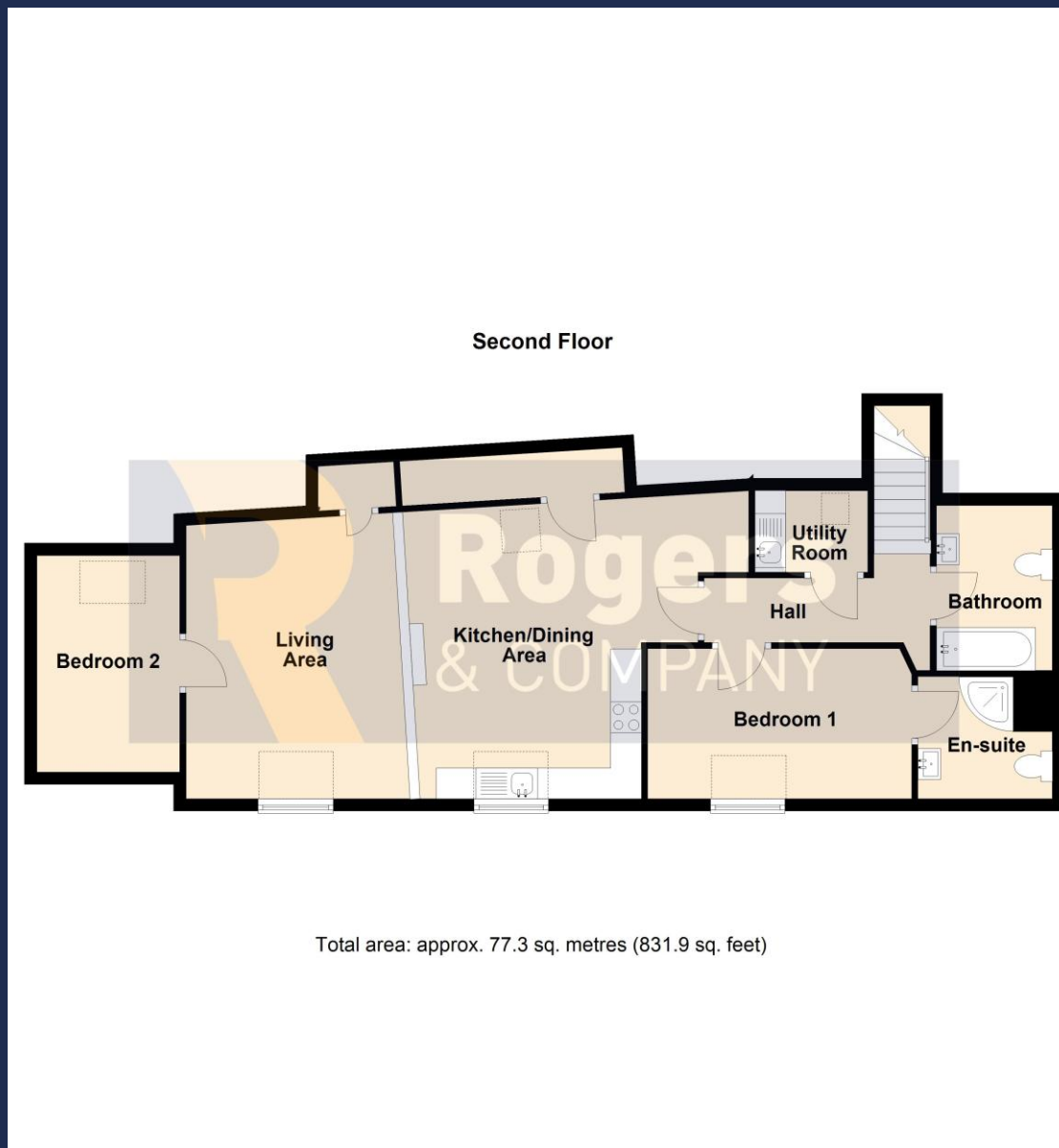

Flat 5
17 Bath Street
Frome
BA11 1DN

Guide Price £299,950

The Top Floor Penthouse of this luxury town centre development. Newly built with the latest heat and sound insulation. There is brand new plumbing, wiring, kitchen, bathrooms and fittings. The heating is via eco electric radiators with this flat benefitting from its own first floor lobby and staircase (leading to the top (second floor) hallway with utility room. The bedrooms are both doubles, the bathroom and en-suite shower rooms are contemporary with a pressurised hot water system. The open plan living/dining/kitchen space is a terrific split level arrangement with exposed timbers and plenty of fitted kitchen units with built in appliances and stylish worktops, quartz sink and induction hob. All on the doorstep of the town within a few feet of some of Frome's best eateries, yet far enough away to not have to see them all the time!



Residential Sales

Knowledge and service is key; this coupled with confidence and motivation make this department a formidable force, with local knowledge comes the confidence to be able to offer the service you expect. Knowing the value of your home is very difficult to predict; using our experience and in-trade tools available to us will give you the best chance of achieving the greatest price from the most suitable buyer in a time frame that works with you.

Residential Lettings

Looking after your investment is our main objective, finding quality tenants and maintaining the property to a high standard makes for a 'Happy Tenancy', our no hidden extras fee structure is highly competitive (if not cheaper) than most agents.

Commercial Sales and Leasing

Having been one of the main local commercial agents in the town; over the past decade; we have been able to assist in modelling the centre by grouping like minded shops enabling them to support each other. In addition we have let numerous industrial units and office complexes in the Commerce Park, Marston and Wallbridge trading estates to both small and large organisations. We believe being passionate about Frome enables us to convince companies relocating or expanding to the area.



- 831 Sqft Brand New Conversion
- Luxury Conversion In The Town Centre
- Penthouse Apartment On The Top Floor
- Two Double Bedrooms
- Generous, Split Level Living/Dining/Kitchen Areas
- Electric Eco Radiators, Utility Room & Eaves Storage
- Luxury Bathroom & En-Suite Shower Room
- Brand New Kitchen & Bathroom Fittings
- Brand New Electrics And Plumbing
- No Chain, Ready to Move Into

- Living/Dining Area 13' 10" (4.22m) x 13' 3" (4.04m)
- Kitchen Area 15' 3" (4.65m) x 11' 0" (3.35m)
- Bedroom One 13' 9" (4.19m) x 8' 10" (2.69m)
- En-Suite 7' 10" (2.39m) x 6' 9" (2.06m)
- Bedroom Two 11' 8" (3.56m) x 7' 7" (2.31m)
- Bathroom 8' 10" (2.69m) x 5' 3" (1.6m)
- Utility Room 6' 3" (1.9m) x 4' 3" (1.3m)



