

8 Birch Covert - £195,000

Thetford Norfolk IP24 2UL

chilterns

Estate & Letting Agents



"Consistently providing outstanding service to our clients"

£195,000

The Property

Nestled in the Cloverfields development in Thetford is this delightful two-bedroom semi-detached house. This property is well-suited for individuals or small families seeking a welcoming home in a popular and well-established residential neighbourhood.

This property benefits from the fully enclosed walled rear garden, providing an outdoor space perfect for enjoying sunny days or hosting gatherings with friends and family. Additionally, the property has allocated parking, adding to the convenience and a downstairs cloakroom.

Birch Covert is conveniently situated for easy access to the town centre, making it ideal for those who appreciate the local shops, cafes, and amenities.

Viewings are highly recommended to fully appreciate the appeal of this home. Whether you are a first-time buyer or looking to downsize, this semi-detached house in Thetford is a wonderful opportunity not to be missed.

Features

- POPULAR CLOVERFIELDS DEVELOPMENT
- CONVENIENT FOR TESCO SUPERSTORE
- WITHIN EASY REACH OF A11
- SEMI DETACHED HOUSE
- TWO DOUBLE BEDROOMS
- GAS CENTRAL HEATING
- DOWNSTAIRS CLOAKROOM
- ALLOCATED PARKING
- WALL REAR GARDEN
- VIEWING ADVISED!





These sales particulars have been produced as a general guide only and we would draw to your attention that we have not carried out a detailed Survey of the property nor have we tested services, appliances or specific fittings. Whilst measurements and statements given within the details are provided in good faith, their accuracy should not be relied upon. If there are any points about which you may be uncertain or would like further clarification, we would suggest that you telephone this office and speak to our staff who will endeavour to assist you.

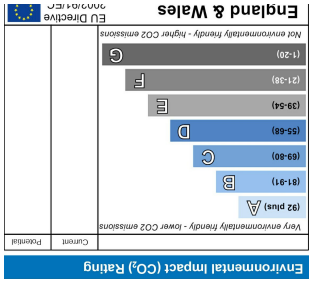
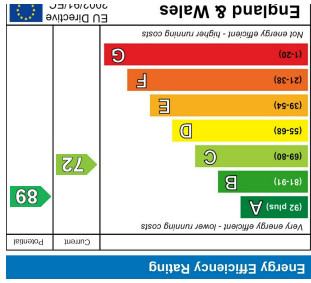

TOTAL APPROX. FLOOR AREA 633 SQ. FT. (58.8 SQ. M.)
MEASUREMENTS ARE APPROXIMATE. NOT TO SCALE. ILLUSTRATIVE PURPOSES ONLY.
MADE WITH METOPRIX ©2015

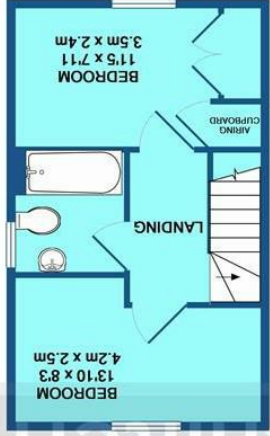

1ST FLOOR
APPROX. FLOOR
AREA 316 SQ. FT.
(29.3 SQ. M.)

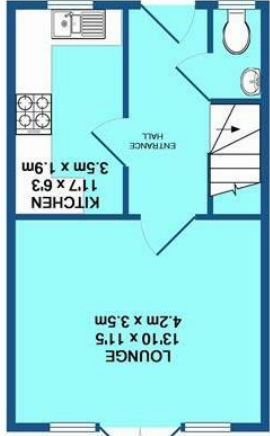

GROUND FLOOR
APPROX. FLOOR
AREA 318 SQ. FT.
(29.5 SQ. M.)