



High Green

Darlington DL2 3DL

£110,000





This footer paragraph is an example only and should not be relied upon as complying with current legislation. These particulars, whilst believed to be accurate are set out as a general outline only for guidance and do not constitute any part of an offer or contract. Intending purchasers should not rely on them as statements of representation of fact, but must satisfy themselves by inspection or otherwise as to their accuracy. No person in this firm's employment has the authority to make or give any representation or warranty in respect of the property.



This footer paragraph is an example only and should not be relied upon as complying with current legislation. These particulars, whilst believed to be accurate are set out as a general outline only for guidance and do not constitute any part of an offer or contract. Intending purchasers should not rely on them as statements of representation of fact, but must satisfy themselves by inspection or otherwise as to their accuracy. No person in this firm's employment has the authority to make or give any representation or warranty in respect of the property.

High Green

Darlington DL2 3DL



- Top Floor Apartment
- Village Location
- Outstanding Views Over Countryside To Front Elevation

- One Bedroom
- Council Tax Band A
- Must Be Seen Internally

- Fully Refurbished
- EPC Rating E

This one bedroom top floor apartment is situated in the village of Gainford and overlooks the village green and offers views over the adjacent countryside and river Tees. The property would suit a single person or those wanting to downsize and briefly comprises: entrance hallway, open plan lounge/kitchen/diner with dual aspect windows, a good size bedroom and separate bathroom.

Viewing comes highly recommended.

Communal Entrance Hallway

With staircase to all floors.

Apartment Entrance Hall

With front door and electric heater and intercom for door entry.

Lounge/Kitchen/Diner

12'10 x 12'4 (3.91m x 3.76m)

With three sash windows, beams to ceiling, part vinyl flooring, the kitchen area is fitted with a range of walnut wall, base and drawer units, contrasting work surfaces, composite sink unit with mixer tap, integrated fridge/freezer, double oven, four ring electric hob.

Bedroom

19'7 x 10'11 (5.97m x 3.33m)

With window to the front and radiator.

Bathroom

Fitted with a suite comprising free standing bath with mixer tap and spray attachment, shower cubicle, low level wc, wash hand basin, window to the side and vinyl flooring.

View From Apartment

Overlooking the village green and countryside.

Property Information

Local Authority

Durham

Council Tax

Band:

A

Annual Price:

£1,621

Conservation Area

Gainford

Flood Risk

No Risk

Floor Area

462 ft 2 / 43 m 2

Plot size

0.09 acres

Mobile coverage

EE

Vodafone

Three

O2

Broadband

Basic

18 Mbps

Superfast

80 Mbps

Satellite / Fibre TV Availability

BT

Sky

Tenure

This property is leasehold

999 year Lease from 1st August 1987

Service Charges: £137.50 per month

Ground Rent: £50 per annum

Note

IMPORTANT NOTE TO PURCHASERS: We endeavour to make our sales particulars accurate and reliable, however, they do not constitute or form part of an offer or any contract and none is to be relied upon as statements of representation or fact. The services, systems and appliances listed in this specification have not been tested by us and no guarantee as to their operating ability or efficiency is given. All measurements have been taken as a guide to prospective buyers only, and are not precise. Floor plans where included are not to scale and accuracy is not guaranteed. If you require clarification or further information on any points, please contact us, especially if you are travelling some distance to view. Fixtures and fittings other than those mentioned are to be agreed with the seller. We cannot also confirm at this stage of marketing the tenure of this house

Photo's

Photo's were taken prior to purchase - September 2022

Ground Floor

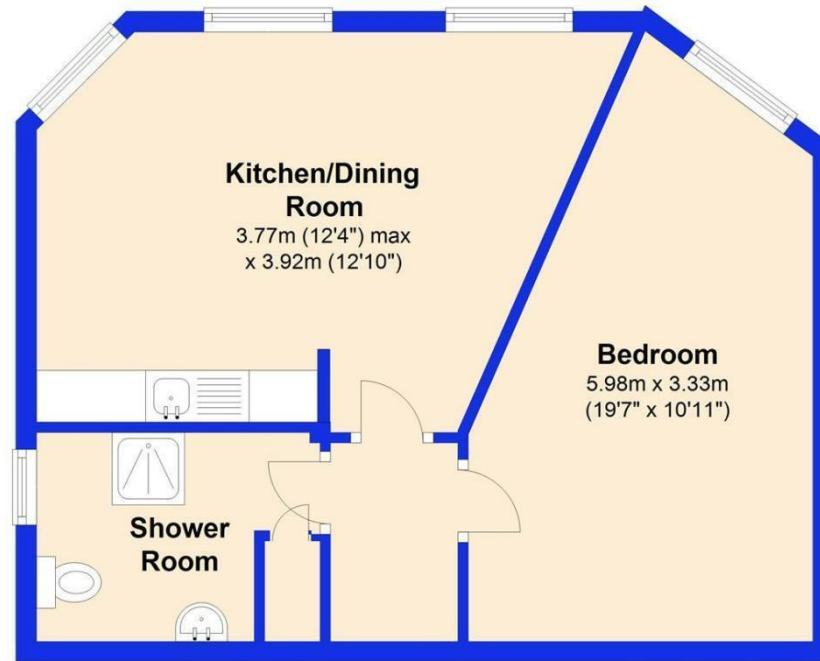

For illustrative purposes only. Not to scale. Produced by HJ Cadplan Ltd.
Plan produced using PlanUp.



Property Information

01325 363858

45 Duke Street, Darlington, County Durham, DL3 7SD
sales@venturepropertiesuk.com