



DUTTON STREET, SE10

£700,000

Mid terrace Victorian house
Two double bedrooms
Refurbished interior
Large loft for storage
West facing garden
Energy rating: d

@marshandparsons
marshandparsons.co.uk

MARSH &
PARSONS



ABOUT THE PROPERTY

Beautifully presented Victorian period house, featuring many original features, a private west facing garden and a large loft, perfect for storage. The interior briefly comprises a good size living room, an impressive kitchen/diner benefitting from some integrated appliances, shower room which includes a large storage/utility cupboard and two double bedrooms.

A short walk away is the hidden gem that is Point Park, a beautiful row of shops located on Royal Hill, including a green grocer's, butchers, fish mongers and the cheeseboard. Greenwich town centre for the royal park, covered market, royal naval college, Greenwich pier, Greenwich rail and DLR stations are moments away.



STEP INSIDE DUTTON STREET

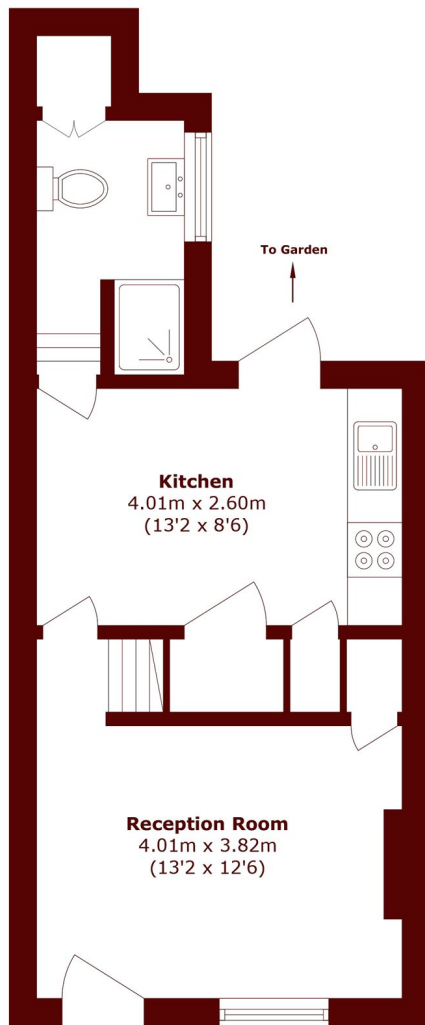

Ground Floor

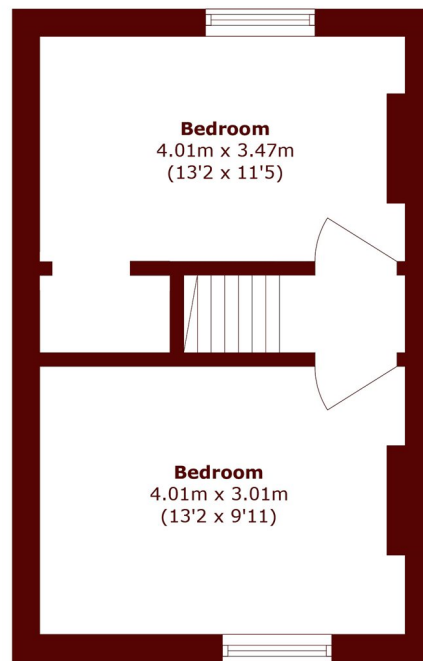

First Floor

Total area (approx.): 58.6 sq. m (630.7 sq. ft)

Greenwich
020 8312 8312

Energy Rating: D We aim to make our particulars both accurate and reliable. However, they are not guaranteed; nor do they form part of an offer or contract. If you require clarification on any points then please contact us, especially if you're traveling some distance to view. Please note that appliances and heating systems have not been tested and therefore no warranties can be given as to their good working order

**MARSH &
PARSONS**