



Stockwell Road, SW9

£2,800 Per calendar month

Internally this three double bedroom flat offers a reception room, spacious kitchen with a small balcony and a modern family bathroom. Ideal for professional sharers who regularly commute into the City.

Burford House on Stockwell Road is located between both Stockwell tube station and Brixton tube/overground station, with many local amenities close by.

Features

- Three Double Bedrooms
- Reception Room
- Modern Kitchen
- Small Balcony
- Family Bathroom
- Close To Tube

Stockwell Road, London, SW9

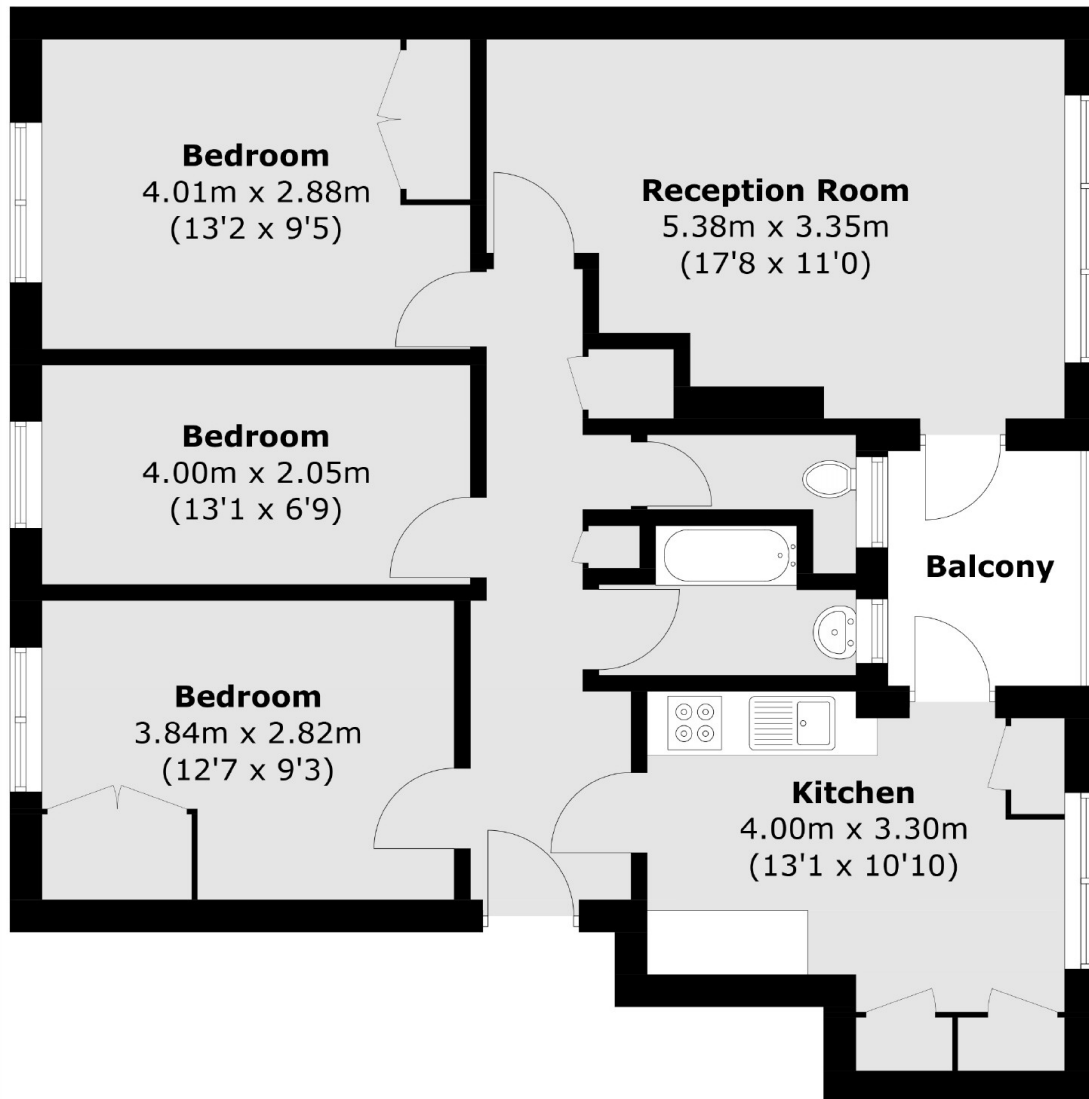

Total area (approx.): 76.3 sq. m (821.2 sq. ft)
Balcony: 3.9 sq. m (41.9 sq. ft)