



## Royal Quarter, KT2

£2,350 Per calendar month

A two bedroom, two bathroom apartment located in the modern, centrally located development. With underground parking, 24 hour concierge, and a residents gym this is the perfect property for those looking for a fresh start.

Royal Quarter is in the heart of Kingston, moments from the Bentalls Centre, Kingston train station and an array of bars and delicious restaurants along the riverside.

### Features

- Two Bedrooms
- Two Bathroom
- Fantastic Views
- Close To Several Amenities
- Allocated Parking
- Spacious And Bright

# Royal Quarter, Kingston Upon Thames, KT2

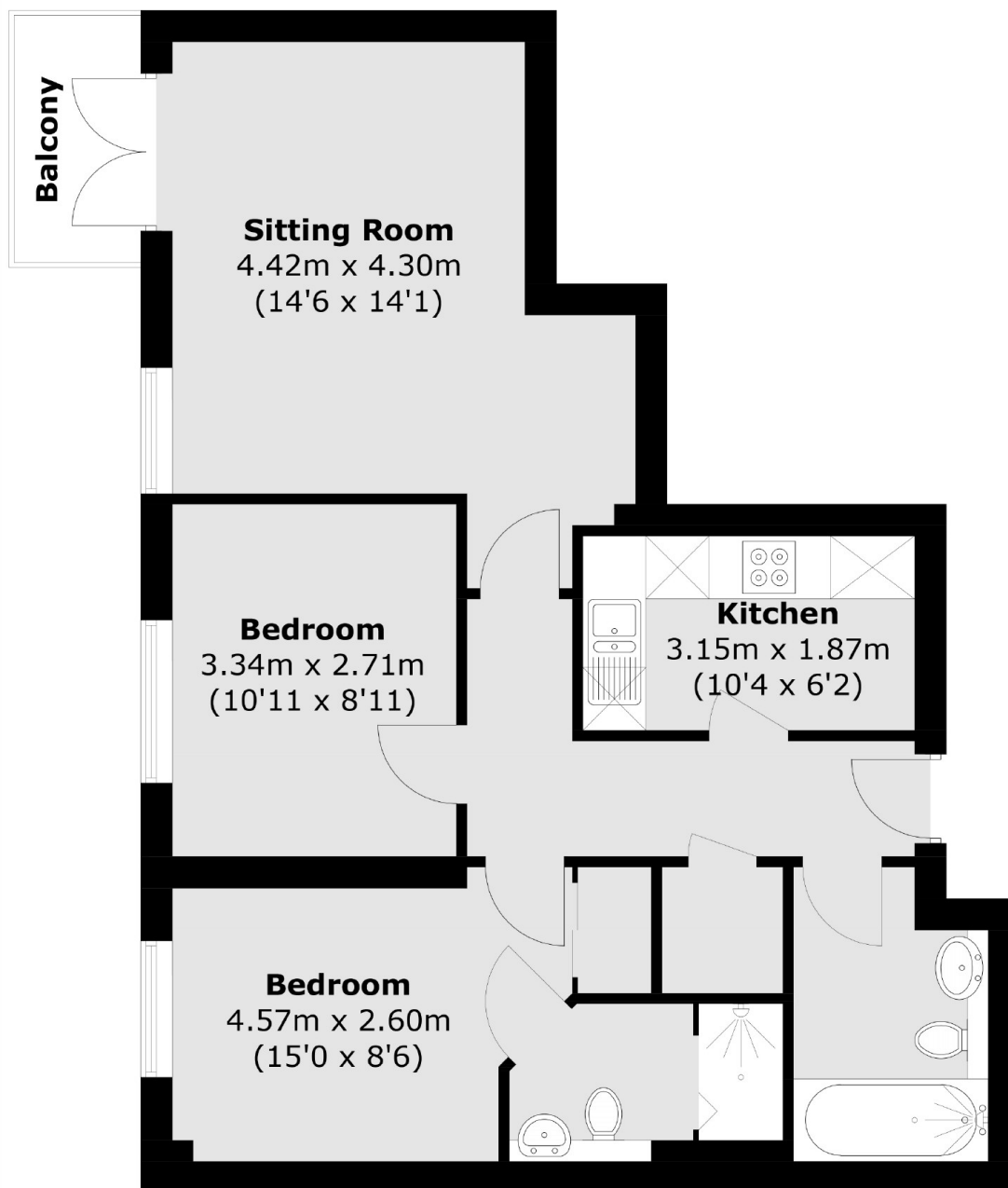

## Fifth Floor

Total area (approx.): 61.8 sq. m (665.2 sq. ft)  
Balcony area : 2.8 sq. m (30.1 sq. ft)