

30 Holland Street

Brighton BN2 9WB

Asking Price Of £550,000

- PRESENTED IN EXCELLENT ORDER
- ARRANGED OVER THREE FLOORS
- WONDERFUL KITCHEN/LIVING ROOM
- THREE DOUBLE BEDROOMS
- SPACIOUS FAMILY BATHROOM
- DELIGHTFUL PATIO
- DESIRABLE LOCATION
- PERIOD FAMILY HOME

This beautifully presented period family home is arranged over three floors and offers a perfect blend of character and contemporary living. Finished to an exceptional standard throughout, the property features a stunning open plan kitchen and living space, complete with bi-fold doors that open seamlessly onto a private patio garden ideal for entertaining and everyday family life.

The home boasts three generously sized double bedrooms and a stylish, well appointed family bathroom. Thoughtfully designed interiors and bespoke finishes add to the overall sense of quality and individuality.

Situated in the highly sought after Hanover district, the property enjoys a prime location within easy walking distance of Brighton Station and the vibrant city centre, making it ideal for commuters and those looking to enjoy everything the city has to offer.

ENTRANCE HALL Painted floorboards, sash window.

BEDROOM 3 Sash window, radiator.

BATHROOM Bespoke suite with central freestanding bath, separate walk in shower, sink with drawers under, low level w.c, part tiled walls, tiled floor, UPVC double glazed bay window, radiator with towel rail.

GARDEN LEVEL

KITCHEN/LIVING ROOM Delightful space with bi-fold doors opening onto the patio garden. The kitchen incorporates sink with mixer tap, 'Quartz' work surface with range of cupboards and drawers under, five ring gas hob, electric oven, integrated dishwasher, space for fridge/freezer, plumbing for washing machine, radiator, wood floor, UPVC double glazed window.

FIRST FLOOR

LANDING Hatch to loft, sash window.

BEDROOM 1 Range of fitted wardrobes, single fitted cupboard, feature fireplace, sash window, radiator.

BEDROOM 2 Fitted wardrobes, feature fireplace, radiator, UPVC double glazed bay window.

Council Tax Band C (taken from the government website, www.brighton-hove.gov.uk/council-tax). We advise that you check this information, we will not be held responsible if the council tax band differs when occupying the property.

HOLLAND STREET

BRIGHTON

APPROXIMATE GROSS INTERNAL AREA
83.9 sq m / 901 sq ft

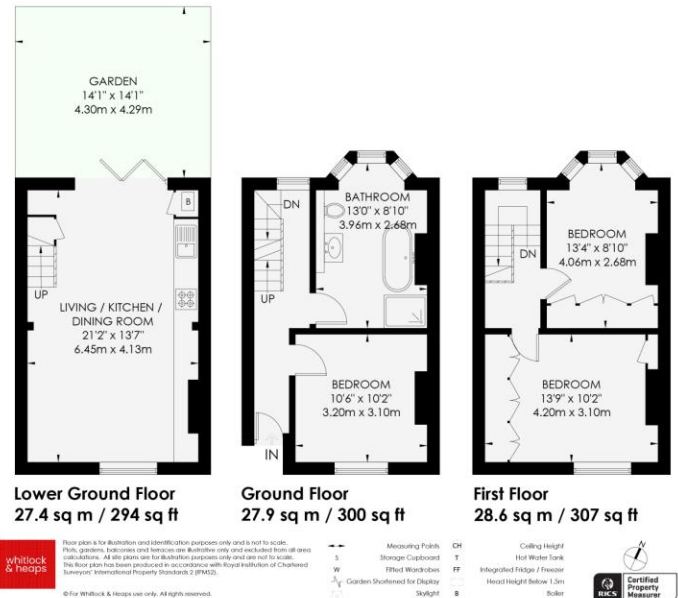

65 Sackville Road, Hove BN3 3WE
sales@whitlockandheaps.co.uk
 01273 778577



Disclaimer: Whitlock & Heaps have produced these particulars in good faith and they are set out as a general guide. Accuracy is not guaranteed, nor do they form part of any contract. If there is any particular aspect of these details which you require any confirmation, please do contact us, especially if contemplating a long journey. All measurements are approximate. Fixtures and fittings, other than those mentioned above, to be agreed with the seller. Any services, systems or appliances at the property have not been tested.