

Townmead Road, SW6

£935 Per week

SHORT LET: This modern bedroom flat on the first floor offers a modern fully fitted open plan kitchen living room with wood floors throughout, a modern tiled bathroom and 24 hour concierge.

Imperial Wharf is served by its own overground station. Alternatively commuters can brave the Thames with the River Taxi at Chelsea Harbour.

Features

- One Bedroom
- Large Terrace
- Gym Access
- Bills Included
- 24hrs Concierge
- Short Let

Townmead Road, London, SW6

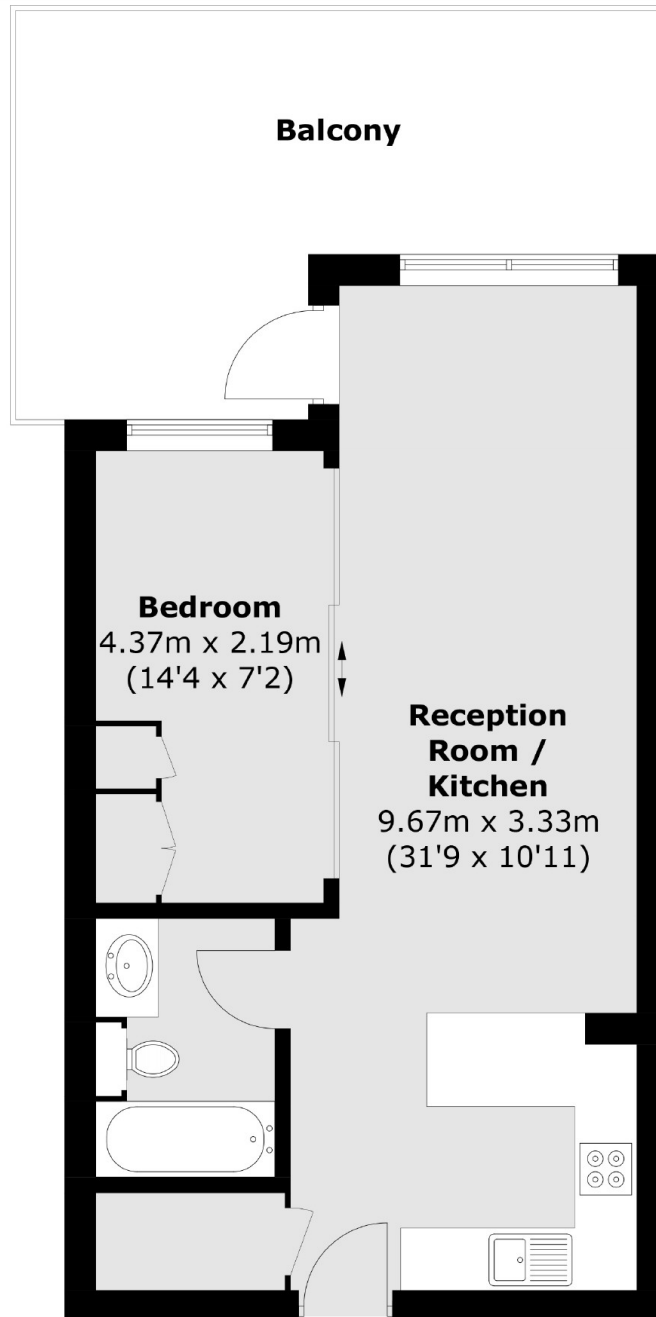

Total area (approx.): 46.9 sq. m (504.8 sq. ft)
Balcony (approx.): 19.1 sq. m (205.5 sq. ft)