



Property Description

An immaculate first-floor apartment situated on the sought-after Manor Farm Development. Built in 2018 by a respected local developer, the property is ideally positioned within easy reach of local amenities, including shops, a doctor's surgery, and a café.

The accommodation comprises a secure communal entrance with entry phone system, an entrance hallway, a spacious double bedroom with fitted wardrobes and bedside tables, a stylish modern bathroom, and a useful storage cupboard. The open-plan living, dining, and kitchen area is bright and contemporary, with the kitchen featuring modern units and integrated appliances including a fridge/freezer, washer/dryer, dishwasher, oven, and hob.

Further benefits include a private balcony, double glazing, gas central heating, and an allocated parking space.

Available from early August.

COUNCIL TAX B

EPC RATING B

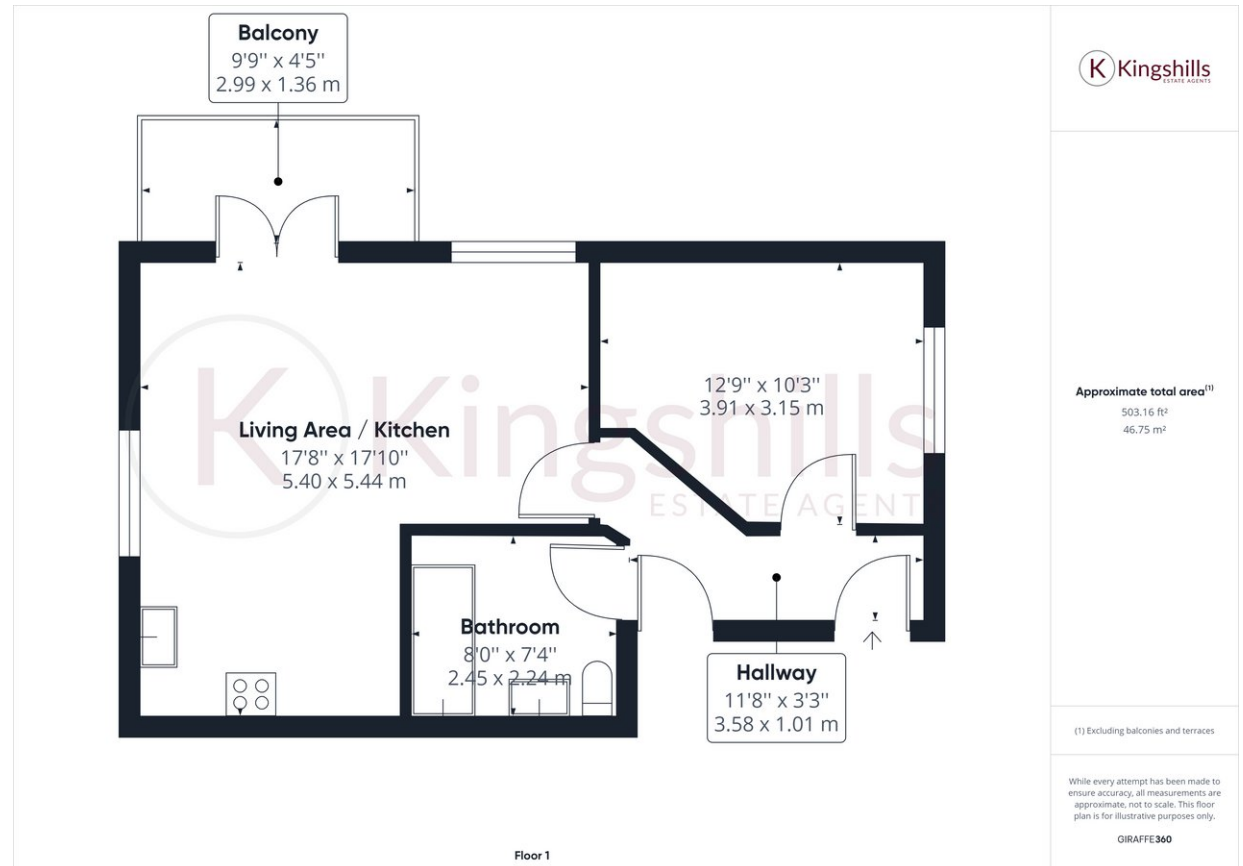

Kingshills Estate Agents
C1C Comet Studios
Amersham
Buckinghamshire
HP7 0PX

01494 939868
hello@kingshills.co.uk
kingshills.co.uk

Agents Note: Whilst every care has been taken to prepare these particulars, they are for guidance purposes only. All measurements are for general guidance purposes only and whilst every care has been taken to ensure accuracy, they should not be relied upon and potential buyers/tenants are advised to recheck the measurements