

## Molyneux Street, W1H

£625 Per week

A well-presented one bedroom apartment on the first floor of an attractive purpose built building on Molyneux Street. The property has a separate modern kitchen, reception room, a double bedroom and bathroom.

Molyneux Street is a short walk from Marble Arch, Edgware Road and Baker Street Underground stations. Portman Village close by, offering an array of independent boutiques, cafes and restaurants, and both Hyde Park and Regent's Park are within easy reach.

### Features

- First Floor Apartment
- One Bedroom
- High Ceilings
- Modern
- Separate Kitchen
- Wood Flooring

# Molyneux Street, London, W1H

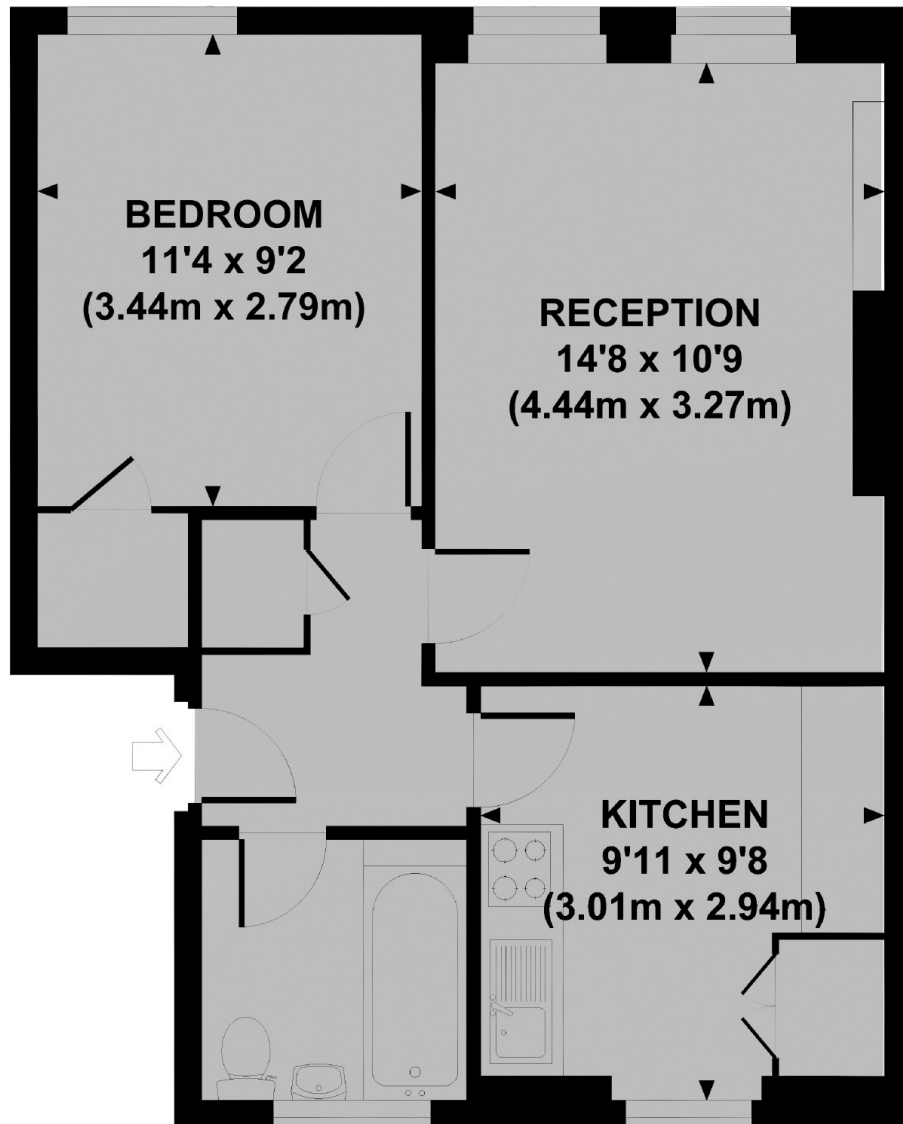

## FIRST FLOOR

Approx. gross internal area  
466 Sq Ft. / 43.3 Sq M.