



**CUMBERLAND AVENUE**  
SLOUGH, SL2 1AN

**£325,000**



**1**



**1**



**3**

**EPC**



**This property is for sale by the Modern Method of Auction, meaning the buyer and seller are to Complete within 56 days (the "Reservation Period"). Interested parties personal data will be shared with the Auctioneer (iamsold).**

**If considering buying with a mortgage, inspect and consider the property carefully with your lender before bidding. A Buyer Information Pack is provided. The winning bidder will pay £349.00 including VAT for this pack which you must view before bidding.**

**The buyer signs a Reservation Agreement and makes payment of a non-refundable Reservation Fee of 4.5% of the purchase price including VAT, subject to a minimum of £6,600.00 including VAT. This is paid to reserve the property to the buyer during the Reservation Period and is paid in addition to the purchase price. This is considered within calculations for Stamp Duty Land Tax.**

**Services may be recommended by the Agent or Auctioneer in which they will receive payment from the service provider if the service is taken. Any payment that will be received by the Agent or Auctioneer will be confirmed to you in writing before services are taken. Services are optional.**

- 3 Bedroom Semi Detached
- Excellent transport links via the A4, M4 and M25
- Walking distance to local shops, supermarkets, cafés and amenities along Farnham Road
- Spacious accommodation with great potential for families, first-time buyers or investors
- Easy access to Slough town centre, Burnham station and the Elizabeth Line
- Double glazing and gas central heating throughout
- Driveway parking with side access to the property
- Buyers Fees Apply



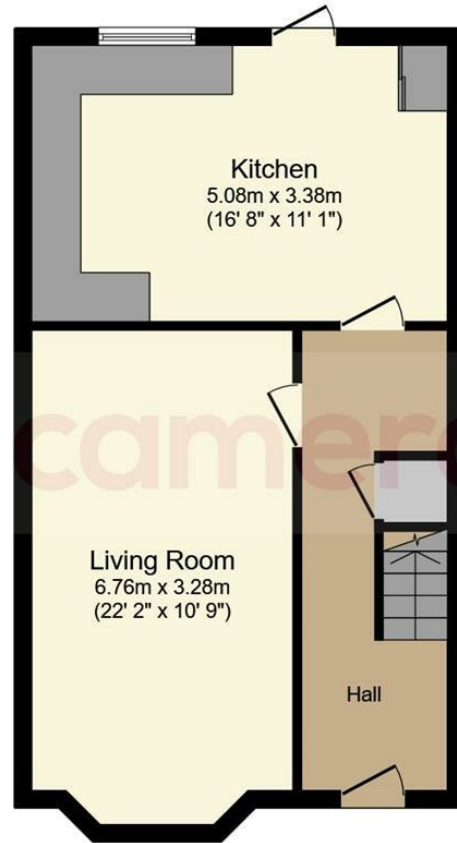

Ground Floor

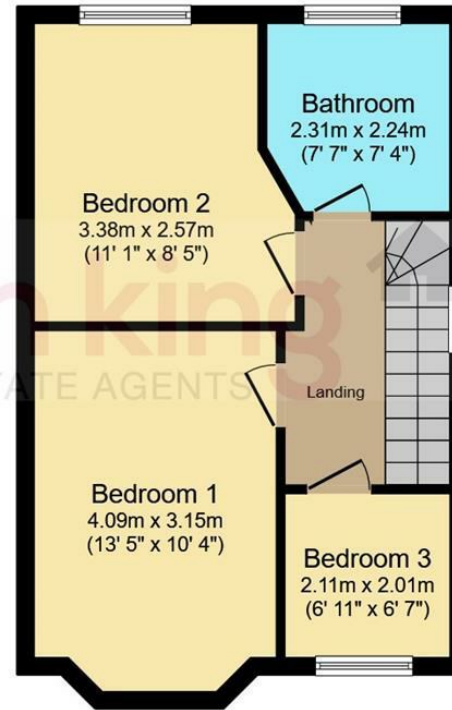

First Floor

Total floor area: 87.2 sq.m. (938 sq.ft.)

This floor plan is for illustrative purposes only. It is not drawn to scale. Any measurements, floor areas (including any total floor area), openings and orientations are approximate. No details are guaranteed, they cannot be relied upon for any purpose and do not form any part of any agreement. No liability is taken for any error, omission or misstatement. A party must rely upon its own inspection(s). Powered by www.Propertybox.io



411 Bath Road, Slough, SL1 5QL  
 t: 01628 667442  
 e: sales@cameronking.co.uk

