



Halifax Road, Sheffield, S6 1AF

Offers Over £150,000

2 1 0



Why You'll Love It

This home blends practical living with outdoor appeal. The spacious lounge with its attractive bay window makes a welcoming retreat, while the dining room flows into a conservatory, creating versatile space for entertaining or relaxing. To the first floor, you will find a practical shower room and two generous bedrooms, each filled with natural light, one of which benefits from a fixed loft ladder providing access to a fully boarded loft, creating useful storage space. Externally, the rear garden provides ample space for play, gardening, or summer gatherings, with the bonus of a garage and driveway to the front.

Why We Love The Location

Located in a popular and established residential location, the property offers a balance of convenience and community. Excellent transport links connect you to Sheffield and beyond, while nearby supermarkets, shops, schools and parks ensure daily essentials and leisure facilities are always within reach. The area is popular with families thanks to its friendly feel and easy access to countryside walks.



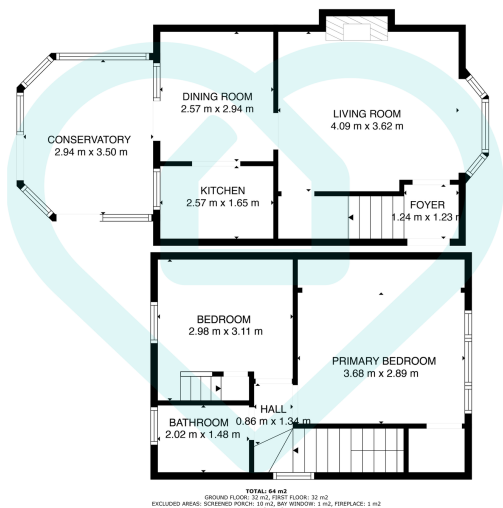

This floor plan is for illustrative purposes only. All measurements and layouts are approximations and do not necessarily capture the precise specifications of the property. No responsibility is taken for any error, omission, or misstatement. We always recommend viewing in person to confirm the exact floor plan of a property. Made with Metropix.



- Attractive Semi-Detached Home
- Separate Dining Room Leading Into Conservatory
- Shower Room
- Generous Rear Garden With Patio & Lawn
- Excellent Access To Transport Links
- Spacious Lounge With Bay Window
- Two Generous Bedrooms
- Garage & Driveway
- Popular Location
- Close to Amenities

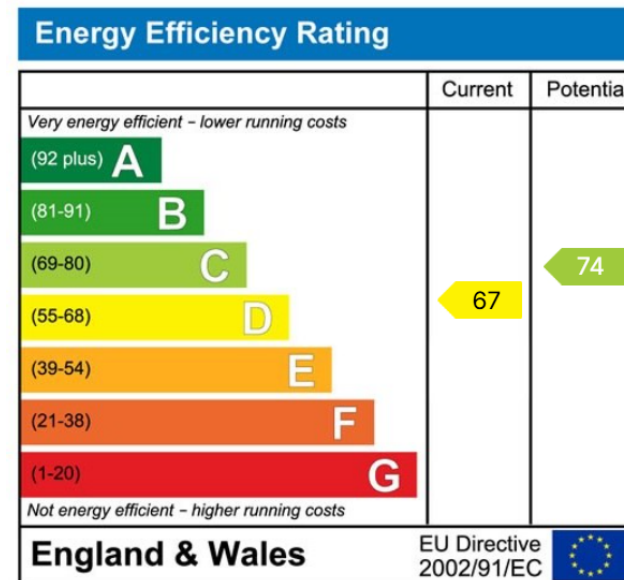

Sales | Lettings | New Homes

VAT Reg Number: 191 3588 84
 Company Reg Number: 08610489
 Company Reg Address: 67 Middlewood Road, Hillsborough, Sheffield, S6 4GX.

The MorfittSmith Building
 67 Middlewood Road
 Hillsborough
 Sheffield
 S6 4GX

Get in touch - arrange an appointment



0114 232 1764
 sales@morfittsmith.co.uk
 lettings@morfittsmith.co.uk
 newhomes@morfittsmith.co.uk
 www.morfittsmith.co.uk



@MorfittSmith
 @MorfittSmith
 MorfittSmith
 Estate & Letting Agent