



## 66 Corelli Close, Stratford-Upon-Avon

Offers Over **£170,000**





## 66 Corelli Close

Stratford-Upon-Avon, Stratford-Upon-Avon

**Well-presented 2-bed first floor apartment with garage, allocated parking, new carpets, redecorated, spacious living, separate kitchen, bath and shower. Ideal for first-time buyers or investors.**

Council Tax band: C

Tenure: Leasehold

EPC Energy Efficiency Rating: C

EPC Environmental Impact Rating: B

- First Floor Apartment
- Two Double Bedrooms
- Lounge Diner
- Kitchen
- Bathroom With Separate Shower
- Garage & Allocated Parking
- Redecorated Throughout & New Carpets
- Ideal First Time or Investment Purchase
- No Onward Chain







## GROUND FLOOR

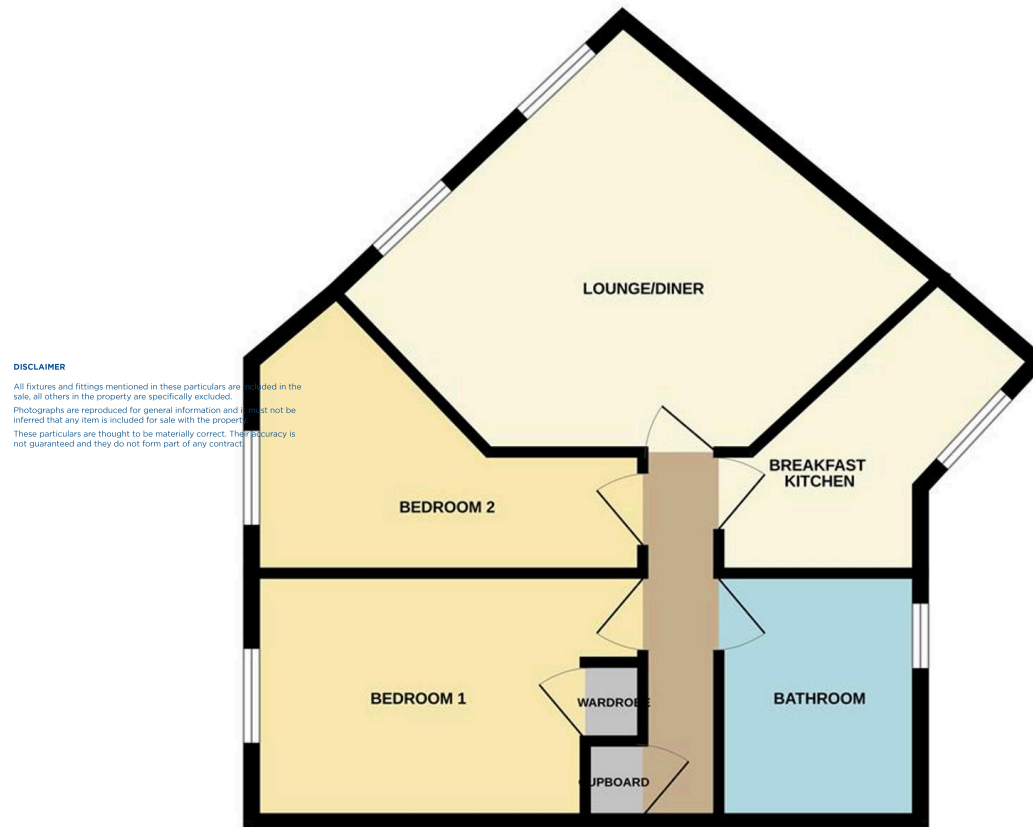

This floor plan is not to scale and is for guidance purposes only  
Made with Metropix ©2025

## Sheldon Bosley Knight Stratford-Upon-Avon

Sheldon Bosley Knight, 35-36 Rother Street - CV37 6LP

01789387887 · stratfordsales@sheldonbosleyknight.co.uk · [www.sheldonbosleyknight.co.uk/](http://www.sheldonbosleyknight.co.uk/)

### DISCLAIMER

All fixtures and fittings mentioned in these particulars are included in the sale, all others in the property are specifically excluded.

Photographs are reproduced for general information and it must not be inferred that any item is included for sale with the property.

These particulars are thought to be materially correct. Their accuracy is not guaranteed and they do not form part of any contract.