



**Pinewood Drive, BIRMINGHAM B32 4LG**

**welcome to**

## **Pinewood Drive, BIRMINGHAM**

This is a beautiful three-bedroom home that has been cared for, in good condition, that has many wonderful features. Being the perfect family home due to its size & location, this property is just a stones throw from several primary schools.

### **Auctioneer's Comments**

This property is offered through Modern Method of Auction. Should you view, offer or bid your data will be shared with the Auctioneer, iamsold Limited. This method requires both parties to complete the transaction within 56 days, allowing buyers to proceed with mortgage finance (subject to lending criteria, affordability and survey). The buyer is required to sign a reservation agreement and make payment of a non-refundable Reservation Fee of 4.5% of the purchase price including VAT, subject to a minimum of £6600.00 including VAT. This fee is paid in addition to purchase price and will be considered as part of the chargeable consideration for the property in the calculation for stamp duty liability. Buyers will be required to complete an identification process with iamsold and provide proof of how the purchase would be funded. The property has a Buyer Information Pack containing documents about the property. The documents may not tell you everything you need to know, so you must complete your own due diligence before bidding. A sample of the Reservation Agreement and terms and conditions are contained within this pack. The buyer will also make payment of no more than £349 inc. VAT towards the preparation cost of the pack. Please confirm exact costs with the auctioneer. The estate agent and auctioneer may recommend the services of other providers to you, in which they will be paid for the referral. These services are optional, and you will be advised of any payment, in writing before any services are accepted. Listing is subject to a start price and undisclosed reserve price that can change.

### **Agent Note**

This property is council tax band C.

### **Entrance Hall**

8' 5" x 7' ( 2.57m x 2.13m )

Front door into hall, double glazed window to front, stairs to first floor, carpet, ceiling light point.

### **Lounge**

18' 10" x 10' 5" ( 5.74m x 3.17m )

Double glazed window to rear, gas fire, carpet, ceiling & wall light connections.

### **Kitchen**

10' 11" x 7' 7" ( 3.33m x 2.31m )

Double glazed window to rear, space for free-standing cooker with cooker hood over, tiled floor, sink & drainer with mixer tap, space for washing machine, 2 ceiling light points, space for under counter fridge & freezer, range of wall & base units with worktops over, door to garden patio.

### **Garage**

16' x 7' 9" ( 4.88m x 2.36m )

Shutter roll up and over door, electric points, ceiling lights, boiler, door to side.

### **Landing**

Door to the three bedrooms & bathroom.

### **Bedroom 1**

12' 1" x 10' 3" ( 3.68m x 3.12m )

Double glazed window to rear, ceiling light point, carpet, central heating radiator.

### **Bedroom 2**

12' 1" x 7' 11" ( 3.68m x 2.41m )

Double glazed window to rear, ceiling light point, carpet, central heating radiator.

### **Bedroom 3**

12' 6" x 7' 9" ( 3.81m x 2.36m )

Double glazed window to front, ceiling light point, carpet, central heating radiator.





### **Bathroom**

8' 6" x 7' 3" ( 2.59m x 2.21m )

Double glazed frosted window, ceiling light point, wash hand basin with hot & cold taps, low level flush w/c, bath with shower over & shower curtain above, tiled walls, vinyl flooring, built in cupboards with water tank.

### **Front Garden**

Paved driveway, gravelled area, access to garage & rear garden, steps up to front door.

### **Rear Garden**

Block paved patio area, raised flower beds, fencing to one side and rear, artificial grass.



***view this property online*** [shipways.co.uk/Property/HBN112422](http://shipways.co.uk/Property/HBN112422)



welcome to

## Pinewood Drive, BIRMINGHAM

- Sale by Modern Auction (T&Cs apply)
- Subject to an undisclosed Reserve Price
- Buyers' fees apply
- END-TERRACED
- NO CHAIN

Tenure: Freehold EPC Rating: D  
Council Tax Band: C

guide price

**£230,000**

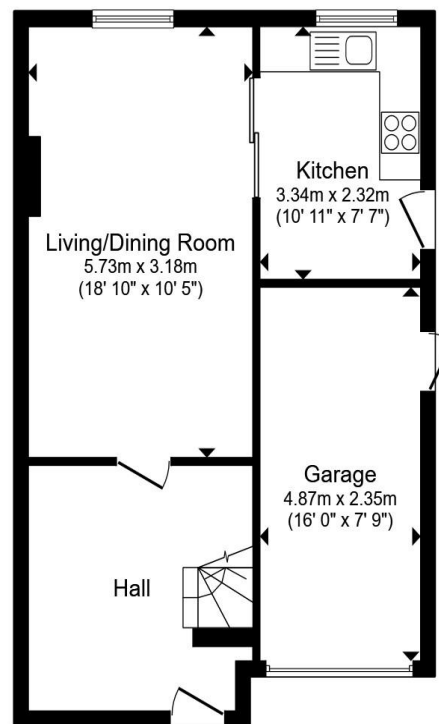

Ground Floor

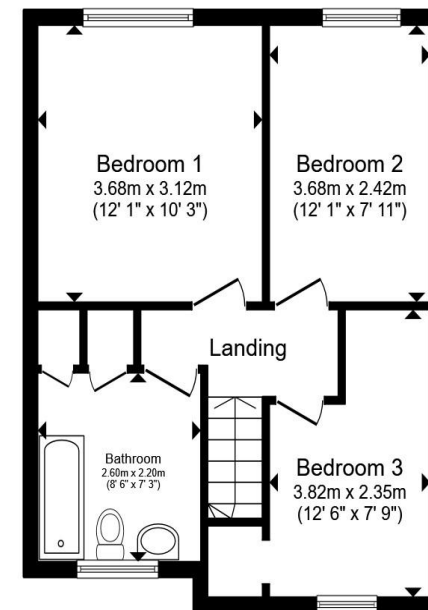

First Floor

Total floor area 92.7 m<sup>2</sup> (998 sq.ft.) approx

This floor plan is for illustrative purposes only. It is not drawn to scale. Any measurements, floor areas (including any total floor area), openings and orientation are approximate. No details are guaranteed, they cannot be relied upon for any purpose and they do not form part of any agreement. No liability is taken for any error, omission or misstatement. A party must rely upon its own inspection(s). Powered by [www.propertybox.io](http://www.propertybox.io)



view this property online [shipways.co.uk/Property/HBN112422](http://shipways.co.uk/Property/HBN112422)



Property Ref:  
HBN112422 - 0003

1. MONEY LAUNDERING REGULATIONS Intending purchasers will be asked to produce identification documentation at a later stage and we would ask for your co-operation in order that there is no delay in agreeing the sale. 2. These particulars do not constitute part or all of an offer or contract. 3. The measurements indicated are supplied for guidance only and as such must be considered incorrect. Potential buyers are advised to recheck measurements before committing to any expense. 4. We have not tested any apparatus, equipment, fixtures or services and it is in the buyers interest to check the working condition of any appliances. 5. Where an EPC, or a Home Report (Scotland only) is held for this property, it is available for inspection at the branch by appointment. If you require a printed version of a Home Report, you will need to pay a reasonable production charge reflecting printing and other costs. 6. We are not able to offer an opinion either written or verbal on the content of these reports and this must be obtained from your legal representative. 7. Whilst we take care in preparing these reports, a buyer should ensure that his/her legal representative confirms as soon as possible all matters relating to title including the extent and boundaries of the property and other important matters before exchange of contracts.

Shipways is a trading name of Sequence (UK) Limited which is registered in England and Wales under company number 4268443, Registered Office is Cumbria House, 16-20 Hockliffe Street, Leighton Buzzard, Bedfordshire, LU7 1GN. VAT Registration Number is 500 2481 05.



**0121 427 3264**



[harborne@shipways.co.uk](mailto:harborne@shipways.co.uk)



172 High Street, Harborne, BIRMINGHAM,  
West Midlands, B17 9PP



[shipways.co.uk](http://shipways.co.uk)