

www.jeffreygross.co.uk

CARDIFF

VALE

CAERPHILLY

BRISTOL



St. Davids Way

CAERPHILLY



Comments by Whitney Jenkins



Property Specialist
Whitney Jenkins
Sales Negotiator

whitney.jenkins@brinsons.co.uk

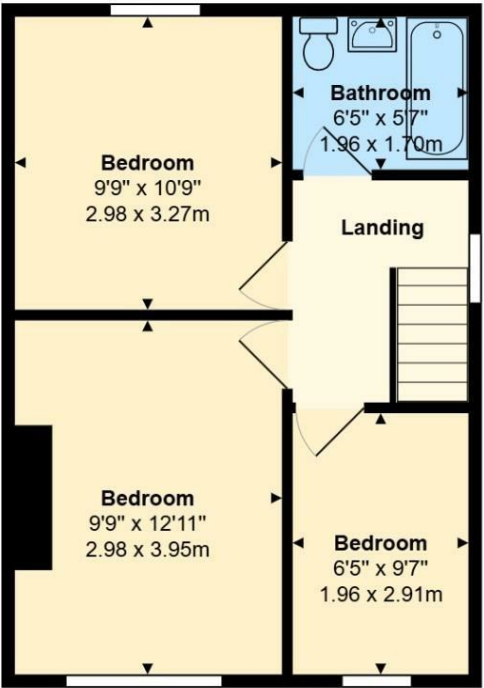
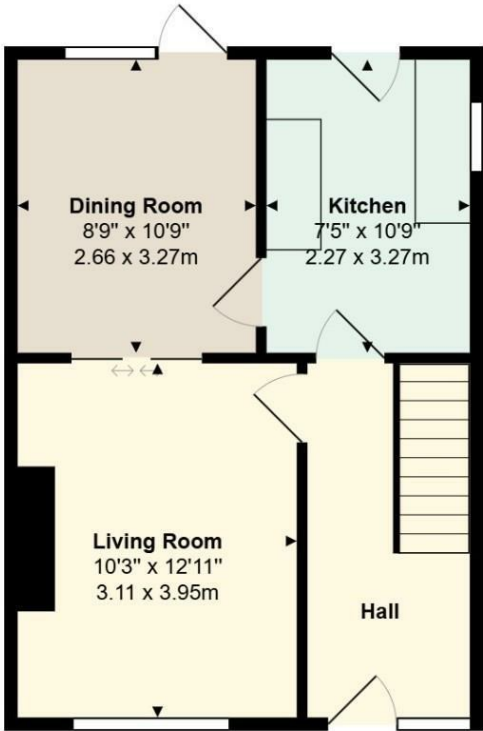

St David's Way

Total Area: 797 ft² ... 74.1 m²

All measurements are approximate
and for display purposes only

Great three bedroom semi detached property in a Caerphilly center location.

Comments by the Homeowner





St. Davids Way

Caerphilly, Caerphilly, CF83 1EY

Asking Price

£240,000



3 Bedroom(s)



1 Bathroom(s)



797.00 sq ft



Contact our
Brinsons Caerphilly Branch
029 20867711

Nestled in the sought-after area of St. Davids Way, Caerphilly, this charming three-bedroom semi-detached house presents an excellent opportunity for those looking to create their dream home. Spanning approximately 797 square feet, the property boasts two spacious reception rooms, perfect for both entertaining guests and enjoying family time.

The three well-proportioned bedrooms offer ample space for relaxation and rest, while the bathroom provides essential facilities for everyday living. The property also features a garage, adding to the convenience of this delightful home.

One of the standout features of this residence is the generous parking space, accommodating up to three vehicles, which is a rare find in this desirable location. Although the house requires some updating, it is an ideal canvas for buyers wishing to personalise their living space to suit their tastes and preferences.

With no onward chain, this property is ready for a swift transaction, making it an attractive option for both first-time buyers and those looking to invest in a family home. Embrace the potential of this semi-detached house and seize the opportunity to transform it into a stunning residence in a lovely neighbourhood.



Hall	English Medium Primary School : THE TWYN SCHOOL English Medium Secondary School : ST. MARTINS COMPREHENSIVE SCHOOL
Living Room 10'3 x 12'11 (3.12m x 3.94m)	Council Tax Band - D
Dining Room 8'9 x 10'9 (2.67m x 3.28m)	
Kitchen 7'5 x 10'9 (2.26m x 3.28m)	
Bedroom One 9'9 x 12'11 (2.97m x 3.94m)	
Bedroom Two 9'9 x 10'9 (2.97m x 3.28m)	
Bedroom Three 6'5 x 9'7 (1.96m x 2.92m)	
Bathroom 6'5 x 5'7 (1.96m x 1.70m)	
Tenure Freehold	
School Catchments These are the Schools for your Catchment Area :	
Welsh Medium Primary School : Y.G.G. Y CASTELL Welsh Medium Secondary School : Y GWYNDY - YSGOL GYFUN CWM RHYMNI	



