



Connells

Rowan Cottage Church Road
Cophorne



Property Description

GUIDE PRICE of £650,000-£700,000 A stunning four-bedroom detached property tucked away in the heart of Cophorne village well positioned for local amenities, and village schools.

On entering the property you are greeted by two spacious reception rooms, one housing a feature log burner stove. As well as a stunning large kitchen/breakfast room opening out onto the rear courtyard patio area perfect for entertaining and relaxing. A convenient cloakroom completes the ground floor.

To the first floor there are Four Bedrooms (Three Doubles) and (One Single), with the master bedroom benefiting from a fitted wardrobe. Off the landing the Family bathroom is modern, with underfloor heating and housing a double vanity sink.

Externally the property has a large private front lawned garden with mature flower beds, and a footpath leading to off-street parking for several cars. We very highly recommend your earliest possible internal viewing to appreciate the space and secluded location.









Ground Floor

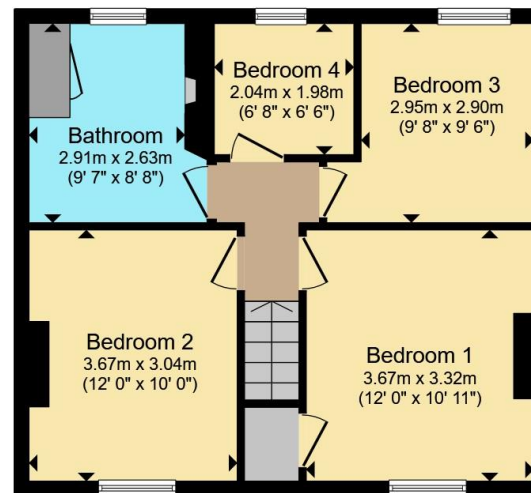

First Floor

Total floor area 113.5 m² (1,222 sq.ft.) approx

This floor plan is for illustrative purposes only. It is not drawn to scale. Any measurements, floor areas (including any total floor area), openings and orientation are approximate. No details are guaranteed, they cannot be relied upon for any purpose and they do not form part of any agreement. No liability is taken for any error, omission or misstatement. A party must rely upon its own inspection(s). Powered by www.propertybox.io



To view this property please contact Connells on

T 01342 717 727
E cophorne@connells.co.uk

4 Copthorne Bank
 COPTHORNE RH10 3QX

EPC Rating: C Council Tax Band: F

Tenure: Freehold

view this property online connells.co.uk/Property/COP404278



1. MONEY LAUNDERING REGULATIONS Intending purchasers will be asked to produce identification documentation at a later stage and we would ask for your co-operation in order that there will be no delay in agreeing the sale. 2. These particulars do not constitute part or all of an offer or contract. 3. The measurements indicated are supplied for guidance only and as such must be considered incorrect. Potential buyers are advised to recheck measurements before committing to any expense. 4. We have not tested any apparatus, equipment, fixtures, fittings or services and it is in the buyers interest to check the working condition of any appliances.

Connells Residential is registered in England and Wales under company number 1489613, Registered Office is Cumbria House, 16-20 Hockliffe Street, Leighton Buzzard, Bedfordshire, LU7 1GN. VAT Registration Number is 500 2481 05.

See all our properties at www.connells.co.uk | www.rightmove.co.uk | www.zoopla.co.uk

Property Ref: COP404278 - 0004