

HARRY CHARLES

Property Specialists



Chiswell Court, Watford, WD24 7PL

Price £180,000



**** NO UPPER CHAIN - WELL PRESENTED ONE BEDROOM GROUND FLOOR APARTMENT - COUNCIL TAX BAND C - LOUNGE/DINER - SEPARATE KITCHEN - APPROX 93 YEAR LEASE REMAINING - RE-FITTED SHOWER ROOM - DOUBLE BEDROOM **** A well-presented one bedroom ground floor apartment situated in this sought after private development with easy access to both Watford Junction station and Watford town centre. The property comprises a bright reception, modern kitchen, double bedroom and an attractive shower room. In order to avoid disappointment, please contact us without delay to arrange an early appointment to view.

- Modern Ground Floor Apartment
- Entrance Hall
- Kitchen
- Re-fitted Shower Room
- Off Road Parking
- Security Intercom Entrance
- Lounge/Diner
- Double Bedroom With Fitted Wardrobes
- Council Tax Band C
- No Upper Chain



Floor Plan

GROUND FLOOR
393 sq.ft. (36.6 sq.m.) approx.

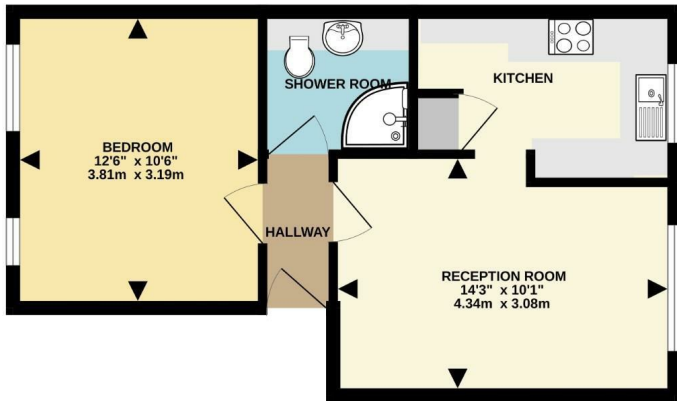

TOTAL FLOOR AREA: 393 sq.ft. (36.6 sq.m.) approx.
Whilst every attempt has been made to ensure the accuracy of the floorplan contained here, measurements of doors, windows, rooms and any other items are approximate and no responsibility is taken for any error, omission or misstatement. This plan is to be used for your own purposes only and should be used as such by any prospective purchaser. The services, systems and appliances shown have not been tested and no guarantee is given as to their operability or efficiency on the given date.
Made with Floorplan 12/2025

Area Map



Energy Efficiency Graph

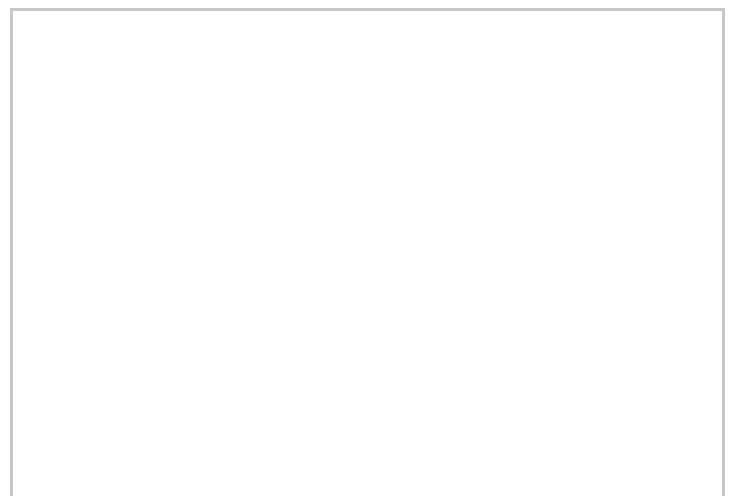
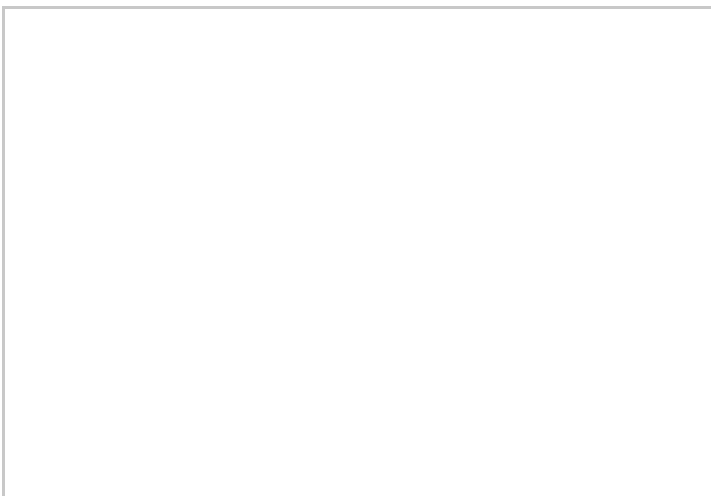
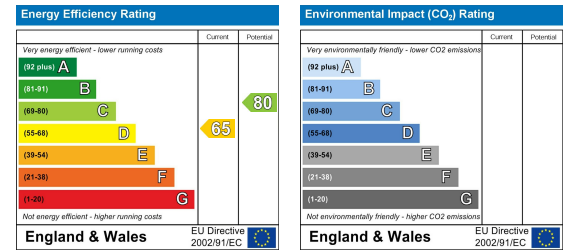

These particulars, whilst believed to be accurate are set out as a general outline only for guidance and do not constitute any part of an offer or contract. Intending purchasers should not rely on them as statements of representation of fact, but must satisfy themselves by inspection or otherwise as to their accuracy. No person in this firm's employment has the authority to make or give any representation or warranty in respect of the property.