



Rye Croft, BIRMINGHAM



Property Description

Experience Modern Living at Its Finest

Step into this beautifully renovated two-bedroom property, where modern elegance meets comfort. The ground floor features luxurious underfloor heating, complemented by a stylish, modern kitchen with breakfast bar, perfect for culinary adventures.

Upstairs, indulge in a spa-like experience with a walk-in shower complete with built-in speakers. The property boasts two generously sized bedrooms, offering ample space for relaxation.

The great rear garden is an entertainer's dream, ideal for hosting gatherings. Fully renovated and rewired throughout, this home is ready for you to move straight in. Don't miss this exceptional opportunity!

Entrance Porch

Lounge

double glazed window to front and underfloor heating

Kitchen

Kitchen comprising of a range of wall and base units sink and drainer oven with hob and extractor fan overhead. spotlights, breakfast bar, underfloor heating and french doors to rear.



Bedroom One

double glazed window to rear and radiator

Bedroom Two

double glazed window to front and radiator

Shower Room

Walk in shower, w/c, wash hand basin with vanity and light up mirror. Built in sound system and storage housing baxi boiler (two years old).

Front Garden

Tarmac and block paved garden, electric car charging point and side gate leading to rear garden.

Back Garden

patio, artificial lawn and electric outlet







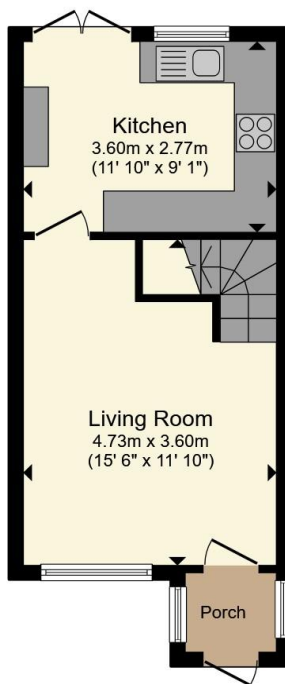

Ground Floor

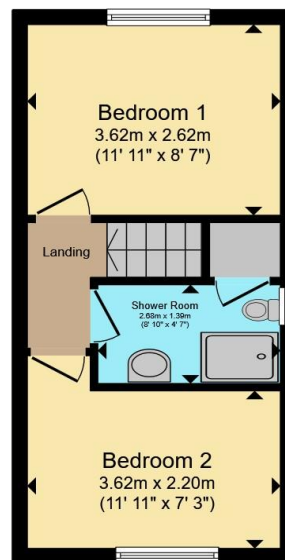

First Floor

Total floor area 56.4 m² (607 sq.ft.) approx

This floor plan is for illustrative purposes only. It is not drawn to scale. Any measurements, floor areas (including any total floor area), openings and orientation are approximate. No details are guaranteed, they cannot be relied upon for any purpose and they do not form part of any agreement. No liability is taken for any error, omission or misstatement. A party must rely upon its own inspection(s). Powered by www.propertybox.io



To view this property please contact Burchell Edwards on

T 0121 733 3553
E shirley@burchelledwards.co.uk

183 Stratford Road Shirley
 SOLIHULL B90 3AU

EPC Rating: D Council Tax
 Band: C

Tenure: Freehold

view this property online burchelledwards.co.uk/Property/SHI209185



1. MONEY LAUNDERING REGULATIONS Intending purchasers will be asked to produce identification documentation at a later stage and we would ask for your co-operation in order that there will be no delay in agreeing the sale. 2. These particulars do not constitute part or all of an offer or contract. 3. The measurements indicated are supplied for guidance only and as such must be considered incorrect. Potential buyers are advised to recheck measurements before committing to any expense. 4. We have not tested any apparatus, equipment, fixtures, fittings or services and it is in the buyers interest to check the working condition of any appliances.

Burchell Edwards is a trading name of Connells Residential which is registered in England and Wales under company number 1489613, Registered Office is Cumbria House, 16-20 Hockliffe Street, Leighton Buzzard, Bedfordshire, LU7 1GN. VAT Registration Number is 500 2481 05.

See all our properties at www.burchelledwards.co.uk | www.rightmove.co.uk | www.zoopla.co.uk

Property Ref: SHI209185 - 0004