

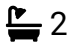

Lovatt Close, Edgware, HA8

Offers Over £815,000

 4  2  1

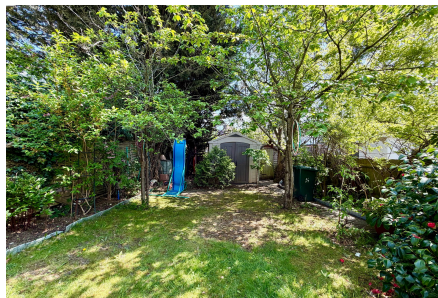

This extended and beautifully presented four-bedroom, two-bathroom semi-detached home is situated on the sought-after Lovatt Close in Edgware, HA8.

Upon entering, you are greeted by a bright and inviting atmosphere, leading into a large reception room. The kitchen is very spacious with direct access into the garage which is currently being used for storage and a utility room, there is also a guest WC.

Upstairs, you will find four generously proportioned bedrooms and two family bathrooms.

The property boasts a private driveway, offering convenient off-street parking and the garden provides a serene outdoor space.

The property offers easy access to Edgware Tube station and shops which is within walking distance.

Call Benjamin Stevens to view!

Key Features

- Four Bedrooms
- Large Kitchen
- Driveway Parking For 3 Cars
- Two Bathrooms
- Walking Distance To Shops/Transport Links
- Semi-Detached
- Spacious Living Room
- Private Rear Garden
- Great Location
- Ideal Family Home

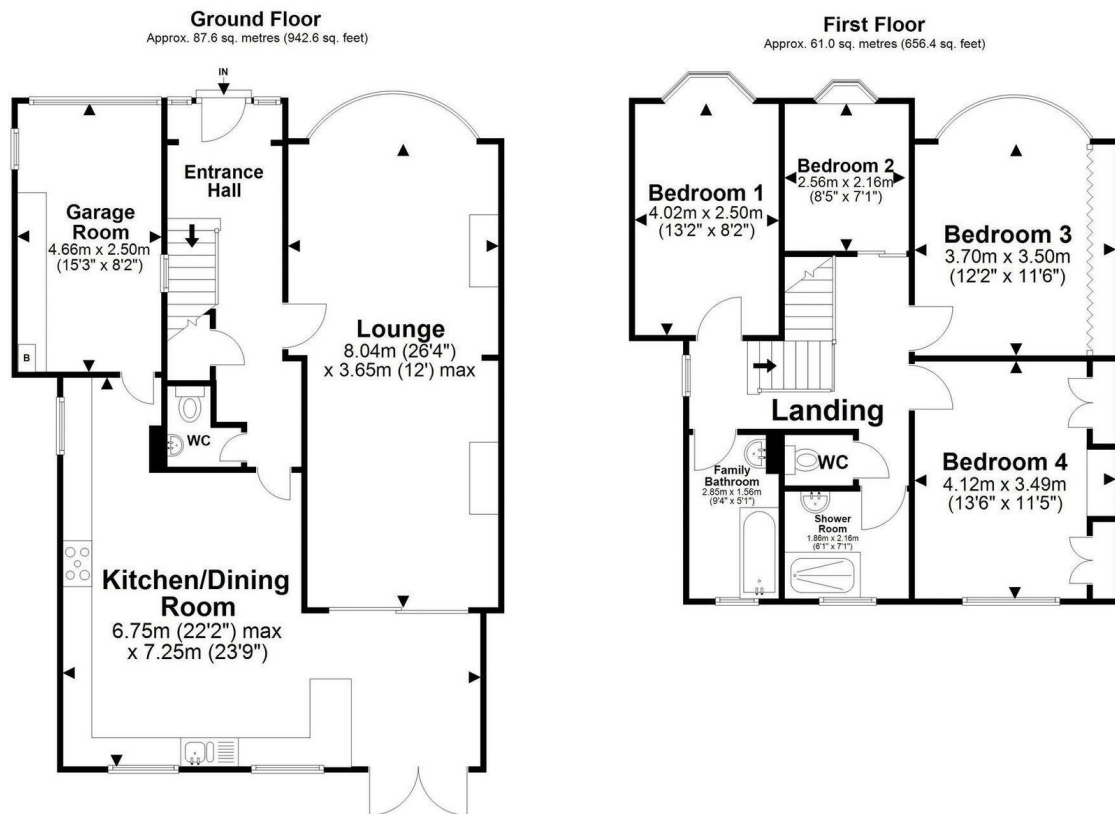

Total area: approx. 148.6 sq. metres (1599.1 sq. feet)

All images used are for illustrative purposes only. Floor plan are intended to give a general indication of proposed layout only. All images and dimensions do not form of any contract or warranty. For the exclusive use of Joseph Scott Estate Agents. Plan produced using PlanUp.
Plan produced using PlanUp.

Lovatt Close, Edgware, HA8 9XG