

Rounthwaite **R&W** Woodhead

53 MARKET PLACE, MALTON, NORTH YORKSHIRE, YO17 7LX Tel: (01653) 600747

25 BEVERLEY ROAD, NORTON, MALTON, YO17 9BQ



- Well appointed 2 bedroom terraced cottage
- Convenient location near amenities
- Good sized garden
- First time buyer opportunity

PRICE GUIDE £165,000

Also at: 26 Market Place, Kirkbymoorside Tel: (01751) 430034 & Market Place, Pickering Tel: (01751) 472800

Email: malton@rounthwaite-woodhead.co.uk www.rounthwaite-woodhead.com

Description

25 Beverly Road comprises a 2 bedroomed terraced cottage situated in a convenient location for amenities. The front of the property faces south and has a small forecourt garden. To the rear there is a good sized garden within fenced boundaries and rear access via a right of way. The accommodation with gas central heating briefly comprises sitting room kitchen diner 2 bedrooms and bathroom.

Beverley Road is a convenient location for local amenities including the Norton's primary school and local shopping on Commercial St. There is a local regular bus service and on street parking.

Other local amenities include the Railway Station with links to the intercity service at York, a variety of sporting and social clubs and an interesting and diverse range of shops.

General Information



Accommodation

Ground Floor

Approx. 34.2 sq. metres (368.1 sq. feet)

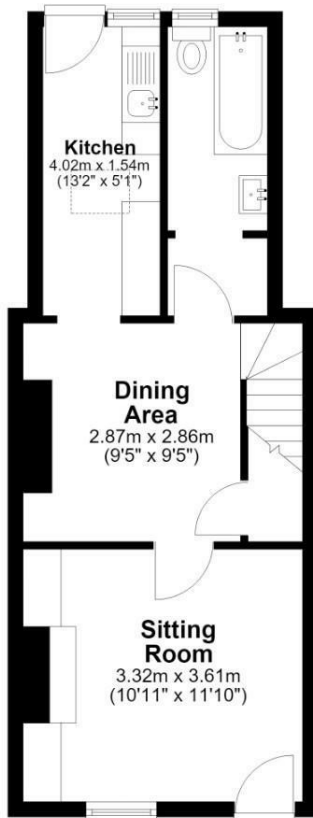

First Floor

Approx. 23.1 sq. metres (248.9 sq. feet)

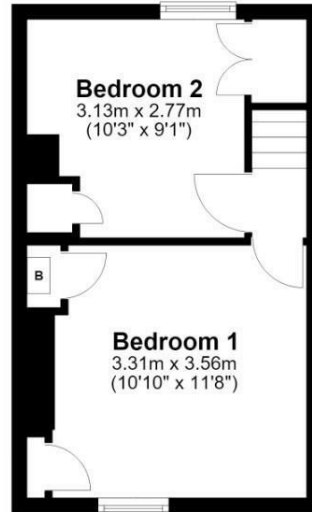

Total area: approx. 57.3 sq. metres (616.9 sq. feet)

25 Beverley Road, Norton

Energy Efficiency Rating		Current	Potential
Very energy efficient - lower running costs			
(92 plus) A			90
(81-91) B			
(69-80) C			
(55-68) D			
(39-54) E			
(21-38) F			
(1-20) G			
Not energy efficient - higher running costs			
England & Wales		EU Directive 2002/91/EC	

Environmental Impact (CO ₂) Rating		Current	Potential
Very environmentally friendly - lower CO ₂ emissions			
(92 plus) A			
(81-91) B			
(69-80) C			
(55-68) D			
(39-54) E			
(21-38) F			
(1-20) G			
Not environmentally friendly - higher CO ₂ emissions			
England & Wales		EU Directive 2002/91/EC	



Messrs Rounthwaite & Woodhead for themselves and their vendors and lessors whose agents they are give notice that these particulars are produced in good faith, set out as a general guide only and do not constitute any part of a contract. No person employed by Messrs Rounthwaite & Woodhead has any authority to make or give any representation or warranty whatsoever in relation to this property. The dimensions in the sales particulars are approximate only and the accuracy of any description cannot be guaranteed. Reference to machinery, services and electrical goods does not indicate that they are in good or working order. All reference to prices and rents etc. exclude VAT which may apply in some cases.

Covering Ryedale through offices in Malton, Pickering and Kirkbymoorside

www.rounthwaite-woodhead.com

Rounthwaite **R&W** Woodhead