



Marigolds, Deeping St. James, Peterborough
Guide Price £298,500 **Freehold**

**Sharman
Quinney**

Key Features



- Detached Home
- Four Bedrooms
- Separate Dining Room
- En Suite to Master Bedroom
- Cloakroom

Accommodation Includes

Front door to:

Entrance Hall

Radiator, understairs storage cupboard, window to side, stairs to first floor and landing.

Cloakroom

Fitted with a two piece suite comprising, wash hand basin and wc, window to side.

Lounge

4.85m x 3.56m (15'11" x 11'8"). Window to front aspect, living flame effect electric fire set in feature surround, radiator, double doors to:



Separate Dining Room

Radiator, patio doors to rear and garden.

Kitchen

4.62m x 2.51m (15'2" x 8'3"). Fitted with a range of base and eye level units with worktops over, sink, plumbing for washing machine, plumbing for dishwasher, space for fridge/freezer and cooker, radiator, window to rear door to side

Stairs to First Floor and Landing

Window to side, airing cupboard.

Bedroom One

4.04m x 2.64m (13'3" x 8'8"). Built in double wardrobe, window to front aspect, radiator, door to:

En Suite

Fitted with a three piece suite comprising shower cubicle, wash hand basin, wc, radiator.

Bedroom Two

3.66m x 2.64m (12' x 8'8"). Window to rear aspect, radiator, double wardrobe.

Bedroom Three

3.15m x 2.74m (10'4" x 9'). Window to front aspect, radiator.

Bedroom Four

2.77m x 2.24m (9'1" x 7'4"). Window to rear aspect, radiator, loft access.



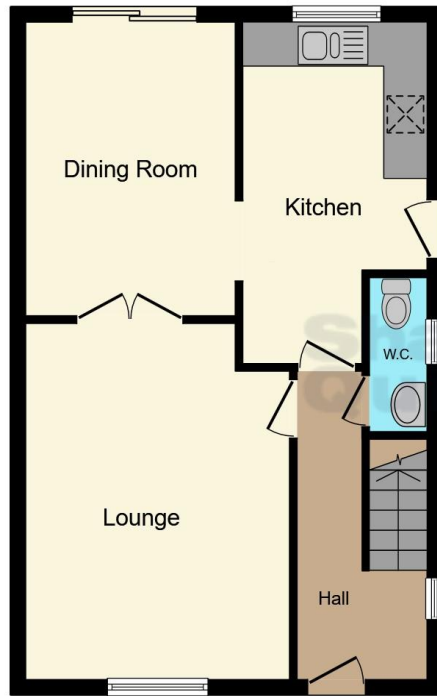

Ground Floor

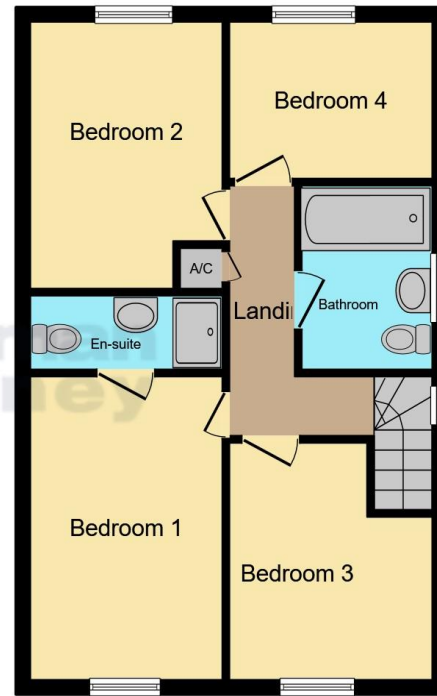

First Floor

This floor plan is for illustrative purposes only. It is not drawn to scale. Any measurements, floor areas (including any total floor area), openings and orientation are approximate. No details are guaranteed, they cannot be relied upon for any purpose and they do not form part of any agreement. No liability is taken for any error, omission or misstatement. A party must rely upon its own inspection(s). Powered by www.focalagent.com

Bathroom

Fitted with a three piece suite comprising panel bath with mixer tap shower, pedestal wash hand basin, wc, radiator, heated towel rail, window to side.

Outside

The rear garden is mainly laid to lawn with shrubs patio area and timber fence surround with side gate access. To the front the driveway is paved providing ample parking and leads to a single detached part converted garage with power and light connected, metal up and over door and additional side door leading to the rear garden.

To view this property call Sharman Quinney on:
01778 343322

Selling your property?

Contact us to arrange a **FREE** home valuation.

 01778 343322

 25 Market Place, Market Deeping,
PETERBOROUGH, Cambridgeshire, PE6 8EA

 marketdeeping@sharmanquinney.co.uk

 www.sharmanquinney.co.uk



 SCAN ME



Sharman Quinney Holdings Limited is registered in England and Wales under company number 4174227, Registered Office is Cumbria House, 16-20 Hockliffe Street, Leighton Buzzard, Bedfordshire, LU7 1GN. VAT Registration Number is 500 2481 05.

1: These particulars do not constitute part or all of an offer or contract. 2: The measurements indicated are supplied for guidance only and as such must be considered incorrect. 3: Potential buyers are advised to recheck the measurements before committing to any expense. 4: Sharman Quinney has not tested any apparatus, equipment, fixtures, fittings or services and it is the buyers interests to check the working condition of any appliances. 5: Sharman Quinney has not sought to verify the legal title of the property and buyers must obtain verification from their legal representative. 6: Intending purchasers will be asked to produce identification documentation at a later stage and we would ask your co-operation in order that there will be no delay in agreeing the sale. Ref: MRD204330 - 0010

