



Juniper Street, Perceton, Irvine

Offers Over £349,995





Ground Floor

Floor area 81.5 sq.m. (877 sq.ft.)

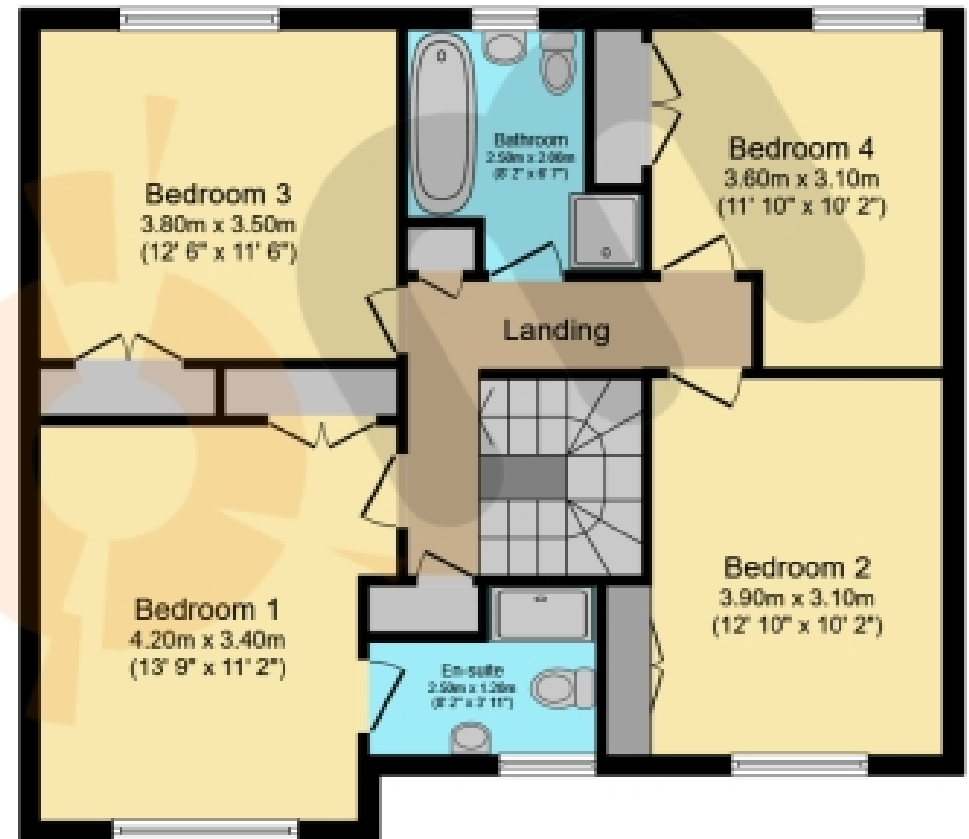

First Floor

Floor area 76.3 sq.m. (821 sq.ft.)

Total floor area: 157.8 sq.m. (1,698 sq.ft.)

This floor plan is for illustrative purposes only. It is not drawn to scale. Any measurements, floor areas (including any total floor area), openings and orientations are approximate. No details are guaranteed, they cannot be relied upon for any purpose and do not form any part of any agreement. No liability is taken for any error, omission or misstatement. A party must rely upon its own inspection(s). Powered by www.Propertybox.io

THE PROPERTY

This stunning family home makes an immediate impression from the moment you arrive. Externally, decorative stone chippings and a monoblock driveway with electric vehicle charging lead to the front entrance and into a bright and welcoming reception hallway. Inside, the contemporary décor is complimented by stylish oak-effect flooring, flowing seamlessly into the open-plan dining kitchen.

The ultra-modern kitchen is fitted with glossy wall and base mounted units, quartz worktops and a range of quality integrated appliances, including a fridge freezer, dishwasher, oven, gas hob, and extractor fan. Generous proportions provide ample space for a dining table or relaxed seating area, making it ideal for both everyday family living and entertaining, with stylish French doors opening to the rear garden. A practical utility room adjoins the kitchen, offering additional storage and direct access to both the rear garden and the integral garage.

Completing the ground floor is a stylish family lounge, decorated in soft neutral tones for a relaxing space to unwind. A pristine W.C. adds further convenience, elegant in all its simplicity.

Into the upper level are four generous double bedrooms with fantastic in-built storage solutions. Bedroom One boasts an en-suite shower room, adding a touch of luxury to everyday living. Completing the home internally is a family bathroom comprising a W.C., wash hand basin, bath, and a separate walk-in shower.

The beautifully landscaped rear garden offers a combination of patio and artificial lawn, creating a low-maintenance outdoor space perfect for the whole family to enjoy.

This property further gains from gas central heating and double glazing throughout.

Irvine is a picturesque town nestled along the west coast of Scotland, which exudes historical charm and natural beauty. Irvine is renowned for its rich maritime heritage, with the Irvine Harbour dating back to the 12th century. With access to a plethora of supermarkets, shops and eateries, this town has something for everyone.

Irvine offers convenient travel links, with easy access to Glasgow and other nearby towns and cities via the railway line, ensuring that you can seamlessly explore the stunning Ayrshire countryside or embark on exciting urban adventures.

Viewing by appointment - please contact The Property Boom to arrange a viewing or for any further information and a copy of the Home Report. Any areas, measurements or distances quoted are approximate and floor Plans are only for illustration purposes and are not to scale.

WOULD YOU LIKE A FREE DETAILED VALUATION OF YOUR OWN PROPERTY?

TAKE ADVANTAGE OF OUR DECADES OF EXPERIENCE AND GET YOUR FREE PROPERTY VALUATION FROM OUR FRIENDLY AND APPROACHABLE TEAM. WE CUT THROUGH THE JARGON AND GIVE YOU SOLID ADVICE ON HOW AND WHEN TO SELL YOUR PROPERTY.

THESE PARTICULARS ARE ISSUED IN GOOD FAITH BUT DO NOT CONSTITUTE REPRESENTATIONS OF FACT OR FORM PART OF ANY OFFER OR CONTRACT.

www.thepropertyboom.com
Head Office : 31 Braehead, Beith, KA15 1EG
Tel: 0333 900 9089 / Email: smile@thepropertyboom.com