



Prior Street, SE10

£1,100,000

An opportunity to acquire this beautifully presented two bedroom period family home that has been sympathetically restored and renovated to a high standard boasting period features throughout.

Located on one of West Greenwich's most sought after roads, within moments of Greenwich Royal Park and Greenwich mainline and DLR station providing easy access to Canary Wharf, the City and beyond. Royal Hill with its eclectic mix of independent shops, cafes, restaurants and pubs is a short stroll around the corner.

Features

Two Bedrooms
Sought After Location
Period Family Home
Immaculate Throughout
Downstairs W.C.
Good Size Garden

Prior Street,
London, SE10

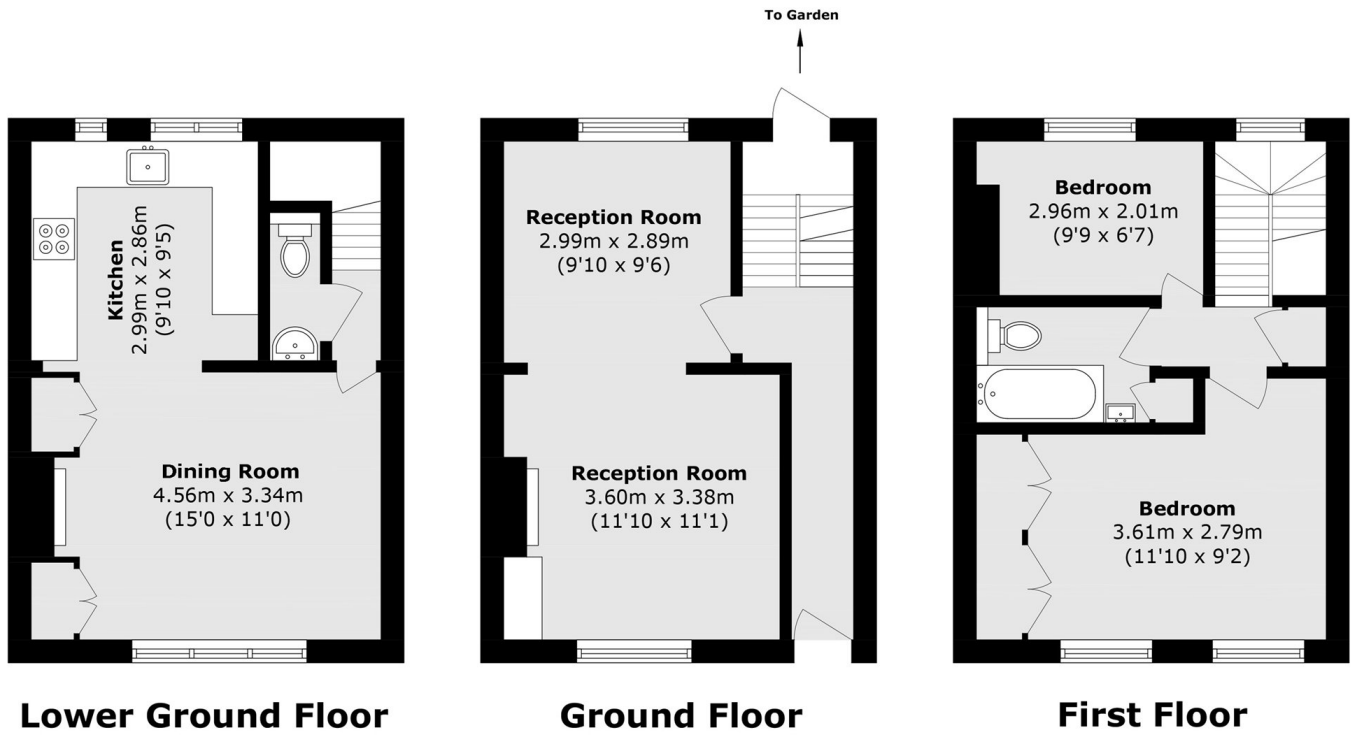

Total area (approx.): 88.9 sq. m (956.9 sq. ft)