

for sale

£285,000



Ogilvie Avenue Northampton NN2 7FQ

Set on a good size plot is this immaculately presented three bedroom family home, ideally located on the popular development of Scholar Green and set within close proximity to local schools and amenities. Viewing is highly advised to fully appreciate.



Ogilvie Avenue Northampton NN2 7FQ

Entrance Hall

Door to the front elevation with further doors leading off to the cloakroom and living room. Wall mounted radiator and stairs rising to the first floor landing.

Cloakroom

Modern white suite comprising low level flush w.c and wash hand basin with tiling to splash back area. Dado rail, wall mounted radiator and UPVC opaque double glazed window to the front elevation.

Living Room

UPVC double glazed window to the front elevation. Wall mounted radiator, under stairs cupboard and connecting door to the kitchen/dining room.

Kitchen/ Dining Room

Modern fitted kitchen with a range of wall and base level units. Stainless steel one and a half bowl sink and drainer with mixer tap over, set into work surfaces with complimentary up stands. Integrated appliances comprise dishwasher, washing machine, single electric oven and four ring gas hob with stainless steel splash back and extractor hood over. Space for upright fridge/freezer and dining table and chairs. UPVC double glazed window to the rear elevation and UPVC double glazed French door leading out to the rear garden and patio area.

First Floor Landing

Stairs rise from the entrance hall. Doors lead off to three bedrooms and the family bathroom. Linen cupboard and access to the loft space.

Master Bedroom

UPVC double glazed window to the front elevation. Over stairs storage cupboard, wall mounted radiator and connecting door to the en-suite shower room.

En-Suite Shower Room

Modern three piece white suite comprising shower cubicle, pedestal wash hand basin and low level flush w.c with complimentary tiling to splash back areas. Wall mounted radiator, extractor fan and UPVC opaque double glazed window to the front elevation.

Bedroom Two

UPVC double glazed window to the rear elevation and wall mounted radiator.

Bedroom Three/ Home Office

A work from home office/bedroom three with UPVC double glazed window to the rear elevation and wall mounted radiator.



Family Bathroom

Modern three piece white suite comprising panelled bath with shower over and glazed shower screen, pedestal wash hand basin and low level flush w.c, with complimentary tiling to splash back areas. Wall mounted radiator, extractor fan and UPVC opaque double glazed window to the side elevation.

Outside

Front Garden/ Driveway

Beautiful landscaped front garden which is mainly laid to lawn, with stone chipping's and shrub borders and pathway leading to the front door, with a convenient outside light. The driveway is set to the side and provides off road parking for several cars. There is an EV charger which is available by separate negotiations. Gated access leads to the spacious rear garden.

Rear Garden

Spacious rear garden which is mainly laid to lawn, with a paved patio area which is ideal for entertaining and alfresco dining. Timber shed, outside water tap, double external water proof electric socket, retaining timber fencing and gated access leading driveway at the side of the house.

Council Tax Band

C





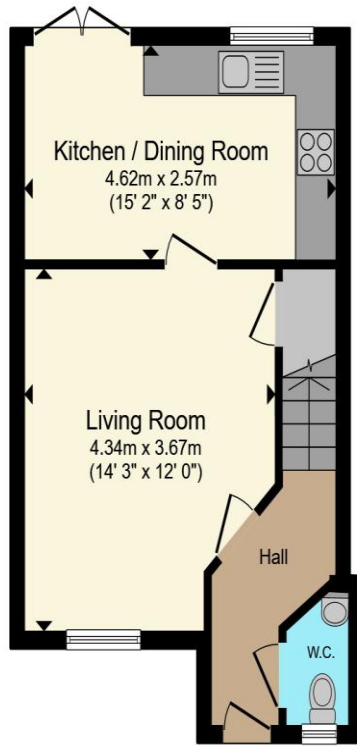

Ground Floor

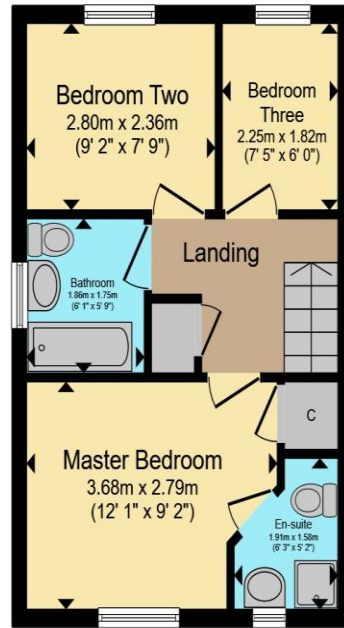

First Floor

Total floor area 67.1 m² (723 sq.ft.) approx

This floor plan is for illustrative purposes only. It is not drawn to scale. Any measurements, floor areas (including any total floor area), openings and orientation are approximate. No details are guaranteed, they cannot be relied upon for any purpose and they do not form part of any agreement. No liability is taken for any error, omission or misstatement. A party must rely upon its own inspection(s). Powered by www.propertybox.io



To view this property please contact Connells on

T 01604 716 655
E kingsthorpe@connells.co.uk

87 Harborough Road KINGSTHORPE
 NORTHAMPTON NN2 7SL

Property Ref: KTP408254 - 0003

Tenure:Freehold EPC Rating: B

Council Tax Band: C

view this property online [connells.co.uk/Property/KTP408254](https://www.connells.co.uk/Property/KTP408254)



1. MONEY LAUNDERING REGULATIONS Intending purchasers will be asked to produce identification documentation at a later stage and we would ask for your co-operation in order that there will be no delay in agreeing the sale. 2. These particulars do not constitute part or all of an offer or contract. 3. The measurements indicated are supplied for guidance only and as such must be considered incorrect. Potential buyers are advised to recheck measurements before committing to any expense. 4. We have not tested any apparatus, equipment, fixtures, fittings or services and it is in the buyers interest to check the working condition of any appliances.

Connells Residential is registered in England and Wales under company number 1489613, Registered Office is Cumbria House, 16-20 Hockliffe Street, Leighton Buzzard, Bedfordshire, LU7 1GN. VAT Registration Number is 500 2481 05.

see all our properties at www.connells.co.uk | www.rightmove.co.uk | www.zoopla.co.uk