

Prospect House, 3a St Thomas Place, Ely,
Cambs., CB7 4EX
01353 665020 | lettings@clarkhomes.co.uk
clarkhomes.co.uk

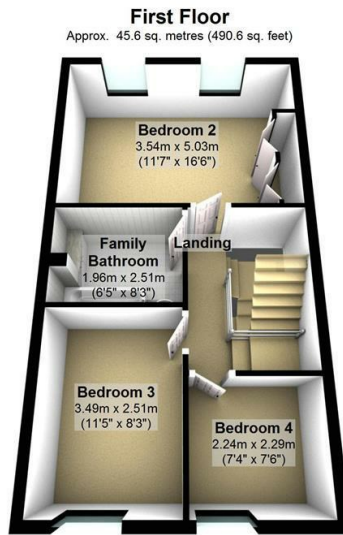

2 Little London Gardens, Ely, CB6 1BF
£1,695 PCM

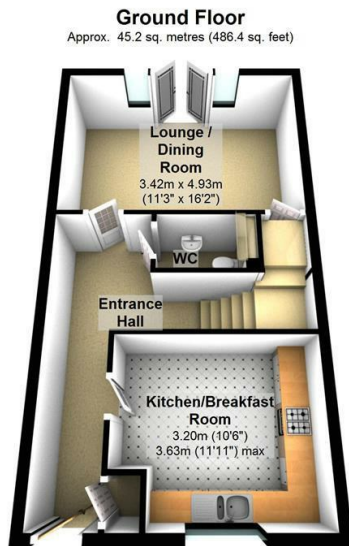



Total area: approx. 120.2 sq. metres (1293.5 sq. feet)



A stylish modern townhouse on this exclusive small development within walking distance of central Ely. Accommodation of entrance hall with wooden floors, cloaks/WC, fitted Italian designed kitchen / dining with oven, hob & dishwasher and windows to front, tiles floor. Bright and airy living room with French doors to beautiful courtyard garden, To the first floor there are 3 bedrooms (one with built in wardrobes). Family bathroom with wc, basin and bath with shower over. To the top floor, a generous principle bedroom offers built in wardrobes and an en suite shower. Gas-fired heating and PVCu sash style windows. Enclosed rear courtyard garden. 2 Car parking spaces. Council tax D EPC C

Directions to the property using What3Words.
Enter the link in your browser then click on
Waze or Google Maps:

P1029

Energy Efficiency Rating		Environmental Impact (CO ₂) Rating	
Current	Potential	Current	Potential
80	89	84	85
Very energy efficient - lower running costs (92 plus) A (81-91) B (69-80) C (55-68) D (39-54) E (21-38) F (1-20) G Not energy efficient - higher running costs		Very environmentally friendly - lower CO ₂ emissions (92 plus) A (81-91) B (69-80) C (55-68) D (39-54) E (21-38) F (1-20) G Not environmentally friendly - higher CO ₂ emissions	
England & Wales EU Directive 2002/91/EC		England & Wales EU Directive 2002/91/EC	

These particulars, whilst believed to be accurate are set out as a general outline only for guidance and do not constitute any part of an offer or contract. Intending purchasers should not rely on them as statements of representation of fact, but must satisfy themselves by inspection or otherwise as to their accuracy. No person in this firm's employment has the authority to make or give any representation or warranty in respect of the property.