



CROSSHARBOUR PLAZA, E14

£525,000

A one bedroom property on the twentieth floor of the sought after Arena Tower. This apartment consists of an open plan kitchen/reception with integrated SMEG appliances, floor-to-ceiling windows and access to a large private balcony, a spacious double bedroom, and a family bathroom.

- One Double Bedroom
- Private Balcony
- 24 Hour Concierge
- Gym
- Swimming Pool
- Underfloor Heating

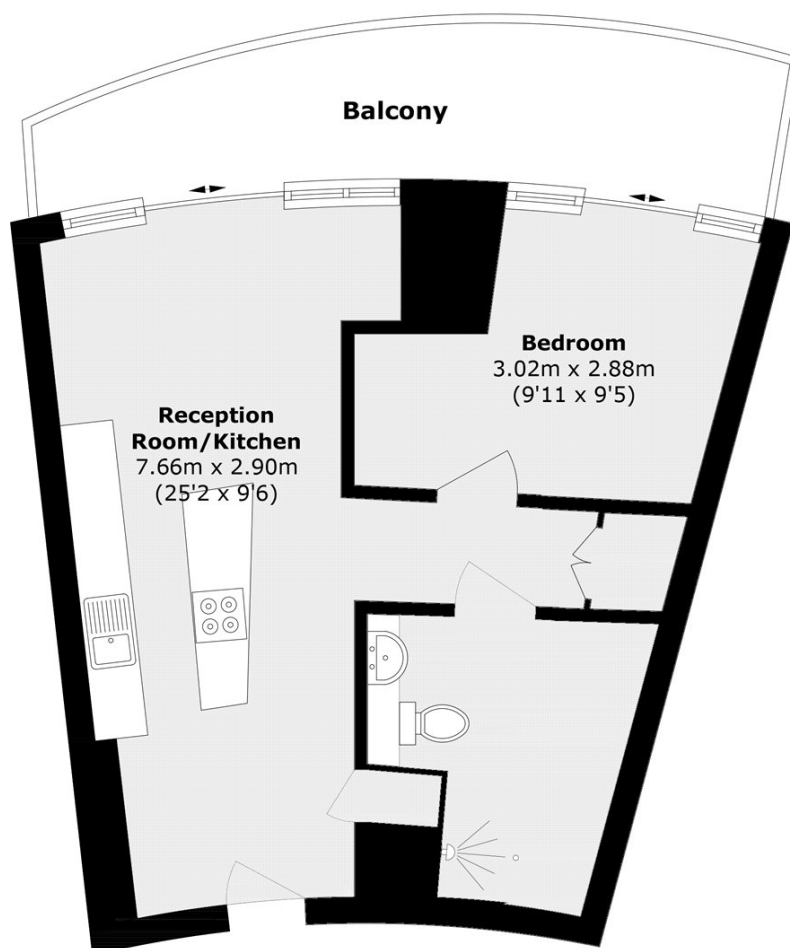

Total area (approx.): 52.0 sq. m (559.7 sq. ft)
Balcony area (approx.): 15.5 sq. m (166.8 sq. ft)

LiFE RESIDENTIAL

36 Millharbour, London, E14

9JS

Sales: 020 3668 1033

Lettings: 020 3668 1030

Energy Rating: B. We aim to make our particulars both accurate and reliable. However they are not guaranteed; nor do they form part of an offer or contract. If you require clarification on any points then please contact us, especially if you're traveling some distance to view. Please note that appliances and heating systems have not been tested and therefore no warranties can be given as to their good working order.