

Kilburn Lane, W10

£320,000

This well-presented one bedroom flat is situated on the second floor of a well-maintained building. The property features a spacious reception room, a modern fitted kitchen, a generously sized bedroom and a fully tiled bathroom. An ideal first home or investment opportunity.

Epcot Court is located close to the shops, cafés and amenities of Chamberlayne Road, with Salusbury Road also nearby. Kensal Green Station is within easy reach, providing Bakerloo Line and Lioness Line services into Central London.

Features

- One Bedroom
- Second Floor Flat
- Separate Kitchen
- Leasehold
- Prime Kensal Rise
- Chain Free

Kilburn Lane, London, W10

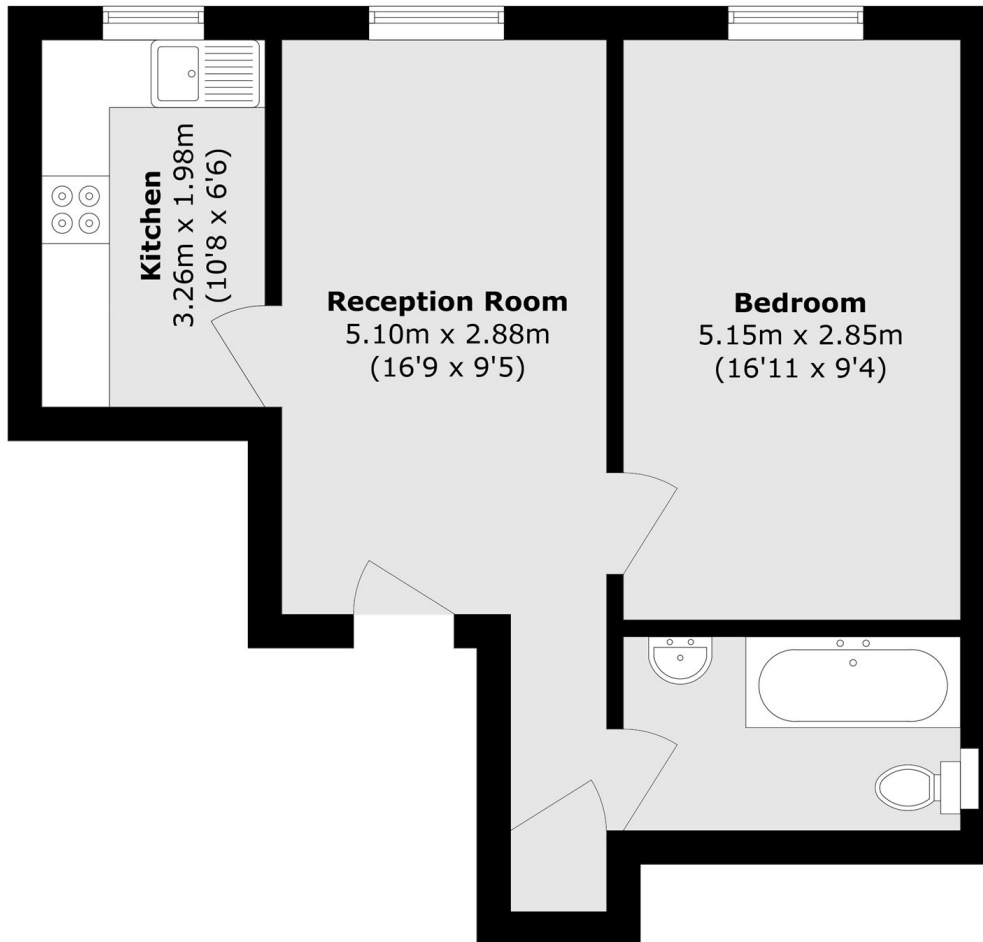

Total area (approx.): 45.9 sq. m (494.0 sq. ft)