



12 Douglas Drive, Ormskirk

Ormskirk

Guide Price £225,000

12 Douglas Drive

Ormskirk

Well-maintained three-bedroom semi-detached home with driveway, garage, utility, and exceptional rear garden. No onward chain. Sought-after location near schools and amenities.

Council Tax band: C

Tenure: Freehold

- Three-bedroom semi-detached home
- Entrance hallway with understairs storage
- Spacious lounge with marble-effect fireplace and living flame gas fire
- Extended dining room with picture window overlooking the rear garden
- Exceptional mature rear garden with patio, greenhouse, timber shed and vegetable patch
- Well maintained throughout with scope for cosmetic modernisation





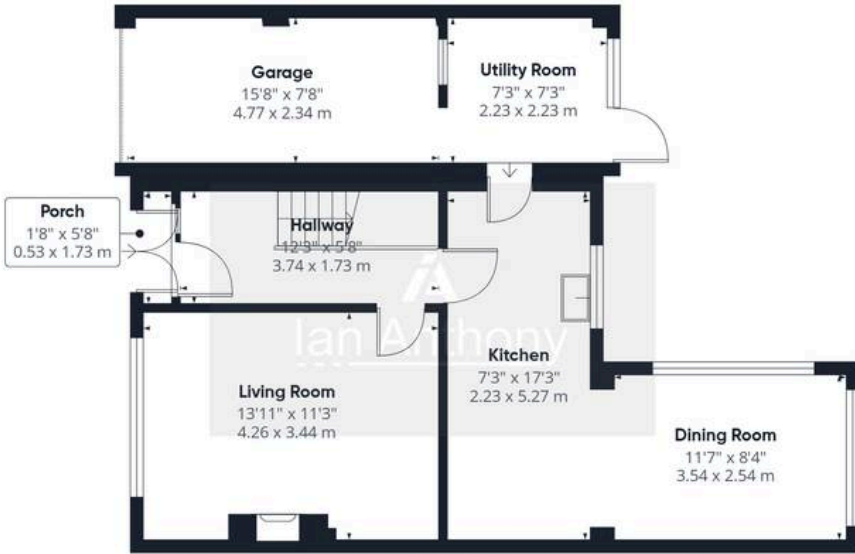

Ground Floor Building 1



Floor 1 Building 1



Ground Floor Building 2

Approximate total area⁽¹⁾

1064 ft²

98.8 m²

(1) Excluding balconies and terraces

Calculations reference the RICS IPMS 3C standard. Measurements are approximate and not to scale. This floor plan is intended for illustration only.

GIRAFFE360



IAN ANTHONY

5 Burscough Street, Ormskirk - L39 2EG

01695580888

enquiries@iananthonyestates.co.uk

iananthonyestates.co.uk/

