



OFFERS IN REGION OF £125,000
42 GORDON STREET, SCARBOROUGH, YO12 7RX

- Terraced House
- Two Bedrooms
- Convenient Location
- Ideal Starter Home

A PERFECT STARTER HOME ON THIS EVER-POPULAR STREET WITH ALL OF THE TOWN CENTRES AMENITIES A SHORT WALK AWAY INCLUDING THE RAILWAY STATION. IN NEED OF SOME UPDATING AND MODERNISATION THIS PROPERTY WILL MAKE A GREAT HOME, WITH THE ADDED BONUS OF A BOARDED LOFT ROOM WITH SPACE SAVING STAIRCASE TO ACCESS.



TIPPLE UNDERWOOD ESTATE
AGENTS
3 Coldyhill Lane, Scarborough, North
Yorkshire, YO12 6SF

CONTACT
www.tippleunderwood.co.uk
01723 350299
mail@tippleunderwood.co.uk

Agents Note: Whilst every care has been taken to prepare these sales particulars, they are for guidance purposes only. All measurements are approximate and for general guidance purposes only and whilst every care has been taken to ensure their accuracy, they should not be relied upon and potential buyers are advised to recheck the measurements.



TOTAL FLOOR AREA: 1205 sq.ft. (112.0 sq.m.) approx.
 Whilst every attempt has been made to ensure the accuracy of the floorplan contained here, measurements of doors, windows, rooms and any other items are approximate and no responsibility is taken for any error, omission or mis-statement. This plan is for illustrative purposes only and should be used as such by any prospective purchaser. The services, systems and appliances shown have not been tested and no guarantee as to their operability or efficiency can be given.
 Made with Metropix ©2025



Property Description

This two-bedroom mid terraced house offers bags of potential and when briefly described comprises entrance lobby, hallway, bay fronted lounge, rear facing dining room kitchen and utility room to the ground floor. On the first floor are two well-appointed bedrooms, family bathroom and an attached dressing room. Space saving staircase to the superb loft room. Enclosed yard to the rear.

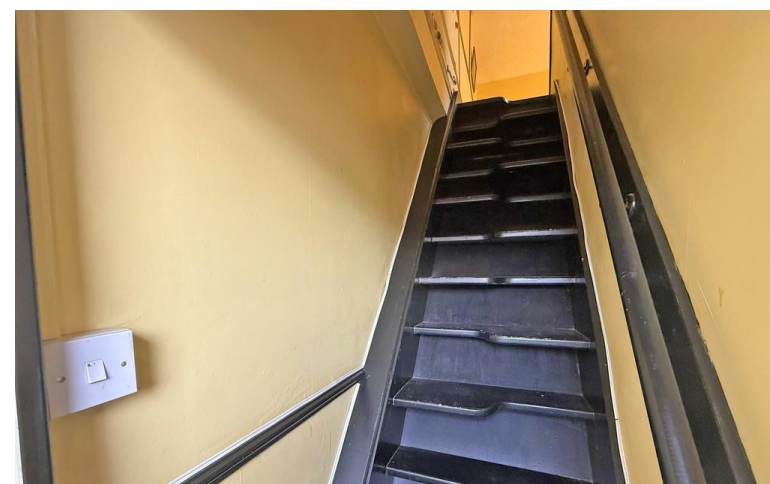

GROUND FLOOR

- ENTRANCE HALL
- HALLWAY
- LOUNGE
13' 5" x 12' (4.09m x 3.66m)
- DINING ROOM
12' 10" x 12' 4" (3.91m x 3.76m)
- KITCHEN
13' 10" x 7' 10" (4.22m x 2.39m)
- UTILITY ROOM
5' 11" x 5' 2" (1.8m x 1.57m)

FIRST FLOOR

- LANDING
- BEDROOM
15' 1" x 11' 3" (4.6m x 3.43m)
- BEDROOM
13' x 9' 7" (3.96m x 2.92m)
- BATHROOM
- DRESSING ROOM

SECOND FLOOR

- LOFT ROOM
13' 1" x 12' 5" (3.99m x 3.78m)

OUTSIDE

- REAR YARD