



**63 CLAYTON ROAD
CHESSINGTON
KT9 1NQ
£415,000**

EXTENDED VICTORIAN SEMI DETACHED HOUSE

TWO/THREE BEDROOMS

13'2 X 12'4 LIVING ROOM

12'4 X 10'2 MODERN KITCHEN DINING ROOM

15'5 X 7'5 THIRD BEDROOM/RECEPTION ROOM

MODERN GROUND FLOOR SHOWER ROOM

DOUBLE GLAZED WINDOWS

GAS CENTRAL HEATING

COURTYARD GARDEN

WELL PRESENTED

AN IDEAL FIRST TIME BUY

Ground Floor
41.6 sq.m. (448 sq.ft.) approx.

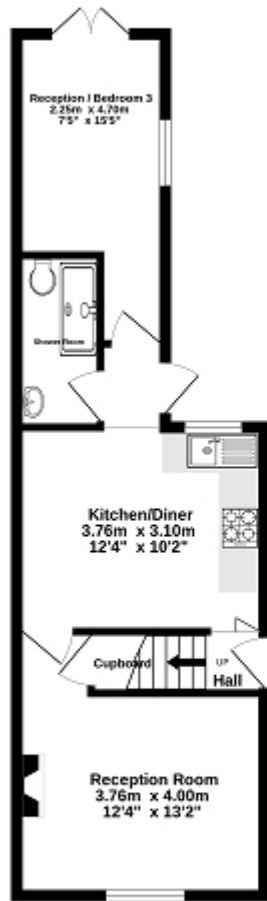

1st Floor
28.1 sq.m. (302 sq.ft.) approx.

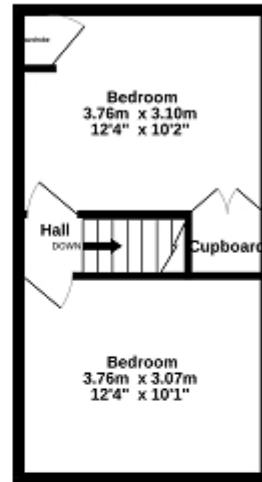

TOTAL FLOOR AREA : 69.7 sq.m. (750 sq.ft.) approx.

While every attempt has been made to ensure the accuracy of the floorplan contained here, measurements of doors, windows, rooms and any other items are approximate and no responsibility is taken for any error, omission or mis-statement. This plan is for illustrative purposes only and should be used as such by any prospective purchaser. The services, systems and appliances shown have not been tested and no guarantee as to their operability or efficiency can be given.
Made with Metaplan 02026

