

the floorplan...

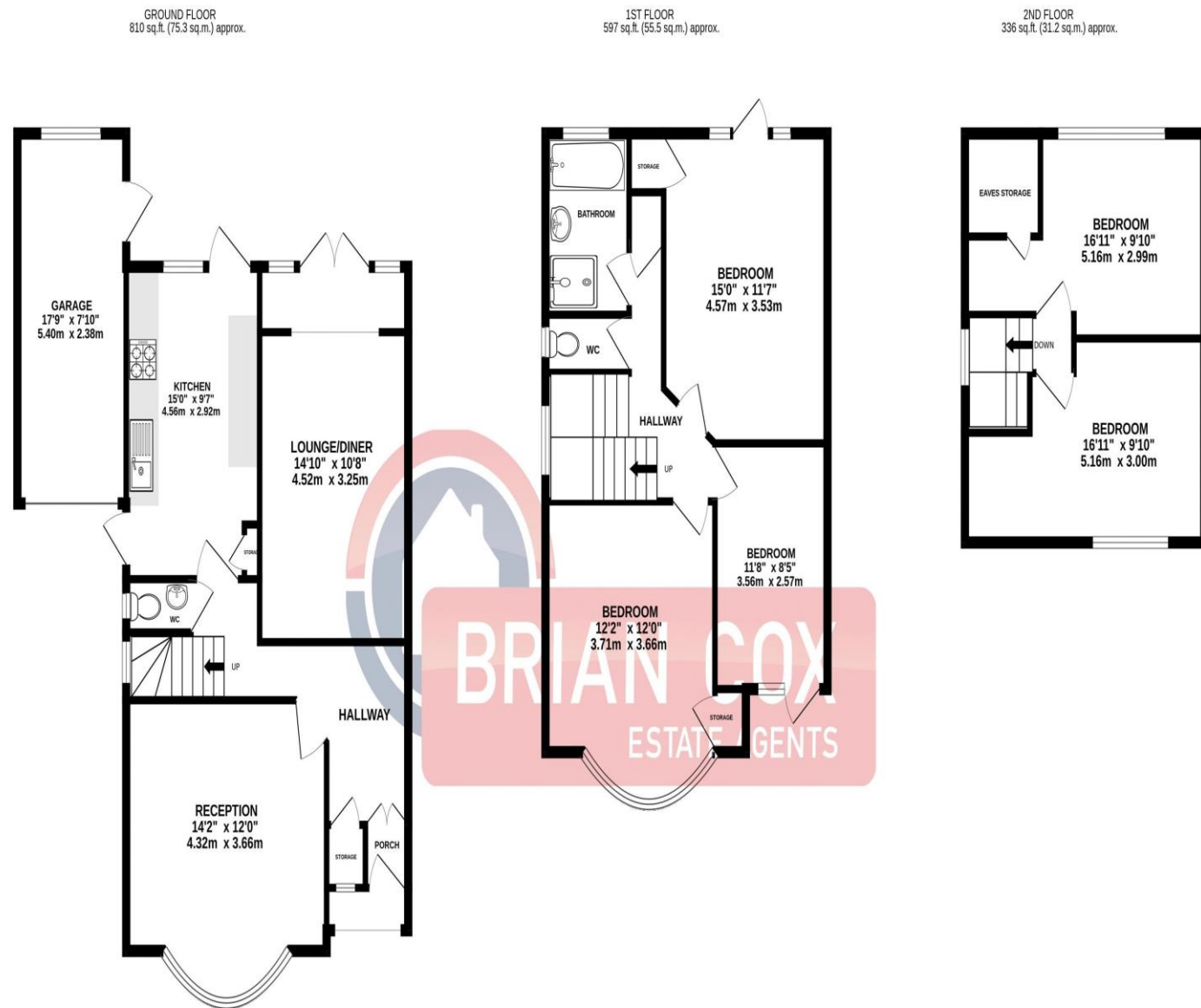

TOTAL FLOOR AREA: 1743 sq.ft. (162.0 sq.m.) approx.

Whilst every attempt has been made to ensure the accuracy of the floorplan contained here, measurements of doors, windows, rooms and any other items are approximate and no responsibility is taken for any error, omission or mis-statement. This plan is for illustrative purposes only and should be used as such by any prospective purchaser. The services, systems and appliances shown have not been tested and no guarantee as to their operability or efficiency can be given.
Made with Metropix ©2026

more details from...

call: **Brian Cox Greenford: 0208 912 0006**
 email: info@brian-cox.co.uk
 web: www.brian-cox.co.uk



Consumer Protection from Unfair Trading Regulations 2008 We have not tested any apparatus, equipment, fixtures, fittings or services and so cannot verify that they are in working order or fit for purpose. You are advised to obtain verification from your solicitor or surveyor. References to the tenure of a property are based on information supplied by the seller. We have not had sight of the title documents and a buyer is advised to obtain verification from their solicitor. Items shown in photographs are not included unless specifically mentioned within the sales particulars, but may be available by separate negotiation. We advise you to book an appointment to view before embarking on any journey to see a property, and check its availability.



0208 912 0006
brian-cox.co.uk



Situated on the ever-popular Whitmore Road in Harrow this substantial extended five-bedroom semi-detached family home offers generous living space throughout and presents further potential to extend (STPP). The ground floor comprises a welcoming entrance hall, two spacious reception rooms ideal for both family living and entertaining, a convenient downstairs w/c, and a good-sized kitchen with ample space for dining and everyday use. To the first floor, the property features three well-proportioned bedrooms, a family bathroom with shower, and a separate w/c. The second floor hosts two additional bedrooms within the loft conversion. The rear bedroom enjoys pleasant views overlooking West Harrow Park, while the front bedroom benefits from a dormer window, creating a bright and comfortable space. Externally, the property offers a large rear garden, perfect for families and outdoor entertaining, as well as a garage to the side and off-street parking to the front. Additional benefits include ample storage throughout, gas central heating, double glazing, and the property is offered to the market with no onward chain. This is a fantastic opportunity to acquire a spacious family home in a highly sought-after residential location, so call NOW to arrange your viewing today!!!



Offers Over £925,000
 Freehold

Whitmore Road, Harrow, HA1 4AQ



in brief...

- Five Bedrooms
- Semi-Detached Freehold Family Home
- Extended to the Rear & Loft
- Chain Free
- Potential To Extend (STPP)
- Sought After Location



the location...

nearest stations ...

- West Harrow (0.4 miles)
- Harrow-on-the-Hill (0.5 miles)
- South Harrow (0.8 miles)

Harrow is a large suburban town in the London Borough of Harrow, northwest London, England. It is centred 10.5 miles (16.9 km) northwest of Charing Cross. Harrow is home to a large University of Westminster campus, and its oldest secondary schools are Harrow School and Harrow High School.

Harrow forms a commercial hub in northwest London, including a well-connected town centre containing: two shopping centres, Parades of shops throughout Station Road and the ascending, traditional College Road, over 300m of fully pedestrianised shopping/cafe streets (north of St Ann's) There are three train stations in the area which are West Harrow (Metropolitan Line), South Harrow (Piccadilly Line) and Harrow on the Hill (Metropolitan Line). Bus routes are in abundance with a stop less than 30 seconds walk away which will take you to Harrow on the Hill station, South Harrow station, Watford, Edgware and Wembley to name a few destinations.

There are many local schools in the area some of these include Whitmore High School, The London Tuition Centre, Harrow School (boys public school) and Earlsmead Primary School.