



Fyfield Road, Enfield, EN1 3TT

welcome to
Fyfield Road, Enfield

This delightful Edwardian Character conversion is situated within the heart of Enfield Town, just minutes from Enfield Town Rail Station (Liverpool Street Line), shops, pubs, restaurants, The Dugdale Theatre and is within easy access of the A10 with its retail parks and the M25 Motorway, this delightful Edwardian Character Conversion has an abundance of character and is modernised throughout with many pleasing features.



Entrance Hall

Solid wood floor, radiator, large understairs storage cupboard.

Lounge

14' 6" into bay x 12' 8" max (4.42m into bay x 3.86m max)

Solid wood floor, double radiator, coving to ceiling, double glazed sash windows to bay.

Kitchen

10' x 10' (3.05m x 3.05m)

Solid wood floor, range of gloss white base and wall cupboards with single bowl sink unit integrated to contrasting composite worksurface and drainer, integrated dishwasher and fridge-freezer, larder cupboard, plumbing for washing machine, coving to ceiling, double doors to rear to west facing rear garden.

Bedroom One

10' 11" x 10' 10" (3.33m x 3.30m)

Fitted carpet, coving to ceiling, double radiator.

Bedroom Two

8' 9" x 8' 2" (2.67m x 2.49m)

Fitted carpet, coving to ceiling, double radiator, cupboard housing wall mounted gas central heating boiler.

Bathroom

Comprises panelled bath with mixer tap and shower attachment, glass shower screen, vanity basin with cupboard under, low flush WC with concealed cistern, frosted window to side, airing cupboard, heated towel rail, storage cupboard.

Outside

Front Garden

Attractively paved path, hedge screen.

West Facing Rear Garden

Stone paved patio, rear pedestrian access, laid to lawn, tap, raised beds.

Summerhouse / Bar

12' 4" x 9' 2" (3.76m x 2.79m)

Power and light, wi-fi, fully insulated and soundproofed.



view this property online barnfields.co.uk/Property/ENF103723







welcome to

Fyfield Road, Enfield

- 120 Year Lease Remaining
- Sash Double Glazing
- Minutes From Enfield Town
- Own West Facing Rear Garden
- Garden Office/Summer House

Tenure: Leasehold EPC Rating: Awaiting

Service Charge: Ask Agent

Ground Rent: 200.00

This is a Leasehold property with details as follows; Term of Lease 189 years from 24 Jun 1976. Should you require further information please contact the branch. Please Note additional fees could be incurred for items such as Leasehold packs.

£450,000



Please note the marker reflects the postcode not the actual property

check out more properties at barnfields.co.uk



Property Ref:
ENF103723 - 0002

1. MONEY LAUNDERING REGULATIONS Intending purchasers will be asked to produce identification documentation at a later stage and we would ask for your co-operation in order that there is no delay in agreeing the sale. 2. These particulars do not constitute part or all of an offer or contract. 3. The measurements indicated are supplied for guidance only and as such must be considered incorrect. Potential buyers are advised to recheck measurements before committing to any expense. 4. We have not tested any apparatus, equipment, fixtures or services and it is in the buyers interest to check the working condition of any appliances. 5. Where an EPC, or a Home Report (Scotland only) is held for this property, it is available for inspection at the branch by appointment. If you require a printed version of a Home Report, you will need to pay a reasonable production charge reflecting printing and other costs. 6. We are not able to offer an opinion either written or verbal on the content of these reports and this must be obtained from your legal representative. 7. Whilst we take care in preparing these reports, a buyer should ensure that his/her legal representative confirms as soon as possible all matters relating to title including the extent and boundaries of the property and other important matters before exchange of contracts.

Barnfields is a trading name of Sequence (UK) Limited which is registered in England and Wales under company number 4268443, Registered Office is Cumbria House, 16-20 Hockliffe Street, Leighton Buzzard, Bedfordshire, LU7 1GN. VAT Registration Number is 500 2481 05.

Fyfield Road, Enfield, EN1

Approximate Area = 670 sq ft / 62.2 sq m
Outbuilding = 113 sq ft / 10.4 sq m
Total = 783 sq ft / 72.6 sq m
For identification only - Not to scale

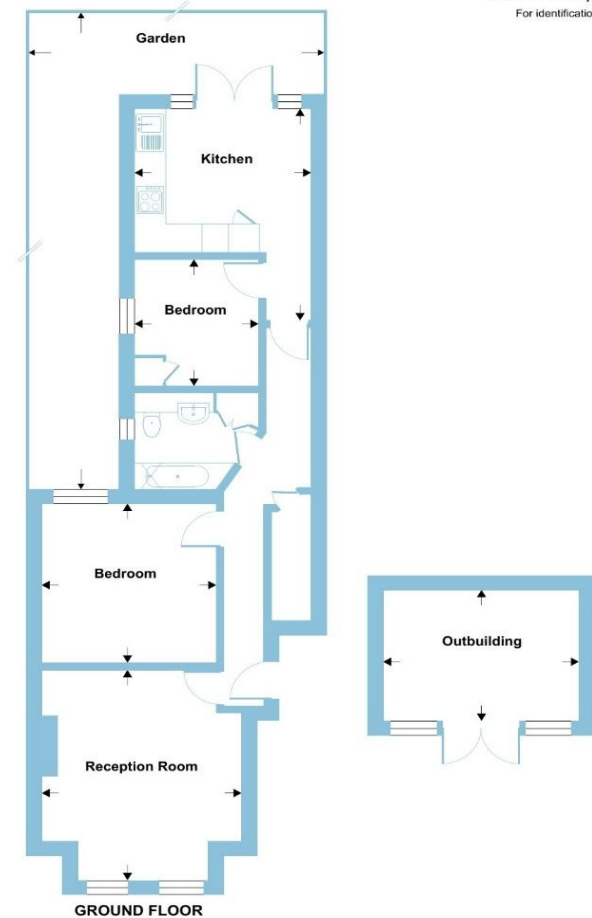

Floor plan produced in accordance with RICS Property Measurement 2nd Edition, Incorporating International Property Measurement Standards (IPMS2 Residential). © nichcom 2025. Produced for Barnard Marcus. REF: 1388890



020 8363 3394



info@barnfields.com



1a Windmill Hill, Enfield, Middlesex, EN2 6SE



barnfields.co.uk