



## KEBLE STREET, SW17

£900,000

- Victorian freehold house
- Three double bedrooms
- Generous private garden
- End of terrace
- Two bathrooms
- Energy rating: D





## ABOUT THE HOME

A Victorian, end of terrace house with an impressive open plan kitchen and a generous secluded garden.

Accommodation comprises; a bright reception room, generous and beautifully presented modern kitchen open plan to a dining/second reception area. This room is a true centrepiece offering ample storage, stylish flooring and double doors that lead onto a large landscaped sunny garden. On the first floor there are two well-proportioned double bedrooms and a family bathroom with stairs leading to the second floor boasting the spacious principle bedroom and well designed en suite bathroom. The property has been decorated to a high standard throughout whilst retaining many period features.

Keble Street is a highly desirable residential street with easy access to both Earlsfield mainline railway station and Tooting Broadway underground station. A plethora of trendy restaurants, bars, leisure and shopping facilities are also within walking distance for a vibrant lifestyle.





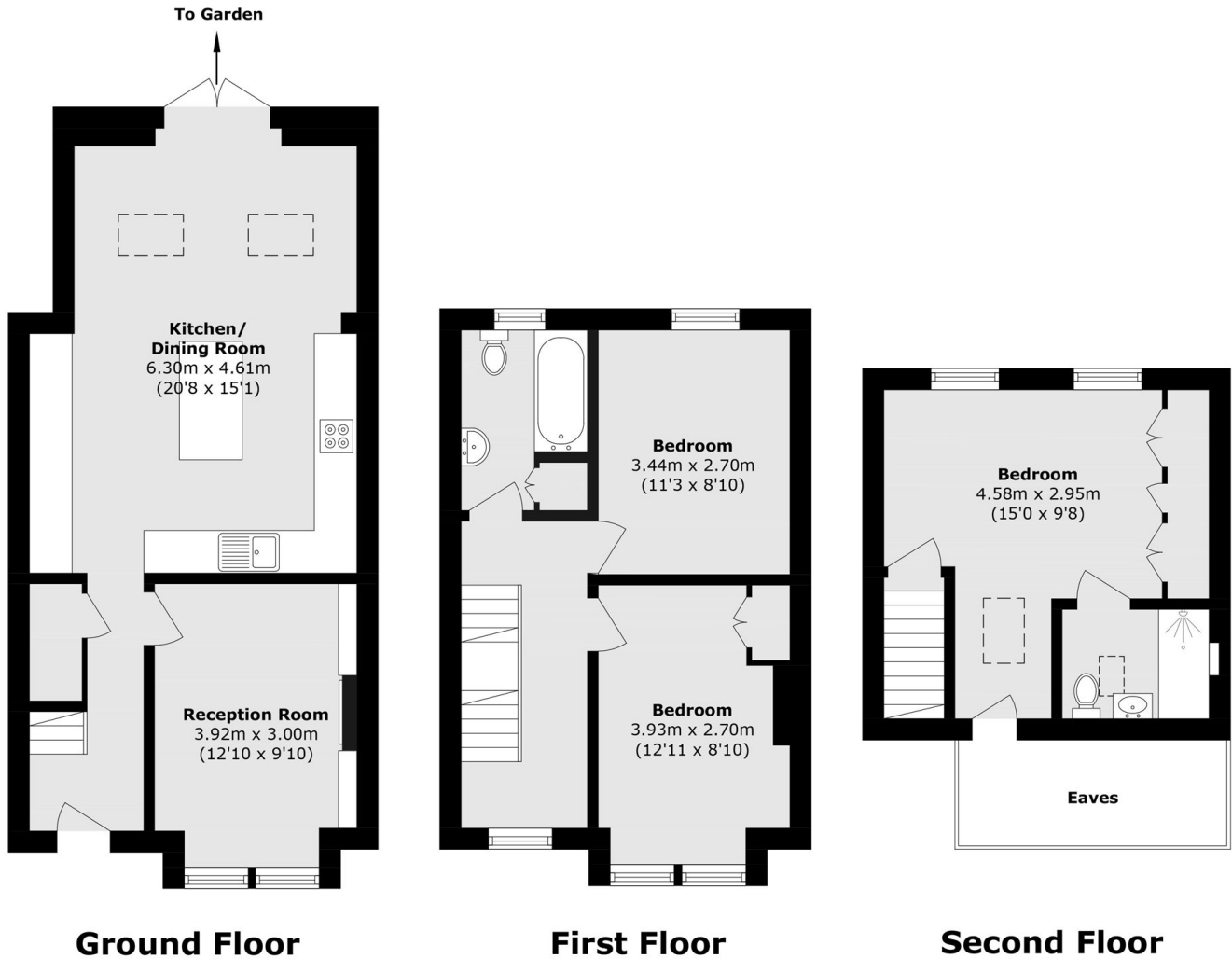

Total area (approx.): 99.3 sq. m (1068.8 sq. ft)  
(Excluding Eaves)

#### JACKSONS EARLSFIELD

372-374 Garratt Lane,  
Earlsfield, London, SW18 4ES  
Sales: 020 8971 7979  
Lettings: 020 8971 7070

Energy Rating: D We aim to make our particulars both accurate and reliable. However they are not guaranteed; nor do they form part of an offer or contract. If you require clarification on any points then please contact us, especially if you're traveling some distance to view. Please note that appliances and heating systems have not been tested and therefore no warranties can be given as to their good working order.