

TO LET

Wilton Road, Hounslow, TW4 7LP
£2,850 Per Calendar Month

DBK
ESTATE AGENTS

- Available To Rent Immediately!
- Mid-Terraced Extended House
- 4 Sizeable Bedrooms with Furniture
- Spacious Reception Room
- Modern Kitchen
- Two Chic Shower Rooms/ WC
- Ample Storage
- Off Street Parking for Two Cars
- St Marks School 1.1 Miles
- Hounslow West Station 0.6 Miles

THE PROPERTY

Available To Rent Immediately!

This extended mid-terraced home offers spacious and versatile accommodation, making it an ideal choice for families or professional sharers seeking a well connected location.

The property comprises four sizeable bedrooms, all furnished, providing comfortable and practical living arrangements. A generous reception room offers ample space for relaxing and entertaining, while the modern kitchen is well equipped and designed to meet the demands of everyday living.

Further benefits include two contemporary shower rooms with WCs, ensuring convenience for larger households, along with ample storage space throughout the property.

Externally, the home features off street parking for two vehicles, providing valuable convenience for residents and visitors alike.

Ideally situated within easy reach of local amenities, the property is located approximately 0.6 miles from Hounslow West Station and 1.1 miles from St Mark's School. Offering spacious accommodation, modern facilities, and an excellent location, this property is available for immediate occupation.

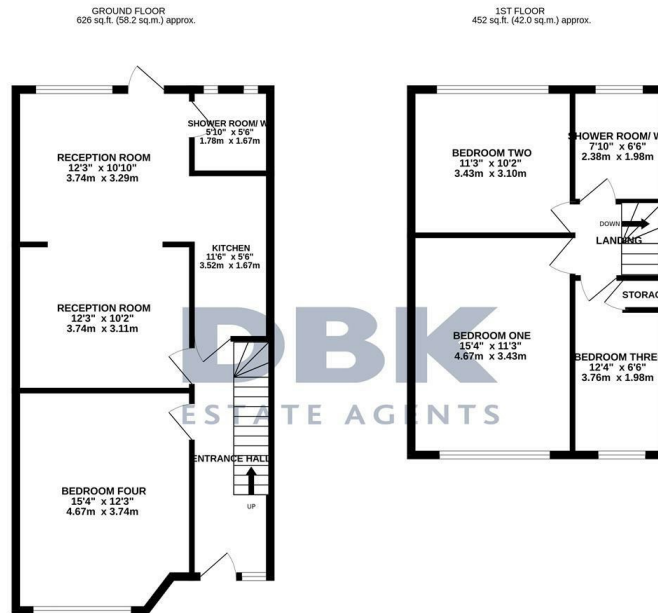

TOTAL FLOOR AREA: 1078 sq ft. (100.2 sq.m.) approx.
While every attempt has been made to ensure the accuracy of the description contained here, measurements of areas, window sizes and any other details are approximate and no responsibility is taken for any error or omission in the description. This plan is for illustrative purposes only and should be used as a guide by any prospective purchaser. The services, systems and appliances shown have not been tested and no guarantee is given as to their operability or efficiency can be given.
 Made with Metreplex ©2025