



MOOR MEAD ROAD
ST MARGARETS

JACKSON-STOPS 

MOOR MEAD ROAD ST MARGARETS, TW1

ASKING PRICE: £2,300 PCM

An exceptional 2-bedroom ground floor apartment with private garden. Located beside Moormead park, this apartment boasts a separate dining and reception room and over 760 square feet of living space.

Moor Mead Road is situated just moments from St Margaret's Train Station, benefitting from direct links to London Waterloo and a short walk from coffee shops and local amenities.



KEY FEATURES

- Private Garden
- Close to Shops
- Moormead Park location
- Close to Train Station
- Two Double Bedrooms
- Separate Reception Room





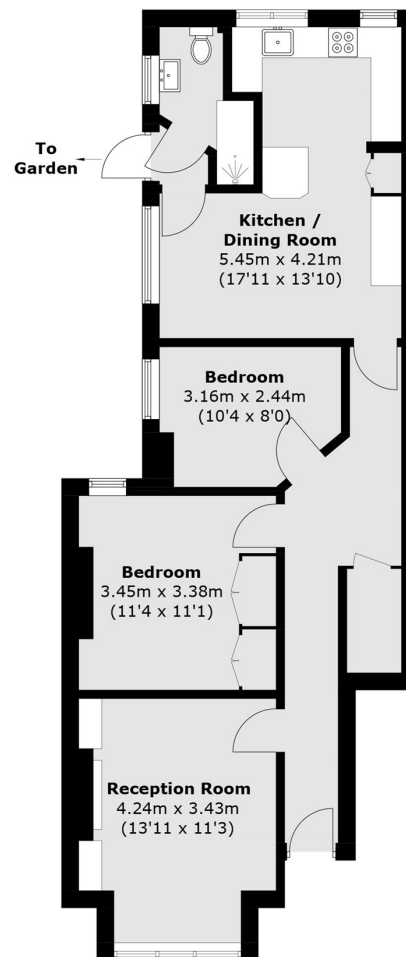

Total area (approx.): 70.0 sq. m (753.5 sq. ft)

Energy Rating: D. We aim to make our particulars both accurate and reliable. However they are not guaranteed; nor do they form part of an offer or contract. If you require clarification on any points then please contact us, especially if you are travelling some distance to view. Please note that appliances and heating systems have not been tested and therefore no warranties can be given as to their good working order.

ASKING PRICE: £2,300 PCM

TEDDINGTON

020 8943 9955

teddingtonlettings@jackson-stops.com

jackson-stops.co.uk

JACKSON-STOPS 