

Main Street Cherry Burton Beverley

£245,000

3 1 1



REFERENCE BA0665 Ben Appella: A modern end of terrace home situated to the west side of the village that offers no onward chain. The property offers three bedrooms to the first floor with a modern bathroom suite, whilst on the ground floor there is a well proportioned lounge and a generous sized kitchen/dining room that has been remodelled and upgraded. In addition there is a sizeable utility room with a hard wood door leading to the private and very spacious garden. A detached garage with the addition of parking sits to the rear of the house and is accessed from Canada Drive. Homes of this type in this location do not come to the market with any degree of frequency and I would encourage an early viewing.

- No Onward Chain
- Lounge
- Utility Room
- Modern Bathroom Suite
- Good sized Rear Garden
- Spacious End Terrace
- Remodelled Kitchen/Dining Room
- Three Well Proportioned Bedrooms
- Gas CH/ Double Glazing
- Garage And Parking

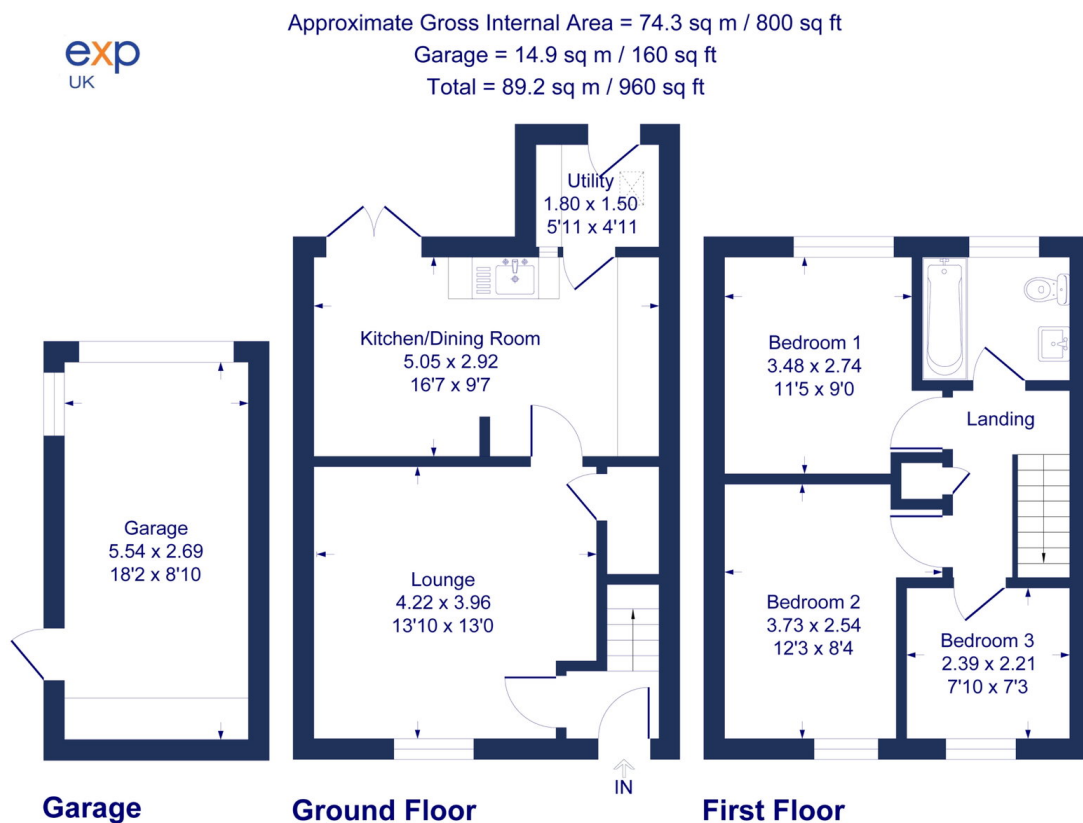

Illustration for identification purposes only, measurements are approximate, not to scale.