



Daniel Hill Mews, Sheffield, S6 3JJ

Offers In Region Of £120,000

🛏️ 2 🪑 1 🚗 1



A well-proportioned two bedroom second floor apartment with off-road parking, offered to the market with vacant possession and no onward chain.

Situated within the popular Daniel Hill Mews development, this attractive apartment offers bright and well-balanced accommodation, ideal for first-time buyers, downsizers or investors.

The property features a spacious lounge which provides a comfortable living space with plenty of room for both seating and dining furniture. The kitchen is neatly arranged and well positioned off the main living area, offering good storage and worktop space.

There are two bedrooms, both well sized, alongside a bathroom finished in a clean, neutral style. The layout is practical and easy to live with, and the apartment is ready for immediate occupation.

Externally, the property benefits from off-road parking, adding valuable convenience in this well-connected location.

Daniel Hill Mews is well placed for Walkley, Hillsborough and Sheffield city centre, with a range of local shops, cafés, green spaces and transport links close by.

Offered for sale with vacant possession and no onward chain, this is a great opportunity to secure a well-located apartment, and early viewing is recommended.



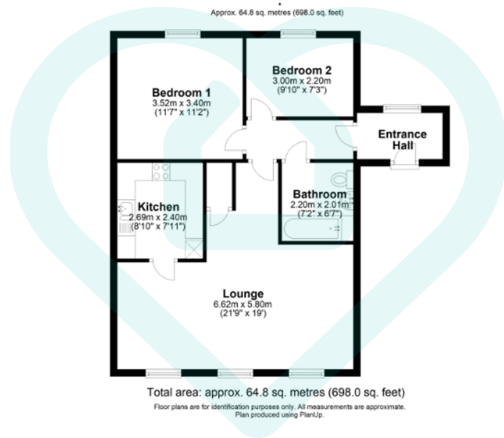

This floor plan is for illustrative purposes only. All measurements and layouts are approximations and do not necessarily capture the precise specifications of the property. No responsibility is taken for any error, omission, or misstatement. We always recommend viewing in person to confirm the exact floor plan of a property. Made with Metropix.



- Offered with no onward chain
- Off-road parking
- Second floor apartment
- Two bedrooms
- Spacious lounge
- Well-arranged kitchen
- Modern bathroom
- Popular residential development
- Convenient for local amenities
- Vacant possession

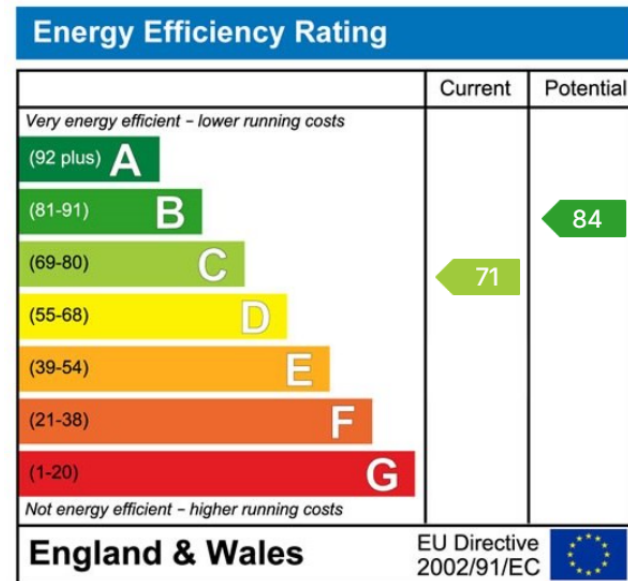

Sales | Lettings | New Homes

VAT Reg Number: 191 3588 84
Company Reg Number: 08610489
Company Reg Address: 67 Middlewood Road, Hillsborough, Sheffield, S6 4GX.

The MorfittSmith Building
67 Middlewood Road
Hillsborough
Sheffield
S6 4GX

Get in touch - arrange an appointment



0114 232 1764
sales@morfittsmith.co.uk
lettings@morfittsmith.co.uk
newhomes@morfittsmith.co.uk
www.morfittsmith.co.uk



@MorfittSmith
@MorfittSmith
MorfittSmith
Estate & Letting Agent