



## 37 Nettlefield

Kennington, TN24 9EG

Price £325,000

A recently renovated semi - detached bungalow in a popular residential location, occupying a generous plot. The newly plastered and decorated accommodation comprises an entrance hall, sitting room, kitchen, two bedrooms and shower room/WC. The property offers excellent potential for further extension or development subject to usual consents and benefits from gas central heating, double glazing, driveway and garage.

### Viewing

Please contact our Ashford Office on 01233 646411 if you wish to arrange a viewing appointment for this property or require further information.

- SEMI DETACHED BUNGALOW
- EXCELLENT POTENTIAL FOR DEVELOPMENT OR EXTENSION
- RECENTLY RENOVATED
- TWO BEDROOMS
- GARAGE & DRIVEWAY
- GENEROUS GARDEN
- GAS BOILER & HEATING INSTALLED 2023
- DOUBLE GLAZING



# Floor Plan

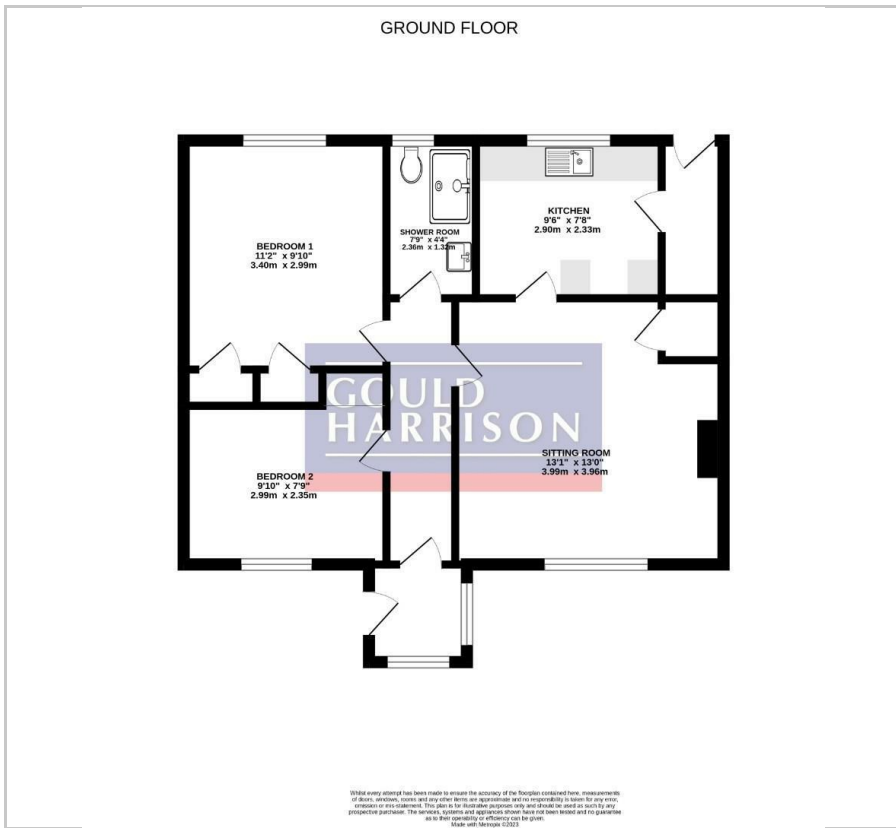

# Area Map



# Energy Efficiency Graph

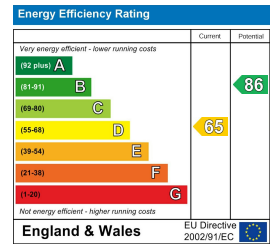

These particulars, whilst believed to be accurate are set out as a general outline only for guidance and do not constitute any part of an offer or contract. Intending purchasers should not rely on them as statements of representation of fact, but must satisfy themselves by inspection or otherwise as to their accuracy. No person in this firm's employment has the authority to make or give any representation or warranty in respect of the property.