

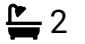

Botteville Road, Birmingham, B27 7YD

£150,000

 2  2  1



A Modern Ground Floor Apartment Offering Two Bedrooms, En-Suite & Excellent Transport Links

Key Features

- Modern ground-floor apartment in a sought-after location
- Main bedroom with private en-suite
- Presented in excellent condition throughout
- Close to Solihull, Birmingham City Centre, and major transport links
- Two bedrooms and two bathrooms
- Spacious open-plan kitchen and lounge area with bay window
- Within walking distance of Acocks Green Village and train station
- Perfect for first-time buyers, downsizers, or investors

GROUND FLOOR
569 sq.ft. (52.8 sq.m.) approx.

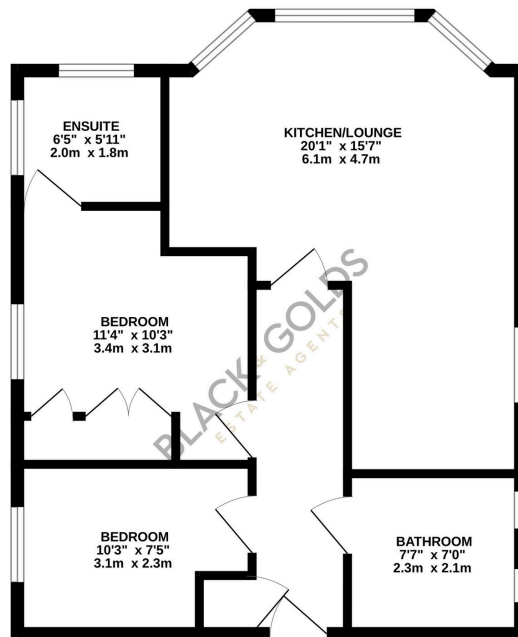

TOTAL FLOOR AREA: 569 sq.ft. (52.8 sq.m.) approx.

Whilst every attempt has been made to ensure the accuracy of the floorplan contained herein, measurements of doors, windows, rooms and any other items are approximate and no responsibility is taken for any error, omission or misstatement. This plan is for illustrative purposes only and should be used as such by any prospective purchaser. The services, systems and appliances shown have not been tested and no guarantee as to their operability or efficiency can be given.
Made with Metropix 02/25