

**2 Bed
Apartment
located in**

Jennings
estate agents

**Brunton House Scotforth
Road
Lancaster
LA1 4TU**



2



1



1



D

Communal Entrance

Secure entrance doorway and well presented foyer, with stairs leading to the apartments.

Entrance Hallway

Laminate flooring, intercom system and radiator.

Lounge

13'1" x 13'8"

Double glazed uPVC window to the front aspect. Double radiator. Laminate flooring.

Kitchen

5'10" x 10'7"

Fitted kitchen with a range of wall and base units, contrasting work surface, incorporating a stainless steel sink unit. Free standing cooker, with five ring hob and extractor fan. Space for a fridge freezer. Double glazed uPVC window to the rear aspect. Door leading to-

Balcony

8'10" x 7'4"

Sheltered balcony, with breath-taking views overlooking Lancaster and towards Morecambe Bay.

Master Bedroom

10'4" x 10'2"

Double glazed uPVC window to the front aspect. Radiator.

Bedroom Two

10'6" x 9'12"

Double glazed uPVC window to the front aspect. Radiator.

Bathroom

Three piece bathroom suite comprising: bath with overhead shower, wash hand basin and low level WC. Heated towel rail. Double glazed uPVC window to the side aspect. Space for a washing machine. Tiled flooring and down lights.

Asking price £165,000

Jennings Estate Agents are delighted to bring to the market, this period conversion apartment. Located within the popular residential area of Lancaster. The apartment offers specious accommodation throughout, and a balcony, with views overlooking Lancaster and towards Morecambe. The apartment is current rented for £1000 per calendar month, and generating a yield of 7.2%.

The property features; communal entrance with a secure intercom system. Entrance hallway, large main reception room and fitted kitchen. Sheltered balcony with a wonderful views. Two double bedrooms, and a modern fitted three piece bathroom suite.

Viewings are highly recommended, so please contact the office on 01524 926007, or email us on office@jeagent.com



Brunton House, Scotforth Road, Lancaster, LA1 4TU

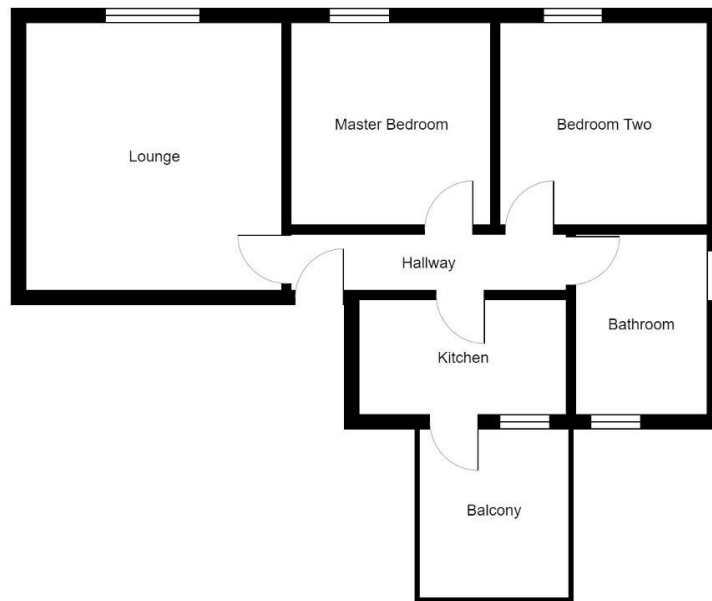

Second Floor

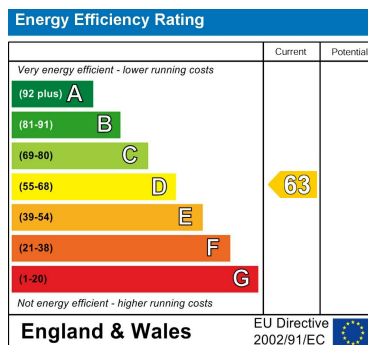

EPC Rating: D
Council Tax Band: B

DIRECTIONS

CONTACT

50 North Road
Lancaster
LA1 1LT

E: office@jeagent.com

T: 01524 926007

jeagent.com

Jennings
estate agents