



Mill Road

Gillingham | ME7 1JB

Mill Road , Gillingham, ME7 1JB

Guide Price - £200,000 to £220,000

Charming Grade II Listed One-Bedroom Cottage –
Close to Gillingham Town Centre

Nestled just moments from Gillingham town centre, this delightful Grade II listed cottage offers a perfect blend of historic charm and modern comfort. The property features a spacious double bedroom and a contemporary family bathroom on the first floor.

Enjoy the privacy of secluded front and rear gardens, ideal for relaxing or entertaining outdoors. With no onward chain, this home presents an excellent opportunity for first-time buyers or investors alike.

Early viewing is highly recommended to appreciate all this characterful cottage has to offer.

Guide Price £200,000



Living Room

16'8 x 11'1 (5.08m x 3.38m)

Kitchen

10'7 x 7'7 (3.23m x 2.31m)

Bedroom

16'8 x 11'1 (5.08m x 3.38m)

Bathroom

7'8 x 10'7 (2.34m x 3.23m)



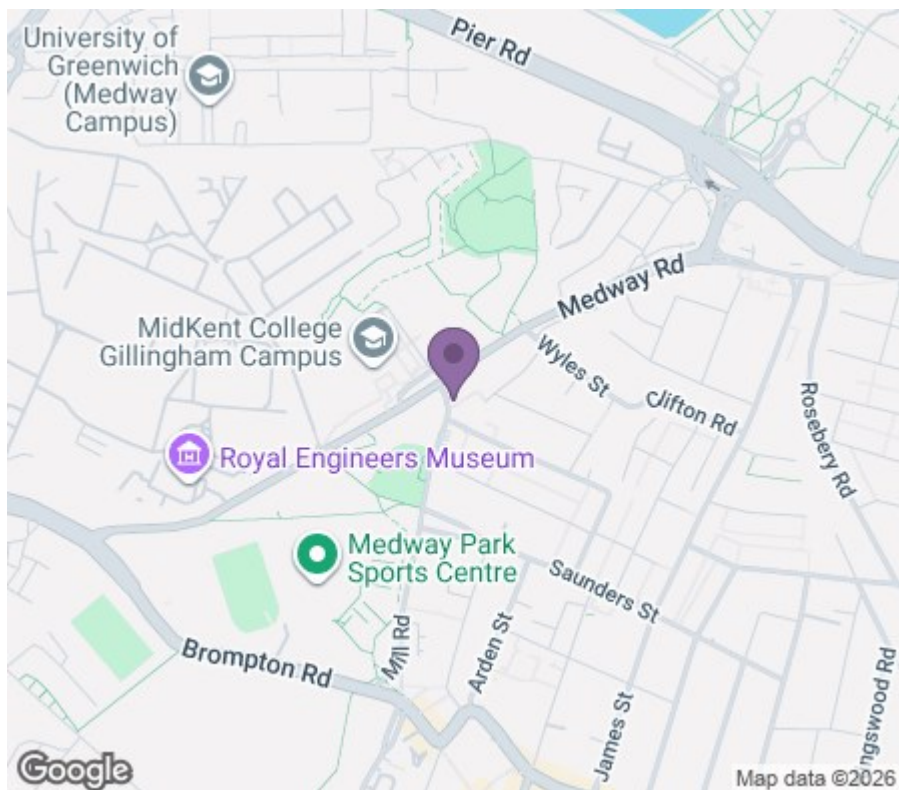

Ground Floor

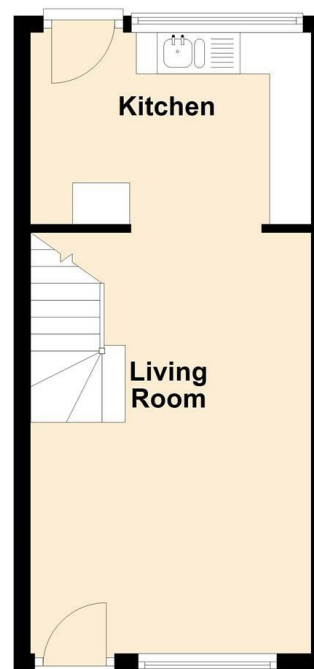

First Floor



18 - 20 High Street

Gillingham

Kent

ME7 1BB

01634 570057

www.crralestate.co.uk

twitter.com/CRRealEstateUK

facebook.com/CRRealEstateUK



CR Real Estate endeavour to maintain accurate depictions of properties in Virtual Tours, Floor Plans and descriptions, however, these are intended only as a guide and purchasers must satisfy themselves by personal inspection.