

**ROBERTSON PHILLIPS**  
Estate Agents, Valuers,  
Lettings and Property Management

262a Uxbridge Road, Hatch End,  
Pinner, Middlesex HA5 4HS  
Tel: 020 8428 7161

Email: [pinner@robertsonphillips.co.uk](mailto:pinner@robertsonphillips.co.uk)

Harrow: 020 8863 1122  
Lettings: 020 8421 4847



**ROBERTSON  
PHILLIPS**

Estate Agents



Southfield Park, Harrow

Guide Price £649,950



[www.robertsonphillips.co.uk](http://www.robertsonphillips.co.uk)



**A Three Bedroom Detached Property With Lots of Potential to Extended Further STPP.**

Located on one of North Harrows most desirable roads, popular for its diverse range of property types and styles and only five minutes' walk to North Harrow Tube Station (Metropolitan Line) shops and eateries. Highly regarded primary and secondary schools are also nearby, including Nower Hill and Vaughan primary school. This detached property is offered for sale with no chain and benefits from having double glazed windows, two reception rooms, three bedrooms, family bathroom, spacious kitchen and downstairs cloakroom. Additional benefits include off street parking to the front and a double garage to the rear accessed via a shared driveway. Please note this property recently received some water damage from a water tank failure in the loft space. Due to this the property will require a small level of refurbishment.



**Ground Floor**

**Hall** 5.05m (16'7") x 0.78m (2'7")

Two windows to front, Storage cupboard, stairs, and door to:

**WC** 1.11m (3'8") x 0.69m (2'3")

Low level wc and small wash hand basin.

**Kitchen** 16' 9" x 8' 2" (5.10m x 2.49m)

Spacious kitchen with window to rear and side, door to garden.

**Living Room** 13' 2" x 12' 8" (4.01m x 3.86m)

Bow window to front, door to:

**Dining Room** 13' 2" x 10' 4" (4.01m x 3.15m)

Open plan, patio door to the garden.



### First Floor

**Bedroom 1** 13' 2" x 12' 0" (4.01m x 3.65m)  
Bow window to front, fitted wardrobes.

**Bedroom 2** 13' 2" x 11' 9" (4.01m x 3.58m)  
Window to rear, fitted wardrobes.

**Bedroom 3** 10' 0" x 7' 3" (3.05m x 2.21m)  
Window to rear, Storage cupboard housing the immersion heater.

**Bathroom** 8' 9" x 6' 10" (2.66m x 2.08m)  
Fitted with four piece suite comprising, deep panelled bath, pedestal wash hand basin and shower enclosure, window to front.

**Garden** 120' 0" x 0' 0" (36.55m x 0.00m)

Beautiful garden with a patio area, a mixture of mature shrubs and trees and a hidden double garage to the rear which is accessed via a shared drive.

### Front Drive

Dropped kerb with parking for two/three vehicles.

**Council Tax Band:** F

**EPC Rating:** D

**Tenure:** Freehold



## KEY FEATURES:

- Detached
- No Chain
- Three Bedrooms
- Family Bathroom
- Kitchen/Breakfast Room
- Through Lounge
- WC
- 120FT Plus Garden

### Ground Floor

Approx. 52.6 sq. metres (566.7 sq. feet)

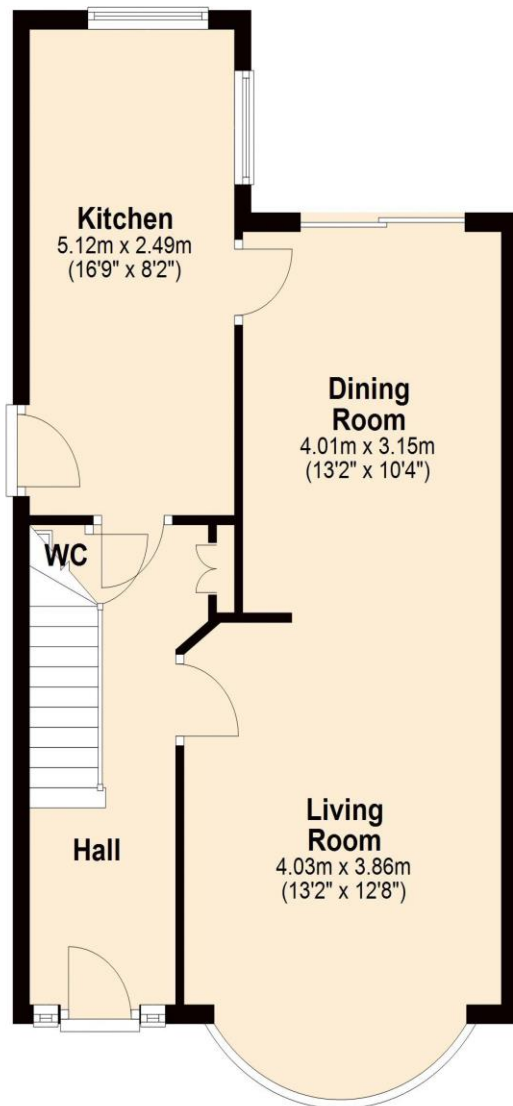

### First Floor

Approx. 48.4 sq. metres (520.8 sq. feet)

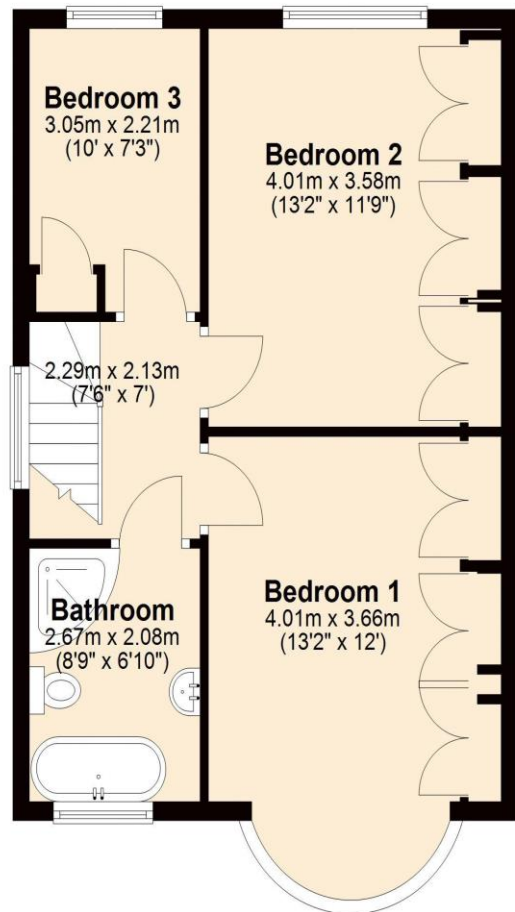

DISCLAIMER: Robertson Phillips may not have sought to verify the legal title of the property, the existence of planning permissions and/or building regulation approvals and have been unable to check the working condition of any services or appliances.

Property layouts are for general guidance and are not drawn exactly to scale. Measurements are taken at the widest points and bays, alcoves, wardrobes etc. may not be shown.