

GROUND FLOOR  
448 sq.ft. (41.6 sq.m.) approx.

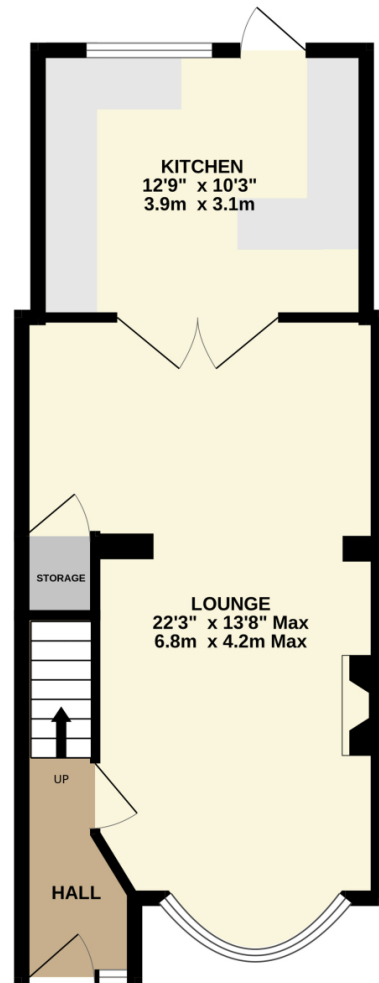

1ST FLOOR  
280 sq.ft. (26.0 sq.m.) approx.

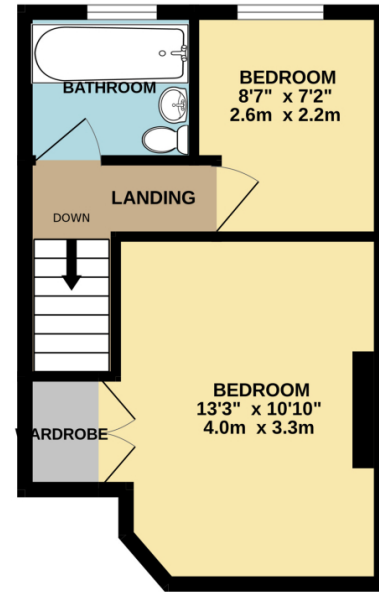

TOTAL FLOOR AREA: 727 sq.ft. (67.6 sq.m.) approx.

Whilst every attempt has been made to ensure the accuracy of the floorplan contained here, measurements of doors, windows, rooms and any other items are approximate and no responsibility is taken for any error, omission or mis-statement. This plan is for illustrative purposes only and should be used as such by any prospective purchaser. The services, systems and appliances shown have not been tested and no guarantee as to their operability or efficiency can be given.  
Made with Metropix ©2025

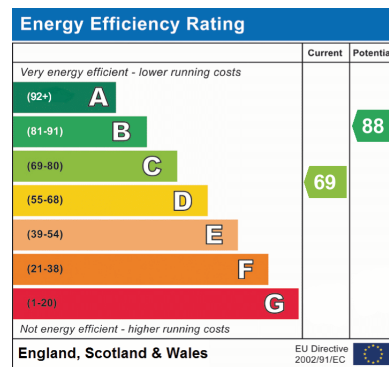

Address: Sidcup, DA15

## Portland Avenue, Sidcup, DA15

AJR Property are delighted to offer to the market CHAIN FREE this two bedroom terraced house in Portland Avenue, Sidcup. The property is situated in a sought after residential road that is perfectly located for local shops, parks, bus routes and schools.

**Guide price £400,000**



AJR Property  
2 Bellegrove Road, Welling DA16 3PR  
T: +442083040666 | E: hello@ajrproperty.com  
<http://www.ajrproperty.com/>

AJR Property  
2 Bellegrove Road, Welling DA16 3PR  
T: +442083040666 | E: hello@ajrproperty.com  
<http://www.ajrproperty.com/>



## Features

- CHAIN FREE
- Sought after road
- Large through longe with dining area
- Private tear garden
- Two bedroom house
- Close to amenities
- Fitted kitchen
- Off street parking