



Price
£475,000

Freehold

3x  1x  1x 

**Radnor Court, Linkfield
Street, Redhill, Surrey,
RH1**

cubitt&west
Helping you move forwards

Ground Floor

Approx. 43.2 sq. metres (465.2 sq. feet)

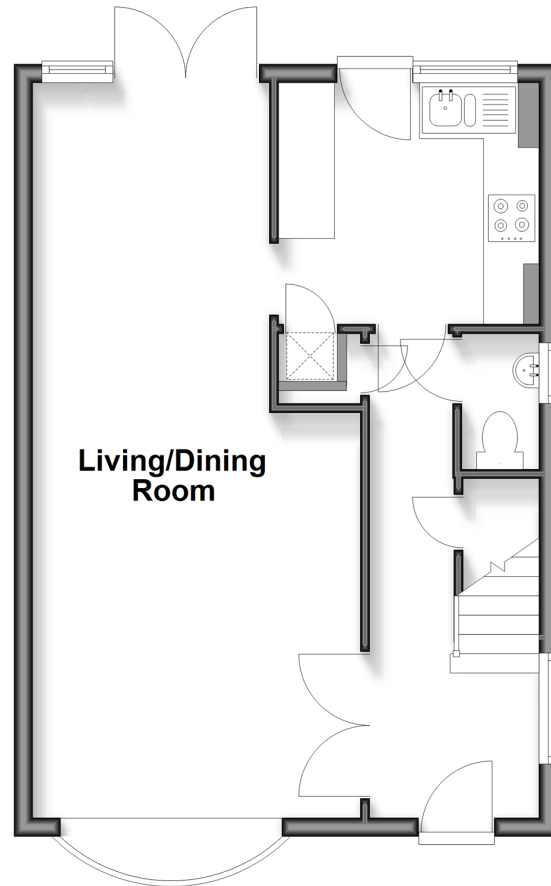

First Floor

Approx. 42.8 sq. metres (461.2 sq. feet)

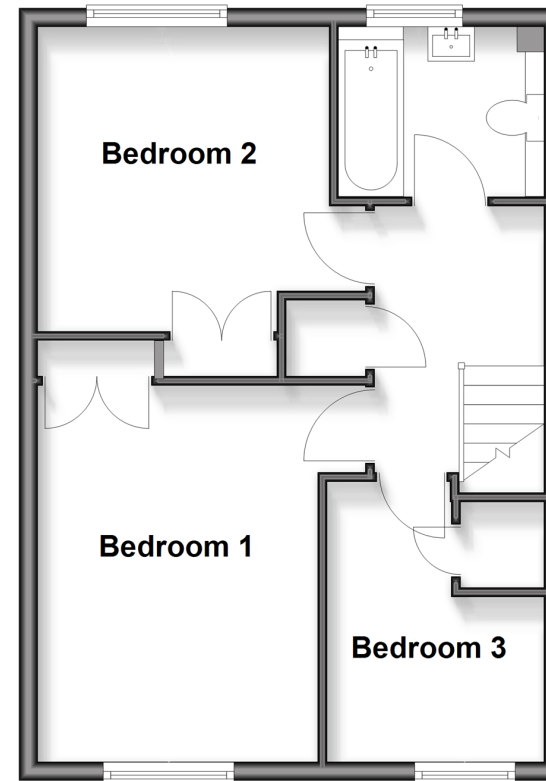

Accommodation

GROUND FLOOR

Entrance Hall

Living/Dining Room: 26'1 x 11'10 (7.96m x 3.61m)

Kitchen: 9'3 x 8'8 (2.82m x 2.64m)

Cloakroom

FIRST FLOOR

Landing

Bedroom 1: 13'4 x 11'7 (4.07m x 3.53m)

Bedroom 2: 10'9 x 10'6 (3.28m x 3.20m)

Bedroom 3: 9'10 x 6'3 (3.00m x 1.91m)

Bathroom

OUTSIDE

Garage



Main features

- Situated in a quiet cul-de-sac in prime location
- Garage en-bloc with power
- Stunning communal grounds with south facing rear garden
- Short walk to Redhill Town Centre and Train Station
- Ample visitors parking



Nearest Schools

Primary Schools: St Joseph's Catholic Primary, Redhill 0.2 miles, St John's Primary 0.5 miles, Wray Common Primary 0.5 miles
Secondary Schools: Dunottar Day for Girls 0.5 miles, The Warwick 0.7 miles, Reigate Grammar 0.7 miles



Transport Information

Train Stations: Redhill 0.7 miles, Earlswood 0.8 miles, Reigate 1.2 miles



Address

Radnor Court, Linkfield Street, Redhill, Surrey, RH1



Directions

For directions to this property please contact us.



cubitt&west
Helping you move forwards

Call Redhill Branch 01737 778866 ■ cubittandwest.co.uk



■ Legal advice should be taken to verify fixtures/fittings, planning, alterations and/or lease details ■ Appliances & services are untested, dimensions are approximate and floor plans are not to scale



23411501/20251121/AB/JB2