



37 Arlington

Ashford, TN23 4HN

Price £280,000

A spacious terraced home ideally located for access to nearby schools, shops and bus services.

The property comprises an entrance hall, sitting room, kitchen/breakfast room, utility lobby, three bedrooms and bathroom/WC.

To the rear you will find an enclosed rear garden with the property also benefitting from gas gas central heating and double glazing.

Offered for sale with NO ONWARD CHAIN

- SPACIOUS TERRACED HOUSE
- THREE BEDROOMS
- KITCHEN/BREAKFAST ROOM
- ENCLOSED REAR GARDEN
- GAS CENTRAL HEATING
- DOUBLE GLAZING
- SHORT WALK TO LOCAL SCHOOLS & AMENITIES
- EPC RATING - C (77)

Viewing

Please contact our Ashford Office on 01233 646411 if you wish to arrange a viewing appointment for this property or require further information.



Floor Plan

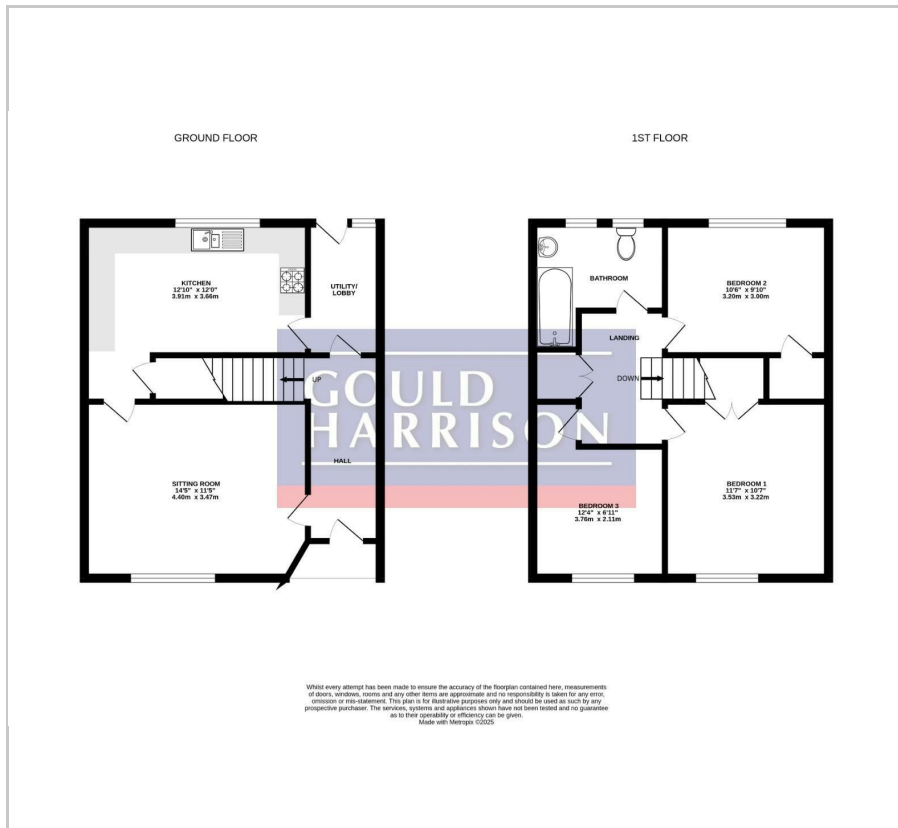

Area Map



Energy Efficiency Graph

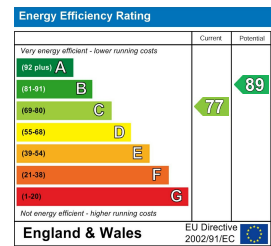

These particulars, whilst believed to be accurate are set out as a general outline only for guidance and do not constitute any part of an offer or contract. Intending purchasers should not rely on them as statements of representation of fact, but must satisfy themselves by inspection or otherwise as to their accuracy. No person in this firm's employment has the authority to make or give any representation or warranty in respect of the property.