



Osnaburgh Street, NW1

£650,000

 1  1  1  B

- No Onward Chain
- Office Room
- Communal Gardens
- One Double Bedroom
- Family Bathroom
- Modern Finish

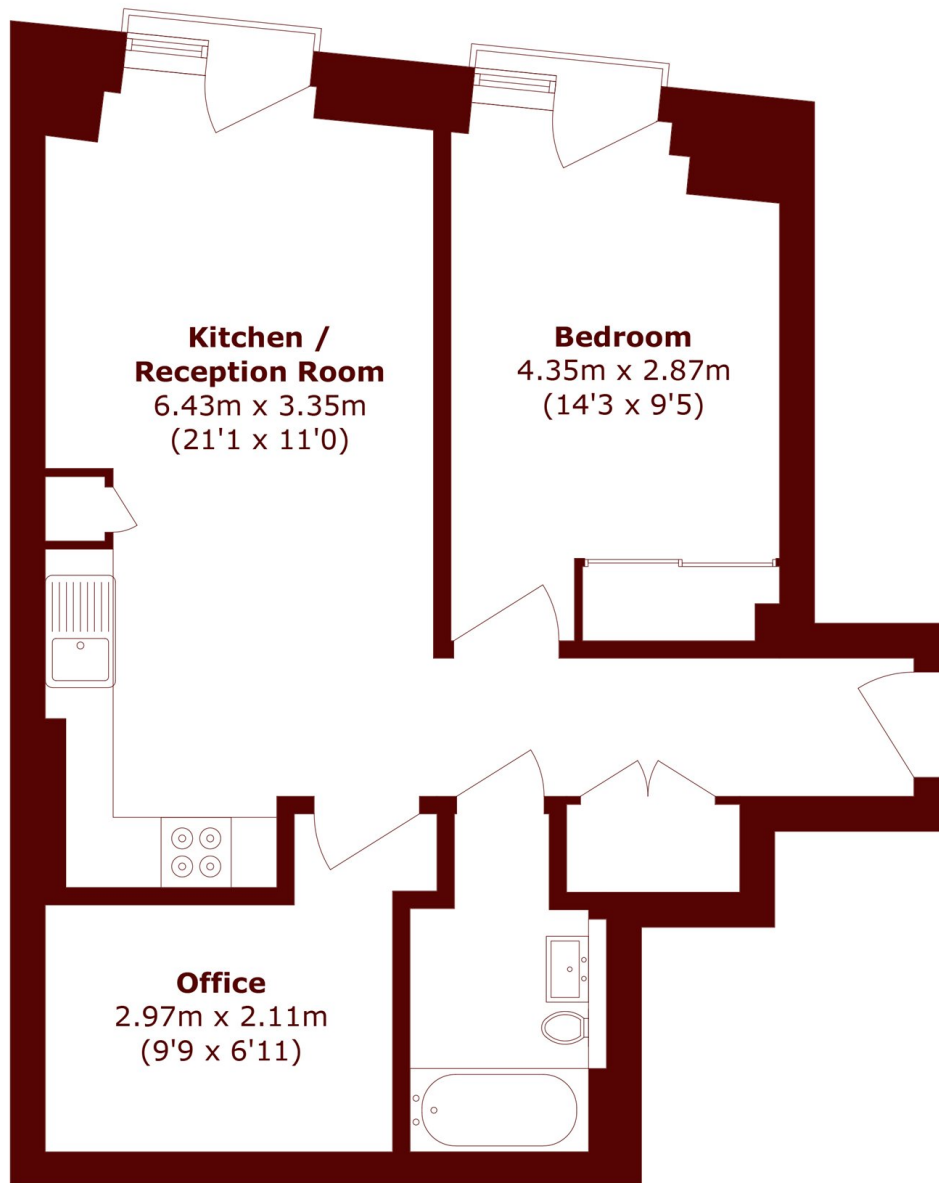

Total area (approx.): 54.5 sq. m (586.6 sq. ft)

Marsh & Parsons Camden

27 Parkway, London, NW1
7PN
020 7244 2200