



Bendy Bow, Oaksey, Wiltshire.

£360,000 Freehold

1 Bendy Bow, Oaksey, Malmesbury, Wiltshire.

Directions

Please use the postcode SN16 9TN or call the office at any time for detailed directions from your location.

Summary

A beautifully presented, modern home in the ever-popular village of Oaksey, offering stylish, well-balanced living with a real sense of calm throughout. From the light-filled kitchen/dining space opening onto the garden, to the thoughtfully designed interiors, this is a home that feels both practical and effortlessly put together, ideal for day-to-day living as well as entertaining.

Step inside

A welcoming entrance hall sets the tone as soon as you walk in, complete with a useful downstairs cloakroom, exactly what you want for everyday practicality.

The ground floor then flows beautifully. A generous sitting room to the front offers a cosy but well-proportioned space, softened by natural tones and a calm, contemporary feel.

To the rear, the kitchen/dining room is the real heart of the home. It's bright, sociable and opens directly onto the garden, making it perfect for everyday life and hosting in equal measure. The kitchen itself is modern and well laid out, with everything neatly in its place. Upstairs, the balance continues with well-sized bedrooms, all finished in the same clean, considered style. The principal bedroom feels particularly calm and inviting, while the additional rooms offer flexibility for family, guests or working from home. A modern family bathroom and separate shower room add a practical edge that buyers will really appreciate.

Step outside

The garden has been designed with ease and enjoyment in mind. A combination of patio and gravel creates defined seating areas, perfect for relaxing or entertaining without the upkeep of a high-maintenance lawn.

To the front, the property sits neatly within a smart, modern development, with parking available and a pleasant, open feel around it. It's a setting that feels both established and easy to live in.

Area insight

Oaksey remains one of the area's most sought-after villages, offering a strong sense of community alongside everyday convenience. With its well-regarded primary school, popular pub, and easy access to both Cirencester and Malmesbury, it strikes a perfect balance between countryside living and connectivity.

For those drawn to the Cotswold Lakes, they are just moments away, adding another layer of lifestyle appeal to an already well-positioned home.

Viewing

Viewing is available by appointment 7 days a week. Please call your local office to arrange.

Additional services

As a local family business, we have built relationships with many other local companies and are therefore happy to provide referrals for conveyancing, financial advisor, contractors, and anything else you may require.

Agents Note

We wish to inform prospective purchasers that we have prepared these sales particulars as a general guide. We have not carried out a survey, nor have we tested any services, appliances or any specific fittings at the property. Room sizes should not be relied upon for carpets and furnishings.



GROUND FLOOR

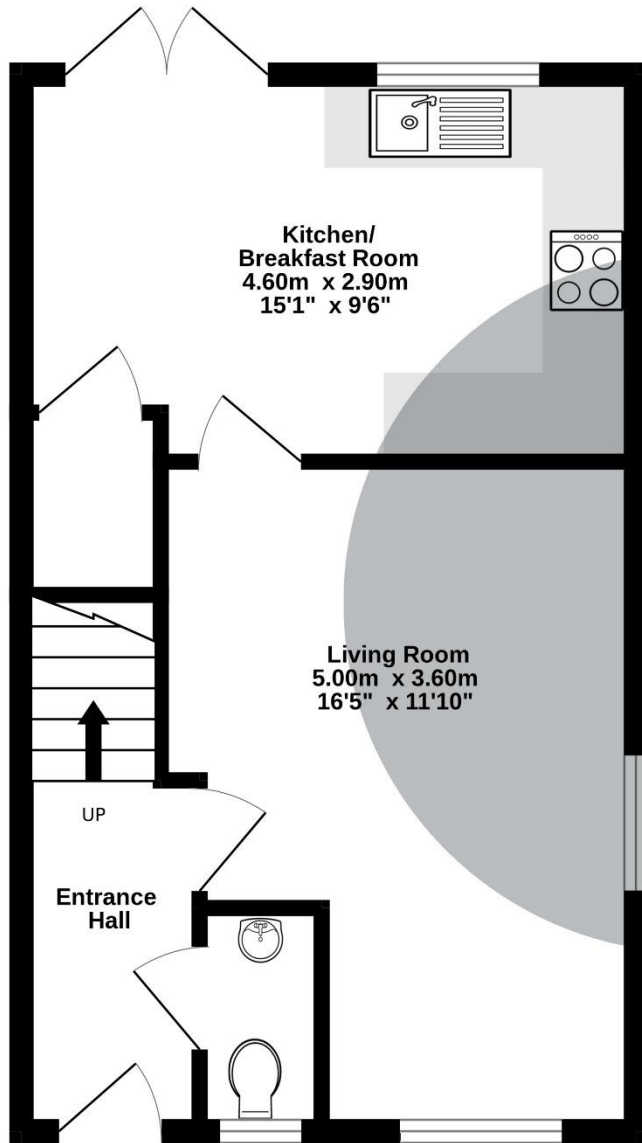

1ST FLOOR

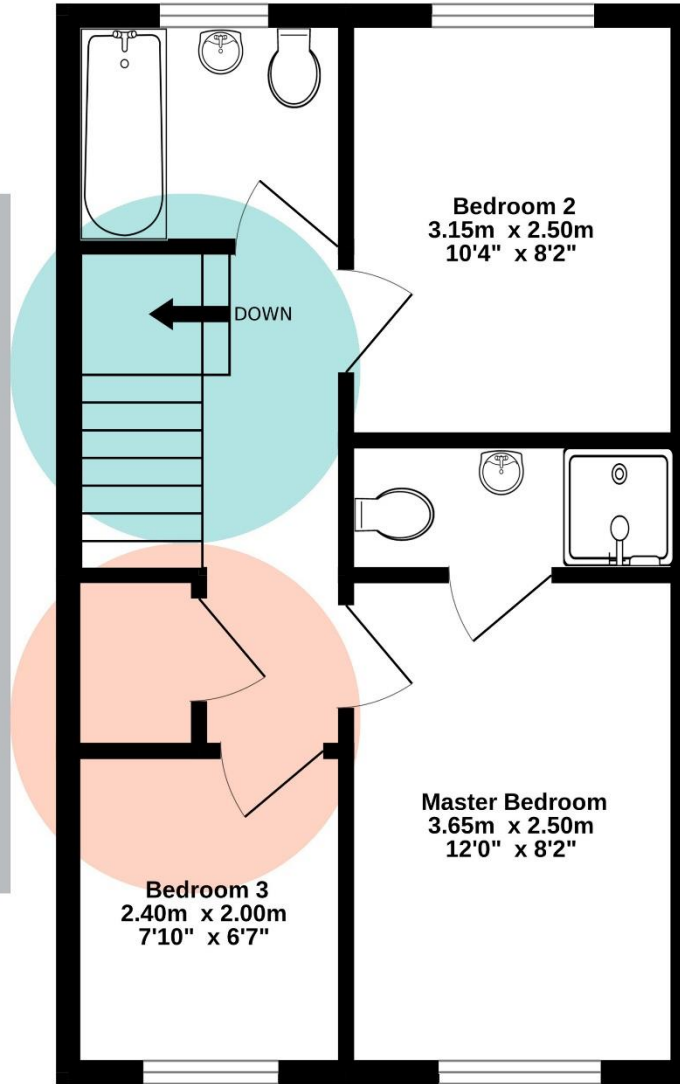

Whilst every attempt has been made to ensure the accuracy of the floorplan contained here, measurements of doors, windows, rooms and any other items are approximate and no responsibility is taken for any error, omission or mis-statement. This plan is for illustrative purposes only and should be used as such by any prospective purchaser. The services, systems and appliances shown have not been tested and no guarantee as to their operability or efficiency can be given.
Made with Metropix ©2026



