

HS HAIR & SON



Crisp Street
London E14 6ET

Auction Guide £220,000 Leasehold



Local Authority **Tower Hamlets**
Council Tax Band **C**
EPC Rating

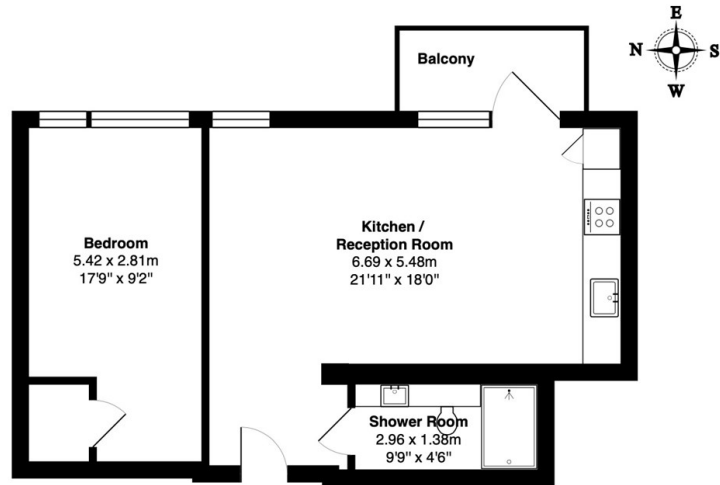

15th Floor

Total Area: 50.6 m² ... 544 ft²

All measurements are approximate and for display purposes only

Sales Office

190 London Road, Southend-On-Sea,
Essex, SS1 1PJ

Contact

01702 34 11 77

<https://hairandson.co.uk/>

Agents Note: Whilst every care has been taken to prepare these particulars, they are for guidance purposes only. All measurements are approximate and for general guidance purposes only and whilst every care has been taken to ensure accuracy, they should not be relied upon and potential buyers/tenants are advised to recheck the measurements.

